

**Contract No. HY/2013/01**

**Hong Kong-Zhuhai-Macao Bridge  
Hong Kong Boundary Crossing Facilities – Passenger Clearance  
Building**

**Monthly EM&A Report No. 14  
(Covering the Period from 1 November 2015 to 30 November 2015)**

9 December 2015

Revision 1

Main Contractor



Leighton - Chun Wo  
Joint Venture

Environmental Team

**ATKINS**

## Contents

### Executive Summary

<b>1</b>	<b>Introduction .....</b>	<b>1</b>
1.1	Basic Project Information .....	1
1.2	Project Organisation .....	2
1.3	Construction Programme .....	2
1.4	Construction Works Undertaken During the Reporting Period .....	2
<b>2</b>	<b>Air Quality Monitoring.....</b>	<b>4</b>
2.1	Monitoring Locations .....	4
2.2	Monitoring Requirements .....	4
2.3	Monitoring Results.....	5
<b>3</b>	<b>Noise Monitoring.....</b>	<b>6</b>
3.1	Monitoring Locations .....	6
3.2	Monitoring Requirements .....	6
3.3	Monitoring Results.....	6
<b>4</b>	<b>Environmental Site Inspection and Audit .....</b>	<b>7</b>
4.1	Site Inspection.....	7
4.2	Advice on the Solid and Liquid Waste Management Status .....	7
4.3	Environmental Licenses and Permits .....	8
4.4	Implementation Status of Environmental Mitigation Measures.....	8
4.5	Summary of Exceedance of the Environmental Quality Performance Limit .....	8
4.6	Summary of Complaints, Notification of Summons and Successful Prosecution .....	8
<b>5</b>	<b>Future Key Issues .....</b>	<b>9</b>
5.1	Construction Programme for the Coming Months .....	9
5.2	Environmental Site Inspection Schedule for the Coming Month.....	9
<b>6</b>	<b>Conclusions.....</b>	<b>10</b>
6.1	Conclusions.....	10



## **Figures**

- Figure 2.1      Location of Air Quality Monitoring Stations  
Figure 3.1      Location of Noise Monitoring Stations

## **Appendices**

- Appendix A      Location of Works Areas  
Appendix B      Project Organization for Environmental Works  
Appendix C      Construction Programme  
Appendix D      Event and Action Plan  
Appendix E      Waste Flow Table  
Appendix F      Environmental Licenses and Permits  
Appendix G      Implementation Schedule for Environmental Mitigation Measures (EMIS)  
Appendix H      Statistics on Environmental Complaints, Notification of Summons and Successful Prosecutions  
Appendix I      Environmental Site Inspection Schedule

## Executive Summary

This Monthly Environmental Monitoring and Audit (EM&A) Report is prepared for Contract HY/2013/01 Hong Kong-Zhuhai-Macao Bridge Hong Kong Boundary Crossing Facilities (HKBCF) – Passenger Clearance Building (hereafter referred to as “the Contract”) for the Highways Department of Hong Kong Special Administrative Region (HKSAR). The Contract was awarded to Leighton – Chun Wo Joint Venture (hereafter referred to as “the Contractor”) and Atkins China Limited was appointed as the Environmental Team (ET) by the Contractor.

The Contract is part of Hong Kong – Zhuhai – Macao Bridge HKBCF which is a “Designated Project”, under Schedule 2 of the Environmental Impact Assessment Ordinance (EIAO) (Cap 499) and Environmental Impact Assessment (EIA) Report (Register No. AEIAR-145/2009) was prepared for the Project. The current Environmental Permit (EP) No. EP-353/2009/I for HKBCF was issued on 17 July 2015. These documents are available through the EIA Ordinance Register. Site preparation works of the Contract started on 26 September 2014 and the construction works of the Contract commenced on 6 October 2014.

Atkins China Limited has been appointed by the Contractor to implement the Environmental Monitoring & Audit (EM&A) programme for the Contract in accordance with the Updated EM&A Manual for HKBCF (Version 1.0) and will be providing environmental team services to the Contract.

This is the fourteenth Monthly EM&A Report for the Contract which summarizes findings of the EM&A works during the reporting period from 1 November 2015 to 30 November 2015.

## Environmental Monitoring and Audit Progress

The monthly EM&A programme was undertaken in accordance with the Updated EM&A Manual for HKBCF (Version 1.0). It should be noted that the air quality and noise monitoring works for the Contract are covered by Contract No. HY/2010/02 Hong Kong-Zhuhai-Macao Bridge HKBCF – Reclamation Works and Contract No. HY/2011/03 Hong Kong-Zhuhai-Macao Bridge Hong Kong Link Road – Section between Scenic Hill and HKBCF. The ET of the Contract or another ET of the HZMB project is required to conduct impact air quality monitoring at AMS6 and AMS7A and noise monitoring at NMS2 and NMS3B as part of EM&A programme if these monitoring stations are no longer covered under Contract Nos. HY/2010/02 and HY/2011/03. However, this is subject to ENPO’s final decision on which ET should carry out the monitoring work at these stations.

The dates of site inspection during the reporting period are listed below:

Environmental Site Inspection: 4, 11, 18, and 25 November 2015

## Breaches of Action and Limit Levels

Summary of Action and Limit Level exceedance of 1-hr TSP level and 24-hr TSP level at AMS6 shall be referred to the monthly EM&A report prepared by Contract No. HY/2011/03.

There was no Action and Limit Level exceedance of 1-hr TSP level and 24-hr TSP level recorded at AMS7A by the Environmental Team of Contract No. HY/2010/02 during the reporting period.

There was no Action and Limit Level exceedance for noise recorded at NMS2 and NMS3B by the Environmental Team of Contract No. HY/2010/02 during the reporting period.

## Complaint Log

There were no complaints received in relation to the environmental impact during the reporting period.

## Notifications of Summons and Successful Prosecutions

There were no notifications of summons or prosecutions received during this reporting period.

## Reporting Change

There was no reporting change during the reporting period.



## Future Key Issues

The future key issues to be undertaken in the upcoming month include:

- Bulk Excavation at WA1;
- Pile Cropping at WA1;
- Tie Beams at WA1;
- Pile Capping at WA1;
- Base Slab Construction at WA1;
- Waterproofing at WA1;
- Tower Crane Erection at WA1;
- Southern Drop off Area Pile Capping & Column at WA1;
- Southern Drop off Area Deck Construction (WA1);
- Column and Wall Construction at WA1;
- Suspended Slab Construction at WA1;
- Seawater Pump House Socket H-pile works at WA1;
- Marine Mud Treatment at WA1;
- Backfilling at WA1;
- Mega Column Construction (WA1);
- Bulk Excavation at Box Culvert (WA1);
- RC works at Box Culvert (WA1);
- Bored Piling Works at Box Culvert (WA1); and
- Cut Platform at Box Culvert (WA1).



## 1 Introduction

### 1.1 Basic Project Information

- 1.1.1 This monthly Environmental Monitoring and Audit (EM&A) Report is prepared for Contract HY/2013/01 Hong Kong-Zhuhai-Macao Bridge Hong Kong Boundary Crossing Facilities – Passenger Clearance Building (hereafter referred to as “the Contract”) for the Highways Department of Hong Kong Special Administrative Region. The Contract was awarded to Leighton – Chun Wo Joint Venture (hereafter referred to as “the Contractor”) and Atkins China Limited was appointed as the Environmental Team (ET) by the Contractor.
- 1.1.2 The Contract is part of Hong Kong – Zhuhai – Macao Bridge Hong Kong Boundary Crossing Facilities (HKBCF) which is a “Designated Project”, under Schedule 2 of the Environmental Impact Assessment Ordinance (EIAO) (Cap 499). An Environmental Impact Assessment (EIA) Report (Register No. AEIAR-145/2009) was prepared for the Project. The current Environmental Permit (EP) No. EP-353/2009/I for HKBCF was issued on 17 July 2015. These documents are available through the EIA Ordinance Register. Site preparation work of the Contract started on 26 September 2014 and the construction works of the Contract commenced on 6 October 2014. The works areas of the Contract are shown in **Appendix A**.
- 1.1.3 The proposed works under this Contract comprise the following:
- Construction of Passenger Clearance Building (PCB) including architectural and builders works, structural steel roof and reinforced concrete frames, basement, piled foundations, aluminium roof, curtain wall facades, building services and electrical and mechanical works;
  - Installation of district cooling system including seawater cooling intake pumping station, seawater intake and discharge water pipelines work; Installation of Chilled water cooling pipelines system, heat exchanger and chilled pumping system;
  - Construction of transport and associated facilities connecting to the PCB entailing the Emergency Vehicular Access, an at-grade mainland side drop-off area, an Hong Kong side elevated drop-off deck and 8 numbers of footbridge links;
  - Construction of a public toilet, 6 numbers of C&ED observation booths, a generator set building and a refuse storage & material recovery chamber;
  - Construction of a section of 70m common utilities enclosure and staff subway and civil provisions for associated electrical and mechanical works;
  - Construction of drainage, sewerage, fresh water & flushing water supply and utilities & service works;
  - Construction of civil provisions, including draw pits & ducting for Traffic Control and Surveillance System (TCSS) and Extra Low Voltage System (ELV);
  - Construction of box culvert A;
  - Construction of 2 numbers of vehicular bridge abutments at mainland side pickup area earthmound;
  - Construction of geotechnical works including top up the existing earth mound from +11.5mPD to the finished level as stated in the Contract, reinforced earth slope and fill slopes and special backdrop manhole at mainland side pick up area earthmound;
  - Landscape hardworks and softworks; and
  - Other works which are shown on the Drawings or specified in the Specification or which may be ordered in accordance with the Contract.
- 1.1.4 This is the fourteenth Monthly EM&A Report for the Contract which summarizes the audit findings of the EM&A programme during the reporting period from 1 November 2015 to 30 November 2015.

## 1.2 Project Organisation

1.2.1 The project organization structure and lines of communication with respect to the on-site environmental management structure is shown in **Appendix B**. The key personnel contact names and numbers are summarized in **Table 1.1**.

**Table 1.1 Contact Information of Key Personnel**

Party	Position	Name	Telephone	Fax
Engineer or Engineer's Representative (AECOM Asia Co. Ltd.)	Chief Resident Engineer	Darrel Kingan	3958 7339	3468 2076
Environmental Project Office / Independent Environmental Checker (Ramboll Environ Hong Kong Limited)	Environmental Project Office Leader	Y. H. Hui	3465 2888	3465 2899
	Independent Environmental Checker	Raymond Dai	3465 2888	3465 2899
Contractor (Leighton – Chun Wo Joint Venture)	Project Manager	Gary Wong	3973 0488	3621 0180
	Environmental Officer	Donald Ip	6461 8635	3621 0180
Environmental Team (Atkins China Limited)	Environmental Team Leader	Sharifah Or	2972 1802	2890 6343
24 hours complaint hotline	---	---	3958 7300	---

## 1.3 Construction Programme

1.3.1 A copy of the Contractor's construction programme is provided in **Appendix C**.

## 1.4 Construction Works Undertaken During the Reporting Period

1.4.1 A summary of the construction activities undertaken during this reporting period is shown below:

- Piling Test at WA1;
- Bulk Excavation at WA1;
- Pile Cropping at WA1;
- Tie Beams at WA1;
- Pile Capping at WA1;
- Base Slab Construction at WA1;
- Waterproofing at WA1;
- Tower Crane Erection at WA1;
- Southern Drop off Area Pile Capping & Column at WA1;
- Column and Wall Construction at WA1;
- Suspended Slab Construction at WA1;
- Seawater Pump House socket H-pile works at WA1;



- Backfilling at WA1;
- Bulk Excavation at Box Culvert at WA1; and
- RC works at Box Culvert at WA1.

## 2 Air Quality Monitoring

### 2.1 Monitoring Locations

- 2.1.1 The air quality monitoring works for the Contract are covered by Contract No. HY/2010/02 Hong Kong-Zhuhai-Macao Bridge HKBCF – Reclamation Works and Contract No. HY/2011/03 Hong Kong-Zhuhai-Macao Bridge Hong Kong Link Road – Section between Scenic Hill and HKBCF.
- 2.1.2 The permission to carry out impact air quality monitoring work at AMS7 (Hong Kong SkyCity Marriott Hotel) was not granted after 31 January 2015. The air quality monitoring location (AMS7) was relocated to a nearby air sensitive receiver, Chu Kong Air-Sea Union Transportation Co. Ltd., from 5 February 2015. The alternative location was approved by EPD on 5 February 2015. The baseline and action/limit level for air quality as derived from the baseline monitoring data recorded at Hong Kong SkyCity Marriott Hotel was adopted for the alternative air quality location.
- 2.1.3 The ET of the Contract or another ET of the HZMB project is required to conduct air quality monitoring at AMS6 and AMS7A as part of EM&A programme if these air quality monitoring stations are no longer covered under Contract Nos. HY/2010/02 and HY/2011/03. **Figure 2.1** shows the locations of the air monitoring stations.

**Table 2.1 Construction Dust Monitoring Locations**

ID	Location Description
AMS 6 <sup>(1)</sup>	Dragonair/CNAC (Group) Building
AMS 7A <sup>(1)</sup>	Chu Kong Air-Sea Union Transportation Co. Ltd. <sup>(2)</sup>

Remark:

- (1) The ET of this Contract should conduct impact air quality monitoring at the AMS listed in the table as part of EM&A programme according to the latest notification from ENPO when the monitoring station(s) is/are no longer covered by another ET of the HZMB project.
- (2) The original monitoring location was at Hong Kong SkyCity Marriott Hotel. As the permission to carry out air quality monitoring at Hong Kong SkyCity Marriott Hotel was not granted after 31 January 2015, the monitoring location has been relocated to Chu Kong Air-Sea Union Transportation Co. Ltd. since 5 February 2015. The alternative monitoring location was approved by EPD on 5 February 2015.

### 2.2 Monitoring Requirements

- 2.2.1 The monitoring requirements, monitoring equipment, monitoring parameters, frequency and duration, monitoring methodology, monitoring schedule, meteorological information are detailed in the monthly EM&A Reports prepared for Contract Nos. HY/2010/02 and HY/2011/03.
- 2.2.2 The Action and Limit Levels for 1-hr TSP and 24-hr TSP are provided in **Table 2.2** and **Table 2.3**, respectively.

**Table 2.2 Action and Limit Levels for 1-hour TSP**

Monitoring Station	Action Level, $\mu\text{g}/\text{m}^3$	Limit Level, $\mu\text{g}/\text{m}^3$
AMS 6 – Dragonair / CNAC (Group) Building (HKIA)	360	500
AMS 7A - Chu Kong Air-Sea Union Transportation Co. Ltd.	370	

**Table 2.3 Action and Limit Levels for 24-hour TSP**

Monitoring Station	Action Level, $\mu\text{g}/\text{m}^3$	Limit Level, $\mu\text{g}/\text{m}^3$
AMS 6 – Dragonair / CNAC (Group) Building (HKIA)	173	260
AMS 7A - Chu Kong Air-Sea Union Transportation Co. Ltd.	183	

- 2.2.3 The event and action plan is provided in **Appendix D**.
- 2.2.4 If exceedance(s) at these station(s) is/are recorded by the ET of the Contract or referred by the other ET under the HZMB project to the Contract, the ET of the Contract will carry out an investigation and findings will be reported in the monthly EM&A Report.

## 2.3 Monitoring Results

- 2.3.1 The monitoring results for AMS6 and AMS7A are reported in the monthly EM&A Reports prepared for Contract Nos. HY/2011/03 and HY/2010/02, respectively.
- 2.3.2 Summary of Action and Limit Level exceedance of 1-hr TSP level and 24-hr TSP level at AMS6 shall be referred to the monthly EM&A report prepared by Contract No. HY/2011/03.
- 2.3.3 There was no Action and Limit Level exceedance of 1-hr TSP level and 24-hr TSP level recorded at AMS7A recorded by the ET of Contract No. HY/2010/02 during the reporting period.

### 3 Noise Monitoring

#### 3.1 Monitoring Locations

- 3.1.1 The noise monitoring works for the Contract are covered by Contract No. HY/2010/02 Hong Kong-Zhuhai-Macao Bridge HKBCF – Reclamation Works. The ET of the Contract or another ET of the HZMB project is required to conduct impact noise monitoring at NMS2 and NMS3B as part of EM&A programme if these noise monitoring stations are no longer covered under Contract No. HY/2010/02. **Figure 3.1** shows the locations of noise monitoring stations.

**Table 3.1 Construction Noise Monitoring Locations**

ID	Location Description
NMS2 <sup>(1)</sup>	Seaview Crescent
NMS3B <sup>(1)(2)</sup>	Site Boundary of Site Office Area at Works Area WA2

Remarks:

- (1) The ET of this Contract should conduct impact noise monitoring at the NMS listed in the table as part of EM&A programme according to the latest notification from ENPO when the monitoring station(s) is/are no longer covered by another ET of the HZMB project.
- (2) The Action and Limit Levels for schools will be applied for this alternative monitoring location.

#### 3.2 Monitoring Requirements

- 3.2.1 The monitoring requirements, monitoring equipment, monitoring parameters, frequency and duration, monitoring methodology and monitoring schedule are detailed in the monthly EM&A Reports prepared for Contract Nos. HY/2010/02.
- 3.2.2 The Action and Limit Levels for construction noise are defined in **Table 3.2**.

**Table 3.2 Action and Limit Level for Construction Noise**

Parameter	Action Level	Limit Level
07:00 – 19:00 hours on normal weekdays	When one documented complaint is received	75 dB(A)*

Notes :

If works are to be carried out during restricted hours, the conditions stipulated in the construction noise permit issued by the Noise Control Authority have to be followed.

\* Limit level is 70 dB(A) for schools and 65 dB(A) during school examination period.

- 3.2.3 The event and action plan is provided in **Appendix D**.
- 3.2.4 If exceedance(s) at these station(s) is/are recorded by the ET of the Contract or referred by the other ET under the HZMB project to the Contract, the ET of the Contract will carry out an investigation and findings will be reported in the monthly EM&A Report.

#### 3.3 Monitoring Results

- 3.3.1 The monitoring results for NMS2 and NMS3B are reported in the monthly EM&A Reports prepared for Contract No. HY/2010/02. No noise exceedances were recorded at stations NMS2 and NMS3B by the ET of Contract No. HY/2010/02 during the reporting period.



## 4 Environmental Site Inspection and Audit

### 4.1 Site Inspection

- 4.1.1 Site Inspections were carried out on a weekly basis to monitor the implementation of proper environmental pollution control and mitigation measures for the Project. During the reporting period, site inspections were carried out on 4, 11, 18, and 25 November 2015.
- 4.1.2 Particular observations during the site inspections and corrective actions undertaken by the Contractor are described below.

#### 4 November 2015

- (a) Water was leaking from a water hose next to the site office. This observation was found on 4 November 2015 and closed on 11 November 2015.
- (b) A rubbish bin next to the site office was full. This observation was found on 4 November 2015 and closed on 11 November 2015.

#### 11 November 2015

- (a) A bucket of grease was placed on bare soil and not stored inside a drip tray. This observation was found on 11 November 2015 and closed on 18 November 2015.

#### 18 November 2015

- (a) Fugitive dust was observed from concrete breaking works at WA1. This observation was found on 18 November 2015 and closed on 25 November 2015.

#### 25 November 2015

- (a) Rubbish was found along the pedestrian walkway and around the general refuse bins adjacent to the sub-contractor's container office.

The Contractor has rectified observations as identified during environmental site inspections within this reporting month. The follow-up actions for outstanding observation will be checked in the upcoming site inspections and reported in the coming reporting period.

### 4.2 Advice on the Solid and Liquid Waste Management Status

- 4.2.1 The Contractor registered as a chemical waste producer for the Contract. Sufficient numbers of receptacles were available for general refuse collection and sorting.
- 4.2.2 No excavated marine sediment was generated and treated using cement solidification/stabilization (Cement S/S) techniques during the reporting period.
- 4.2.3 The monthly summary of waste flow table is detailed in **Appendix E**.
- 4.2.4 The Contractor was reminded that chemical waste should be properly treated and stored temporarily in designated chemical waste storage areas on site in accordance with the Code of Practise on the Packaging, Labelling and Storage of Chemical Wastes.



#### 4.3 Environmental Licenses and Permits

- 4.3.1 The valid environmental licenses and permits during the reporting period are summarized in **Appendix F**.

#### 4.4 Implementation Status of Environmental Mitigation Measures

- 4.4.1 In response to the site audit findings, the Contractors carried out corrective actions.
- 4.4.2 The Contractor conducts watering on all exposed soil within the Contract site and associated works areas 8 times per day when construction activities are being undertaken.
- 4.4.3 A summary of the Implementation Schedule of Environmental Mitigation Measures (EMIS) is presented in **Appendix G**. Most of the necessary mitigation measures were implemented properly.

#### 4.5 Summary of Exceedance of the Environmental Quality Performance Limit

- 4.5.1 Summary of Action and Limit Level exceedance of 1-hr TSP level and 24-hr TSP level at AMS6 shall be referred to the monthly EM&A report prepared by Contract No. HY/2011/03.
- 4.5.2 There was no Action and Limit Level exceedance of 1-hr TSP level and 24-hr TSP level recorded at AMS7A by the Environmental Team of Contract No. HY/2010/02 during the reporting period.
- 4.5.3 There was no Action and Limit Level exceedance for noise recorded at NMS2 and NMS3B by the Environmental Team of Contract No. HY/2010/02 during the reporting period.

#### 4.6 Summary of Complaints, Notification of Summons and Successful Prosecution

- 4.6.1 There were no complaints received in relation to the environmental impact during the reporting period. No notification of summons and prosecution was received during the reporting period.
- 4.6.2 Statistics on environmental complaints, notifications of summons and successful prosecutions are summarized in **Appendix H**.

## 5 Future Key Issues

### 5.1 Construction Programme for the Coming Months

5.1.1 As informed by the Contractor, the major construction activities for December 2015 are summarized in **Table 5.1**.

**Table 5.1 Construction Activities for December 2015**

Site Area	Description of Activities
WA1	Bulk Excavation at WA1
WA1	Pile Cropping at WA1
WA1	Tie Beams at WA1
WA1	Pile Capping at WA1
WA1	Base Slab Construction at WA1
WA1	Waterproofing at WA1
WA1	Tower Crane Erection at WA1
WA1	Southern Drop off Area Pile Capping & Column at WA1
WA1	Southern Drop off Area Deck Construction (WA1)
WA1	Column and Wall Construction at WA1
WA1	Suspended Slab Construction at WA1
WA1	Seawater Pump House Socket H-pile works at WA1
WA1	Marine Mud Treatment at WA1
WA1	Backfilling at WA1
WA1	Mega Column Construction (WA1)
WA1	Bulk Excavation at Box Culvert (WA1)
WA1	RC works at Box Culvert (WA1)
WA1	Bored Pilling Works at Box Culvert (WA1)
WA1	Cut Platform at Box Culvert (WA1)

### 5.2 Environmental Site Inspection Schedule for the Coming Month

5.2.1 The tentative schedule for weekly site inspections for December 2015 is provided in **Appendix I**.



## 6 Conclusions

### 6.1 Conclusions

- 6.1.1 The site preparation work of the Contract started on 26 September 2014 and the construction works of the Contract commenced on 6 October 2014. The fourteenth Monthly EM&A Report summarizes findings of the EM&A works during the reporting period from 1 November 2015 to 30 November 2015.
- 6.1.2 Summary of Action and Limit Level exceedance of 1-hr TSP level and 24-hr TSP level at AMS6 shall be referred to the monthly EM&A report prepared by Contract No. HY/2011/03.
- 6.1.3 There was no Action and Limit Level exceedance of 1-hr TSP level and 24-hr TSP level recorded at AMS7A by the Environmental Team of Contract No. HY/2010/02 during the reporting period.
- 6.1.4 There was no Action and Limit Level exceedance for noise recorded at NMS2 and NMS3B by the Environmental Team of Contract No. HY/2010/02 during the reporting period.
- 6.1.5 An environmental site inspection was carried out on 4, 11, 18, and 25 November 2015. Recommendations on remedial actions were given to the Contractors for the deficiencies identified during the site inspections.
- 6.1.6 There were no complaints received in relation to the environmental impact during the reporting period.
- 6.1.7 No notification of summons and successful prosecution was received during the reporting period.



## FIGURES

---

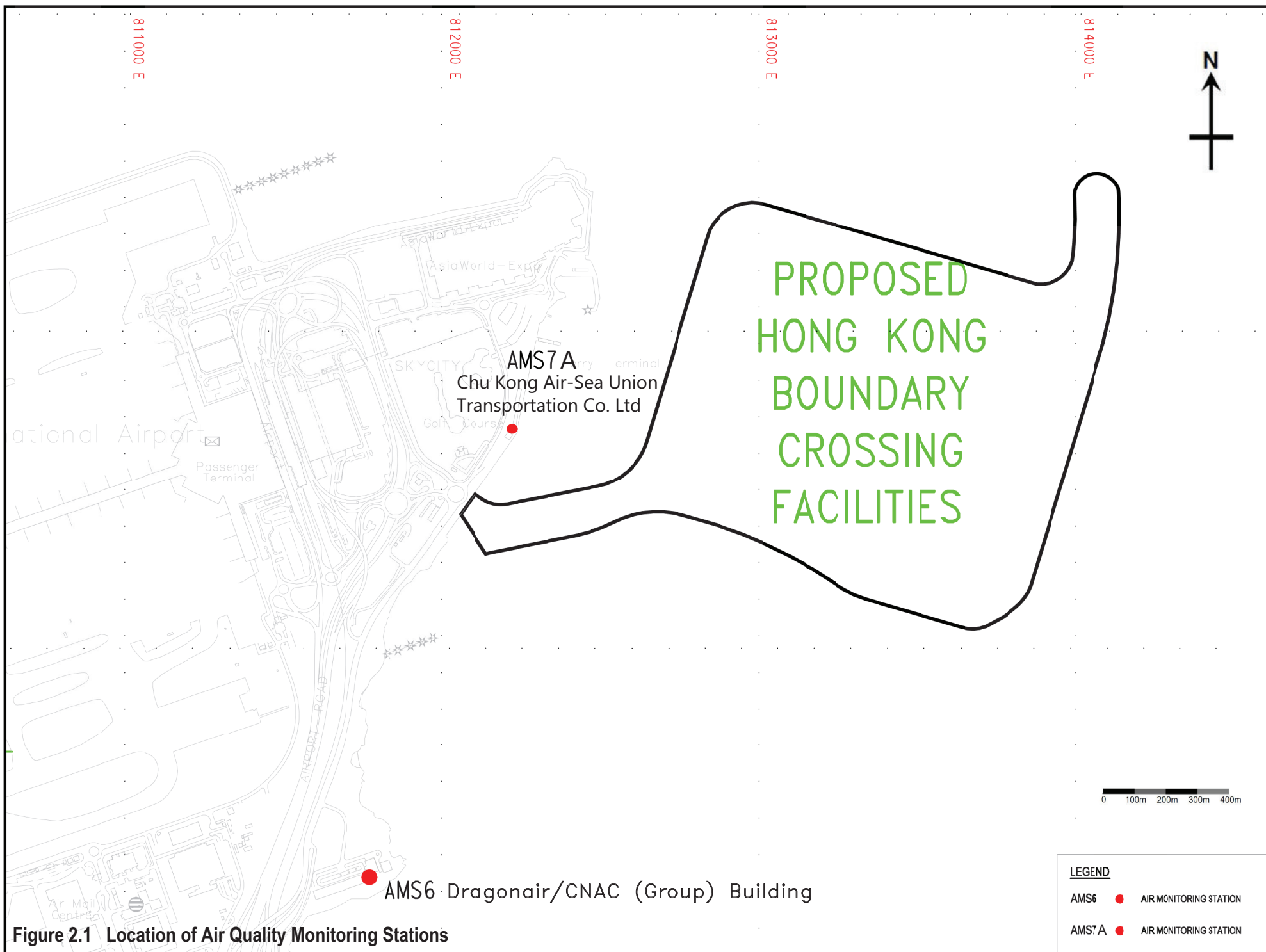
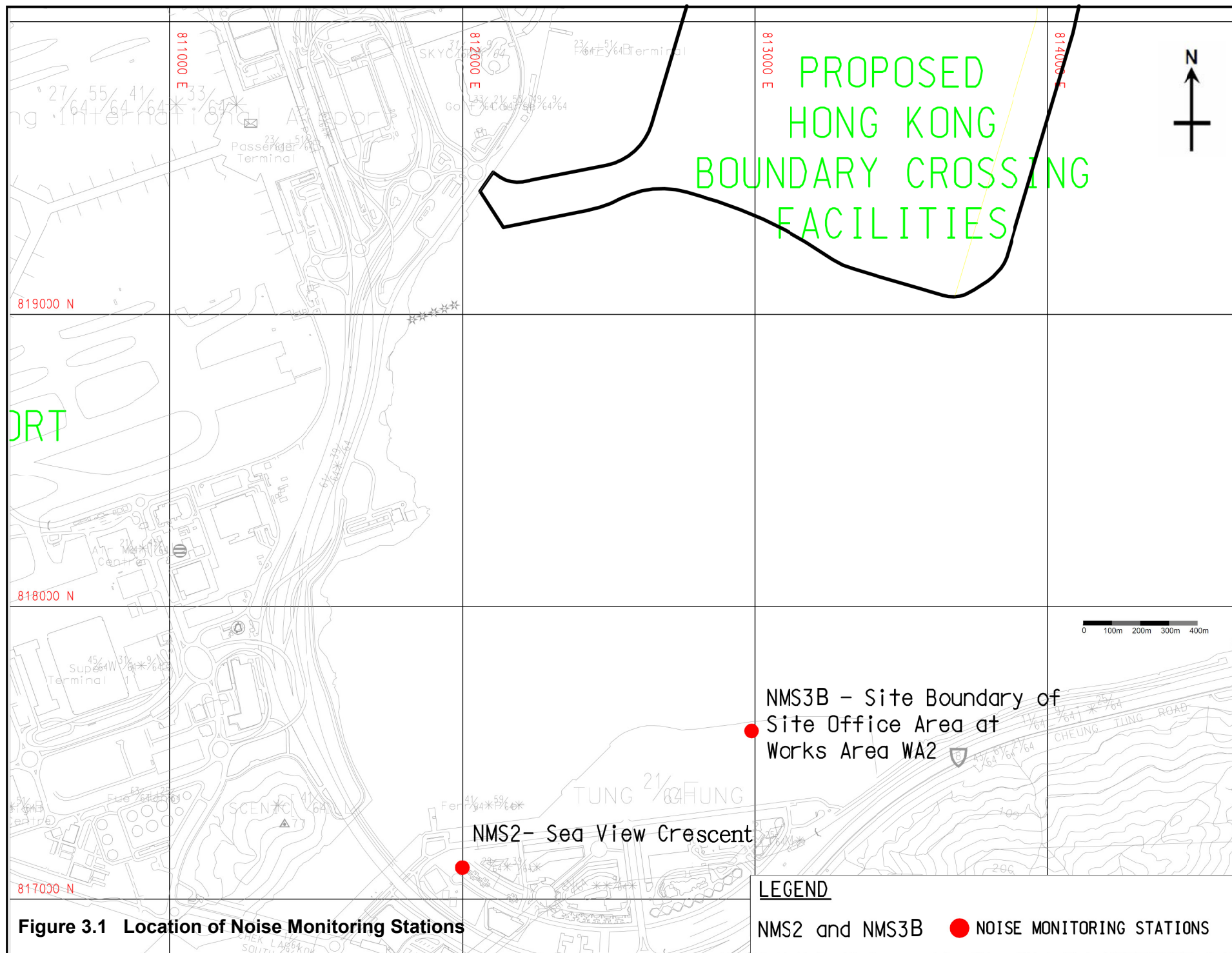

Figure 2.1 Location of Air Quality Monitoring Stations





路政署  
**HIGHWAYS DEPARTMENT**

港珠澳大橋香港工程管理處  
Hong Kong - Zhuhai - Macao Bridge  
Hong Kong Project Management Office

Contract No. HY/2013/01

Hong Kong-Zhuhai-Macao Bridge

Hong Kong Boundary Crossing Facilities – Passenger Clearance Building

14<sup>th</sup> Monthly EM&A Report

## APPENDIX A

Location of Works Areas



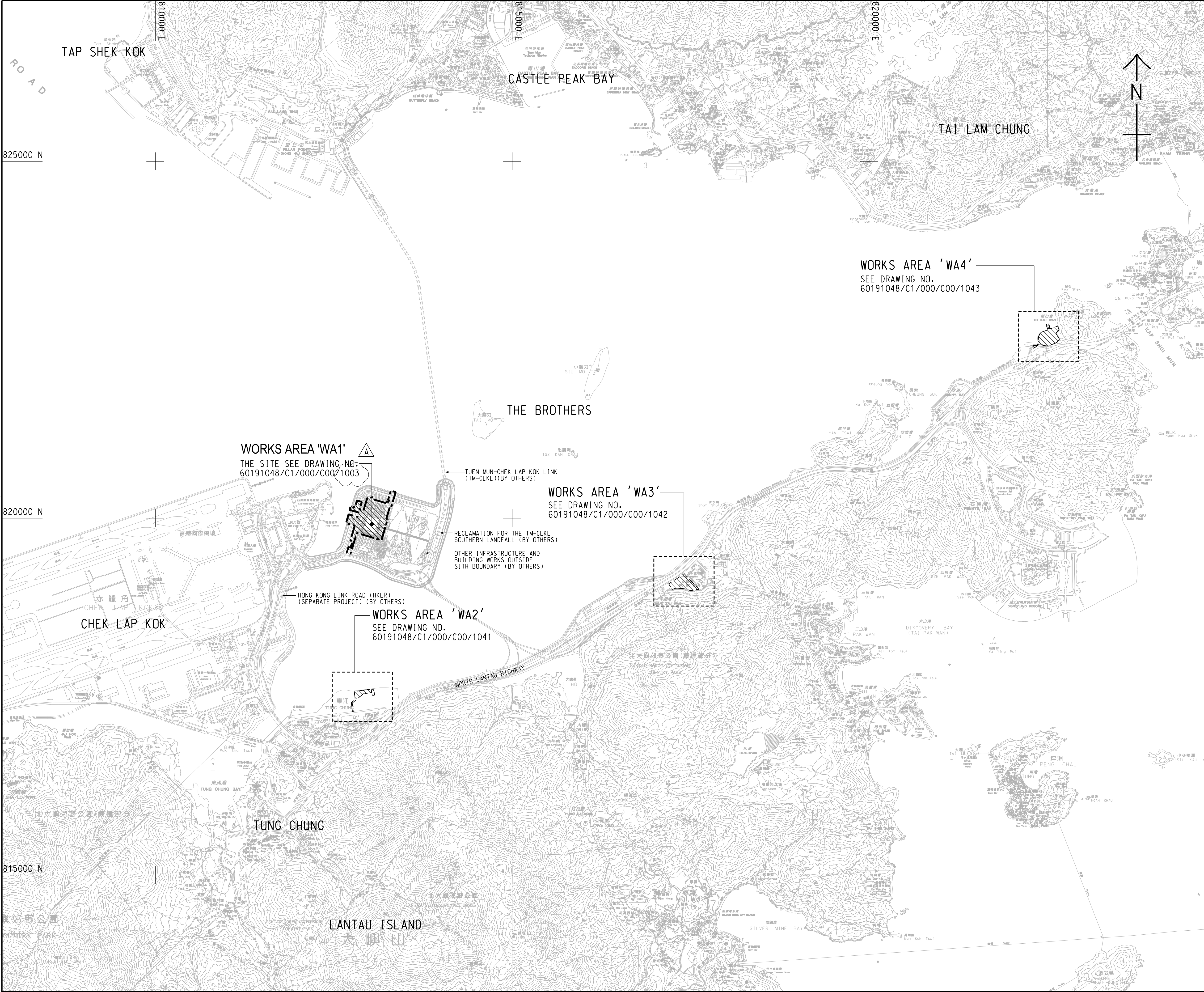

NOTES:

1. COORDINATES ARE RELATED TO HONG KONG METRIC GRID (1980).
2. DIMENSIONS ARE IN MILLIMETER AND CHAINAGE ARE IN METRES UNLESS OTHERWISE SHOWN.
3. THIS DRAWING SHALL BE READ IN CONJUNCTION WITH DRAWING NOS. 60191048/C1/000/C00/1041 TO 1043.

LEGEND:

- SITE BOUNDARY
- ▨ WORKS AREA

B	WORKING DRAWING	BWCW SCI JUN.14
A	TENDER ADDENDUM NO. 1	BWCW SCI OCT.13
-	TENDER DRAWING	BWCW SCI SEP.13

REV.	DESCRIPTION	CHECKED	DATE
1	ISSUED FOR TENDER		

路政署  
HIGHWAYS DEPARTMENT  
港珠澳大桥香港工程管理处  
Hong Kong - Zhuhai - Macao Bridge Hong Kong Project Management Office

HONG KONG-ZHUHAI-MACAO BRIDGE  
HONG KONG BOUNDARY CROSSING FACILITIES  
- PASSENGER CLEARANCE BUILDING

SITE LOCATION PLAN



Rogers Stirk Harbour + Partners  
BURO HAPPOLD   ATKINS   ADI

DRG.NO. 60191048/C1/000/C00/1000B  
圖紙編號

DESIGNED BY 設計	CONTRACT NO. 合約編號	P. B. APPROVED 批准人
BWCW	HY/2013/01	TKH
DRAWN BY 繪圖	STATUS 階段	
WSY		
SCALE 比例		
A1 1 : 25000		
DIMENSIONS ARE IN 尺寸單位		
METRES		

**WORKING DRAWING**  
© COPYRIGHT RESERVED  
版權所有



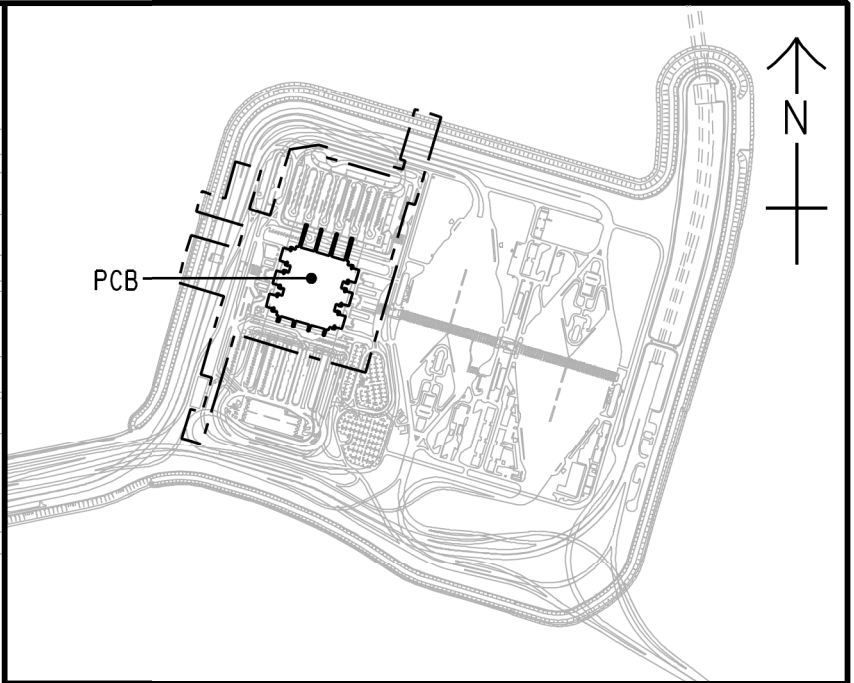
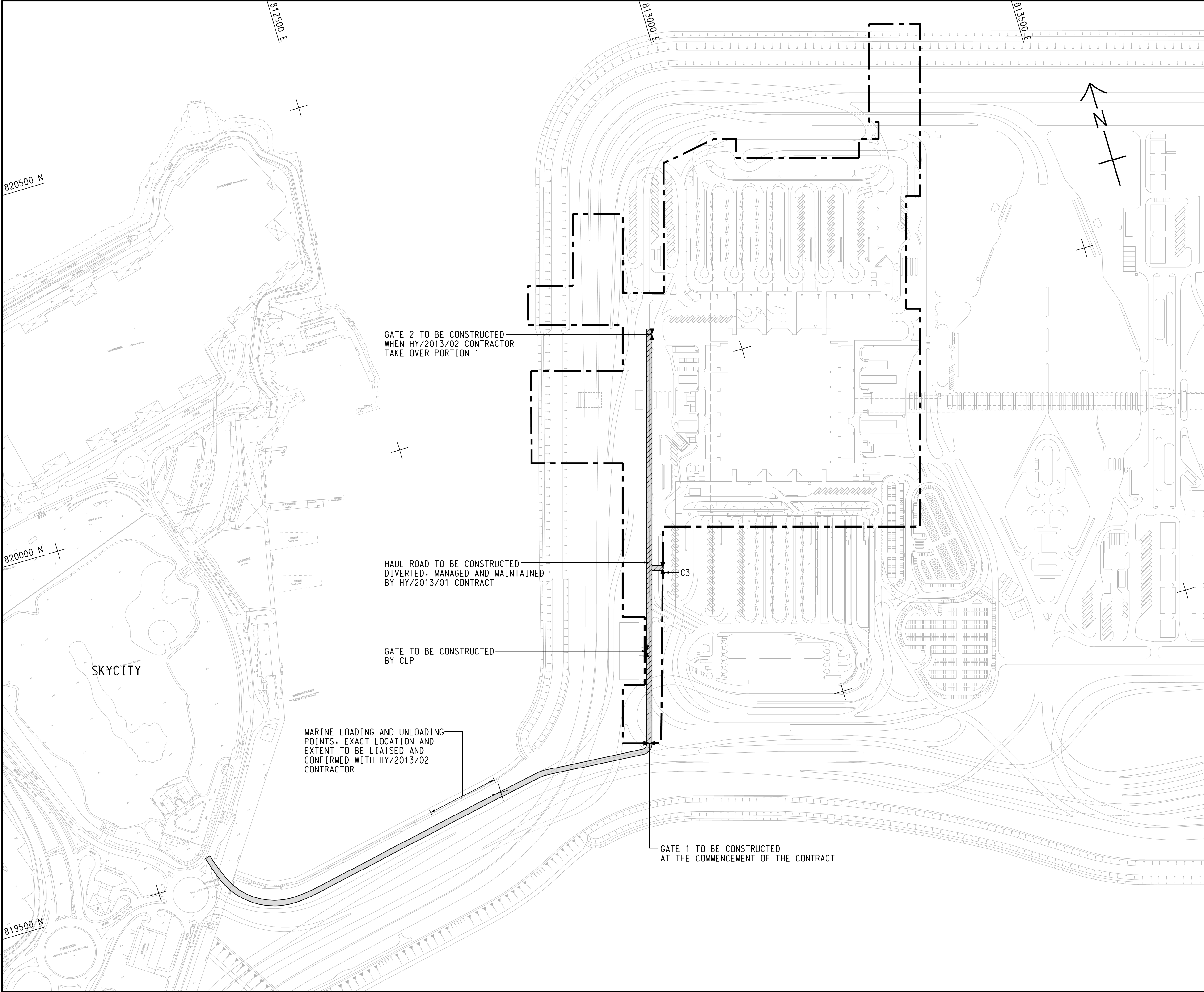

LOCATION PLAN  
SCALE 1 : 20000

- NOTES:
- COORDINATES ARE BASED ON HONG KONG METRIC GRID (1980) UNLESS OTHERWISE NOTED.
  - LEVELS ARE IN METRES RELATIVE TO HONG KONG PRINCIPAL DATUM (mPD) UNLESS OTHERWISE NOTED.
  - DIMENSIONS ARE IN METRES UNLESS OTHERWISE STATED.
  - SETTING OUT, DIMENSIONS, LEVELS, COORDINATES ARE TO BE CALCULATED BY THE CONTRACTOR. NO INFORMATION SHOULD BE SCALED PHYSICALLY OR ELECTRONICALLY FROM THE DRAWINGS OR FILES.
  - SITE ACCESS SHALL BE HARD PAVED WITH PROPER DRAINAGE PROVIDED. IT SHALL BE KEPT UNOBSTRUCTED AND UNDISRUPTED AT ALL TIMES.

- LEGEND:
- SITE BOUNDARY
  - 7.3m CLEAR WIDTH CONSTRUCTION HAUL ROAD
  - INDICATIVE 20m WIDE VEHICULAR ACCESS BY RECLAMATION CONTRACT HY/2010/02

REV.	DESCRIPTION	CHECKED	DATE
01	TENDER DRAWING	BWCW SCI	SEP.13

路政署  
HIGHWAYS DEPARTMENT  
港珠澳大橋香港工程管理局  
Hong Kong - Zhuhai - Macao Bridge Hong Kong Project Management Office

HONG KONG-ZHUHAI-MACAO BRIDGE  
HONG KONG BOUNDARY CROSSING FACILITIES  
- PASSENGER CLEARANCE BUILDING

WORKS AREA WA1

**AECOM** **Aedas**  
Rogers Stirk Harbour + Partners  
BURO HAPPOLD ATKINS ADI

DRG.NO. 60191048/C1/000/C00/1044  
圖紙編號

DESIGNED BY 設計	CONTRACT NO. 合約編號	P. Dir. APPROVED 批准人
BWCW	HY/2013/01	EMSC
DRAWN BY 繪圖	STATUS 階段	
WSY		
SCALE 比例		
A1 1 : 2500		
DIMENSIONS ARE IN 尺寸單位		
METRES		

© COPYRIGHT RESERVED  
版權所有

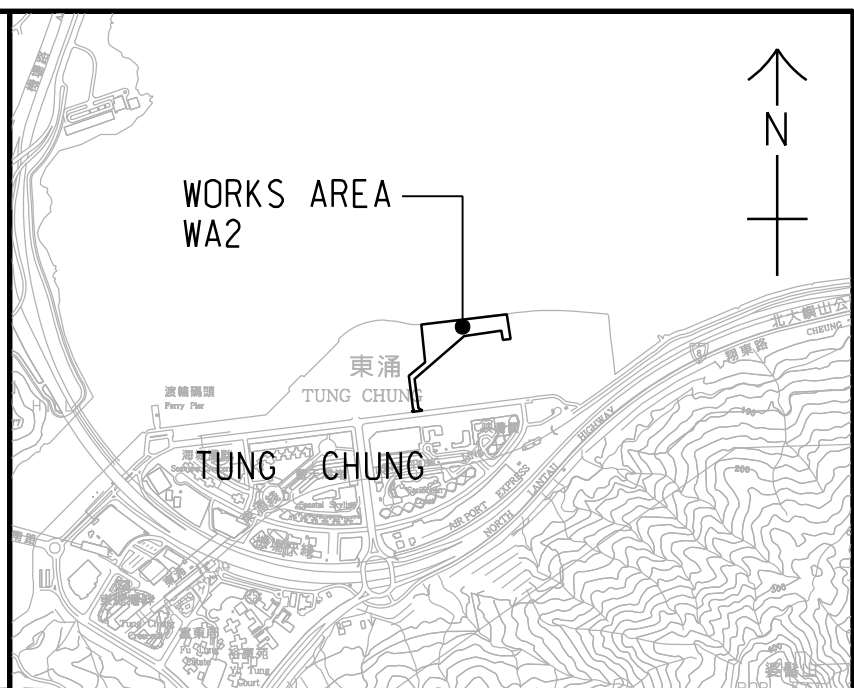
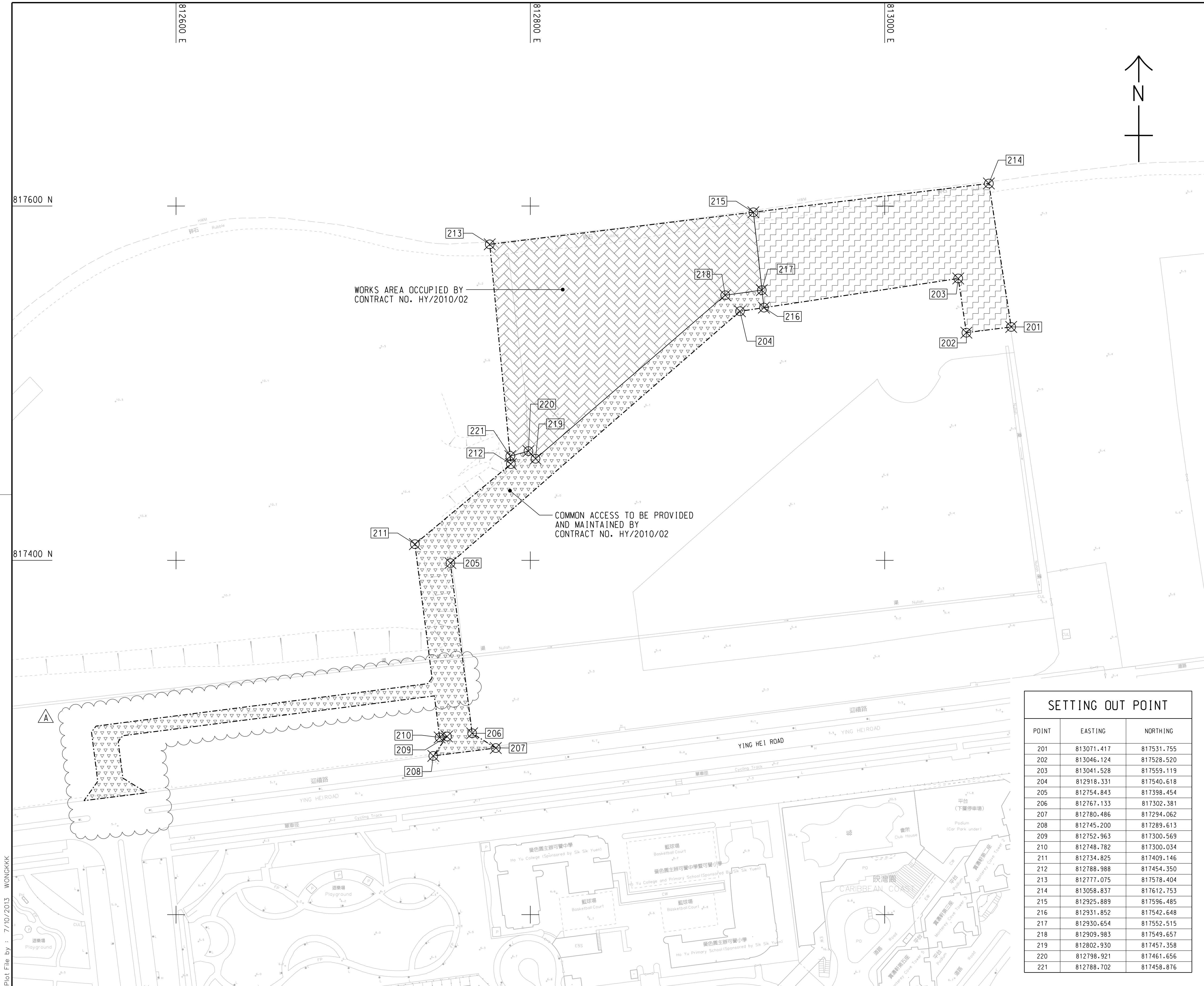

# LOCATION PLAN

SCALE 1 : 25000

- NOTES:
- COORDINATES ARE RELATED TO HONG KONG METRIC GRID (1980).
  - DIMENSIONS ARE IN MILLIMETER AND CHAINAGE ARE IN METRES UNLESS OTHERWISE SHOWN.

- LEGEND:
- WORKS AREA BOUNDARY
  - PORTION 2.1
  - PORTION 2.2
  - PORTION 2.3

B	WORKING DRAWING	BWCW SCI JUN.14
A	TENDER ADDENDUM NO. 1	BWCW SCI OCT.13
-	TENDER DRAWING	BWCW SCI SEP.13
REV.	DESCRIPTION	CHECKED DATE
修訂	內容摘要	查核 日期



HONG KONG-ZHUHAI-MACAO BRIDGE  
HONG KONG BOUNDARY CROSSING FACILITIES  
- PASSENGER CLEARANCE BUILDING

## WORKS AREA WA2

**AECOM**  
Rogers Stirk Harbour + Partners  
BURO HAPPOLD ATKINS ADI

**Aedas**

DRG.NO. 60191048/C1/000/C00/1041B  
圖紙編號

DESIGNED BY BWCW CONTRACT NO. HY/2013/01 P. DIR. APPROVED TKH  
設計 合約編號 查核人

DRAWN BY WSY STATUS RELEASED  
繪圖 核發

SCALE A1 1 : 1000  
比例尺

DIMENSIONS ARE IN METRES  
尺寸單位

**WORKING DRAWING**  
© COPYRIGHT RESERVED  
版權所有

SETTING OUT POINT		
POINT	EASTING	NORTHING
201	813071.417	817531.755
202	813046.124	817528.520
203	813041.528	817559.119
204	812918.331	817540.618
205	812754.843	817398.454
206	812767.133	817302.381
207	812780.486	817294.062
208	812745.200	817289.613
209	812752.963	817300.569
210	812748.782	817300.034
211	812734.825	817409.146
212	812788.988	817454.350
213	812777.075	817578.404
214	813058.837	817612.753
215	812925.889	817596.485
216	812931.852	817542.648
217	812930.654	817552.515
218	812909.983	817549.657
219	812802.930	817457.358
220	812798.921	817461.656
221	812788.702	817458.876

Plot File by : 7/10/2013 WONGKKK



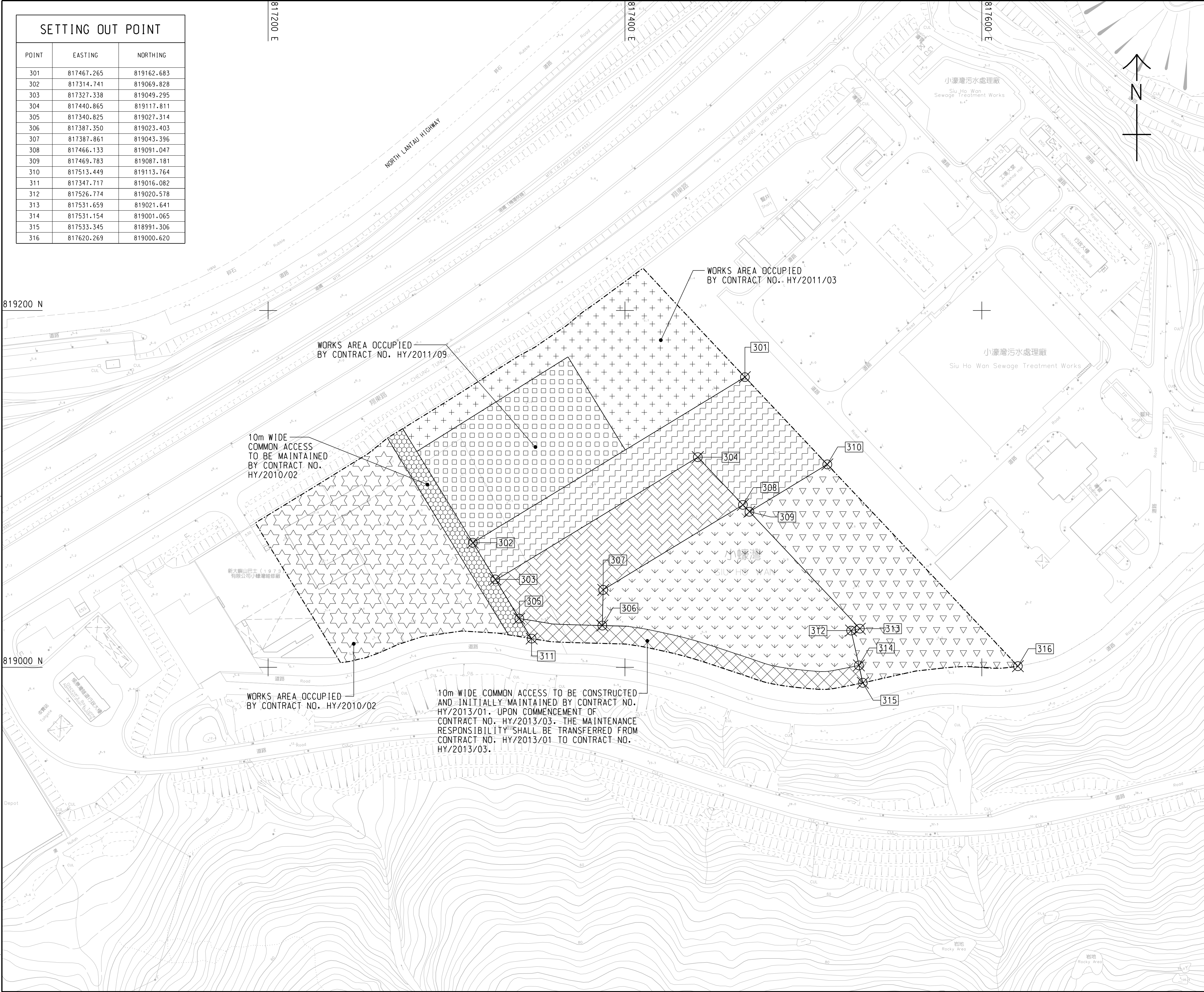

SETTING OUT POINT		
POINT	EASTING	NORTHING
301	817467.265	819162.683
302	817314.741	819069.828
303	817327.338	819049.295
304	817440.865	819117.811
305	817340.825	819027.314
306	817387.350	819023.403
307	817387.861	819043.396
308	817466.133	819091.047
309	817469.783	819087.181
310	817513.449	819113.764
311	817347.717	819016.082
312	817526.774	819020.578
313	817531.659	819021.641
314	817531.154	819001.065
315	817533.345	818991.306
316	817620.269	819000.620

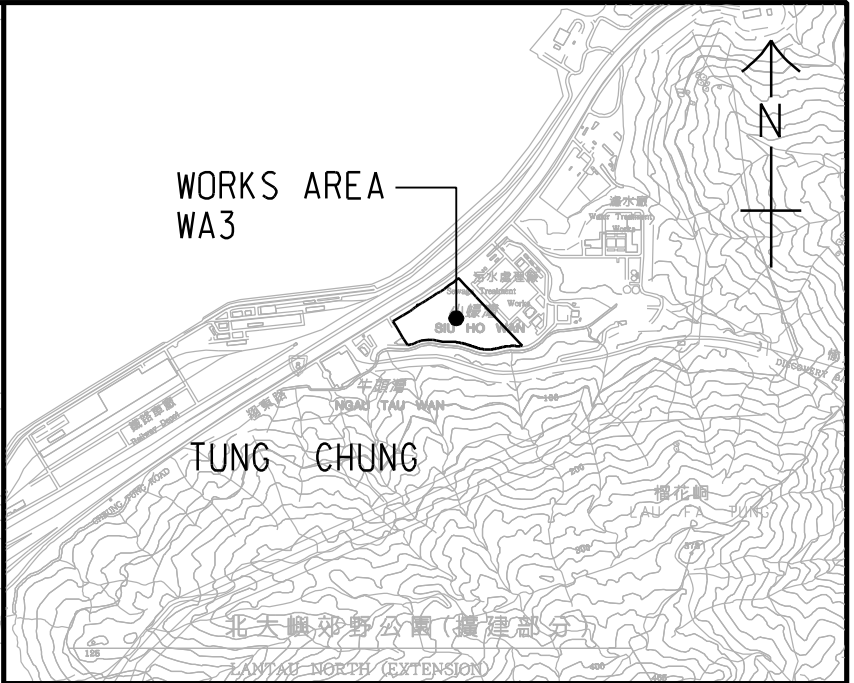

LOCATION PLAN  
SCALE 1 : 25000

- NOTES:
- COORDINATES ARE RELATED TO HONG KONG METRIC GRID (1980).
  - DIMENSIONS ARE IN MILLIMETER AND CHAINAGE ARE IN METRES UNLESS OTHERWISE SHOWN.

LEGEND:	
---	WORKS AREA BOUNDARY
[Pattern]	PORTION 3.1
[Pattern]	PORTION 3.2
[Pattern]	PORTION 3.3
[Pattern]	PORTION 3.4
[Pattern]	PORTION 3.5
[Pattern]	PORTION 3.6
[Pattern]	PORTION 3.7
[Pattern]	PORTION 3.8
[Pattern]	PORTION 3.9

A	WORKING DRAWING	18 JUL 14
-	TENDER DRAWING	BWCW SCI JUN.14
REV.	DESCRIPTION	DATE
修訂	內容摘要	日期

**路政署 HIGHWAYS DEPARTMENT**  
港珠澳大橋香港工程管理有限公司  
Hong Kong - Zhuhai - Macao Bridge Hong Kong Project Management Office

HONG KONG-ZHUHAI-MACAO BRIDGE  
HONG KONG BOUNDARY CROSSING FACILITIES  
- PASSENGER CLEARANCE BUILDING

WORKS AREA WA3

**AECOM** **Aedas**  
Rogers Stirk Harbour + Partners  
BURO HAPPOLD ATKINS ADI

DRG.NO. 60191048/C1/000/C00/1042A  
圖紙編號

DESIGNED BY 設計	CONTRACT NO. 合約編號	P. BY 校對人
BWCW	HY/2013/01	TKH

DRAWN BY 繪圖	STATUS 階段
WSY	WORKING DRAWING

SCALE  
比例  
A1 1 : 1000

DIMENSIONS ARE IN  
尺寸單位  
METRES

© COPYRIGHT RESERVED  
版權所有



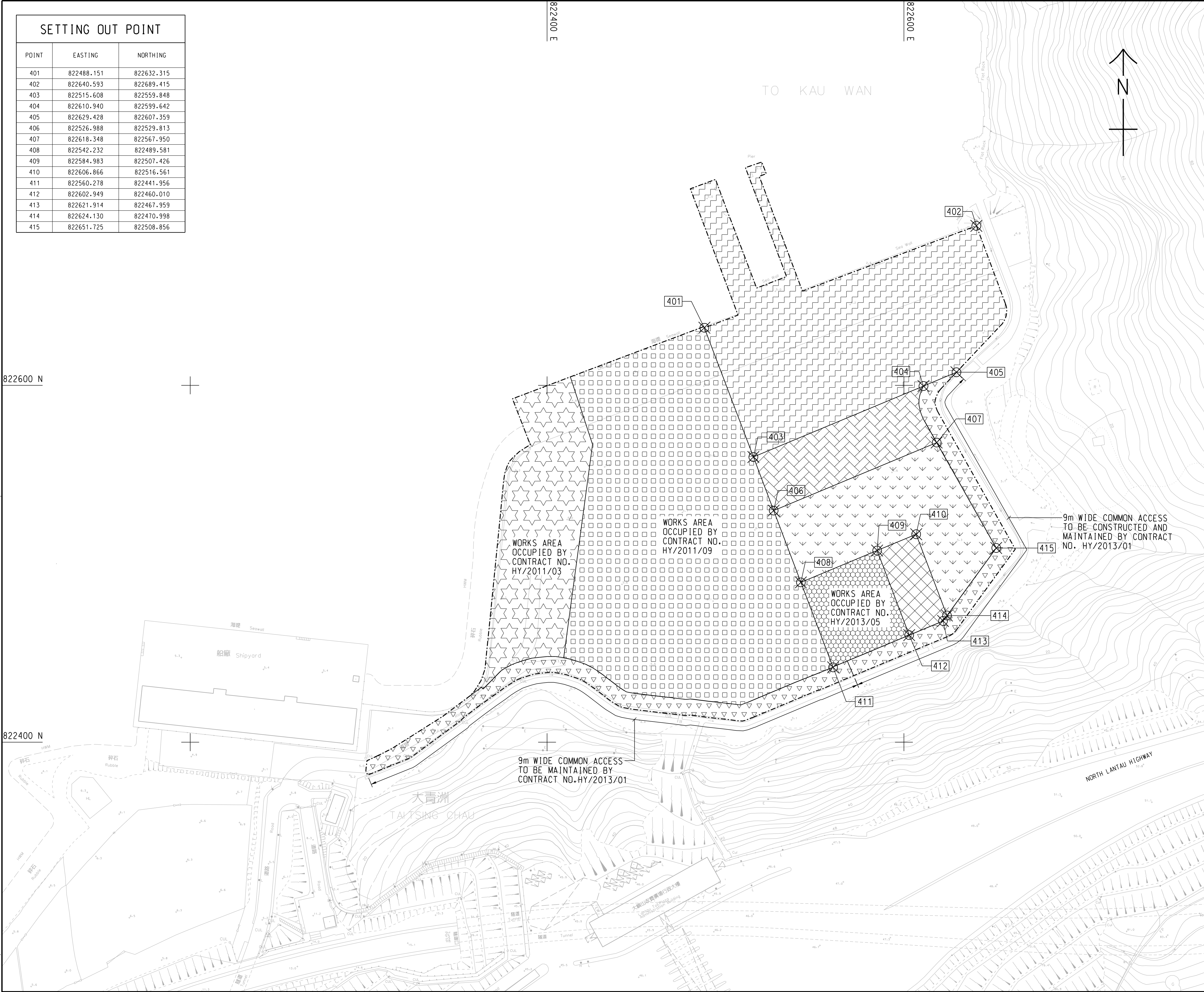

SETTING OUT POINT		
POINT	EASTING	NORTHING
401	822488.151	822632.315
402	822640.593	822689.415
403	822515.608	822559.848
404	822610.940	822599.642
405	822629.428	822607.359
406	822526.988	822529.813
407	822618.348	822567.950
408	822542.232	822489.581
409	822584.983	822507.426
410	822606.866	822516.561
411	822560.278	822441.956
412	822602.949	822460.010
413	822621.914	822467.959
414	822624.130	822470.998
415	822651.725	822508.856

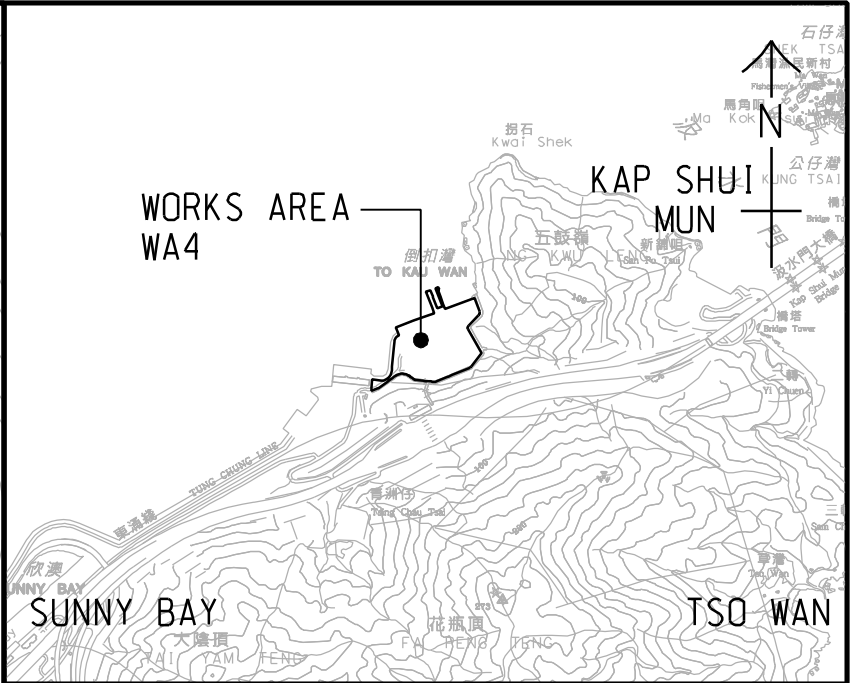

LOCATION PLAN  
SCALE 1 : 25000

- NOTES:
- COORDINATES ARE RELATED TO HONG KONG METRIC GRID (1980).
  - DIMENSIONS ARE IN MILLIMETER AND CHAINAGE ARE IN METRES UNLESS OTHERWISE SHOWN.

LEGEND:	
---	WORKS AREA BOUNDARY
[Pattern]	PORTION 4.1
[Pattern]	PORTION 4.2
[Pattern]	PORTION 4.3
[Pattern]	PORTION 4.4
[Pattern]	PORTION 4.5
[Pattern]	PORTION 4.6
[Pattern]	PORTION 4.7
[Pattern]	PORTION 4.8

REV.	DESCRIPTION	DATE
1	TENDER DRAWING	SEP.13

HONG KONG-ZHUHAI-MACAO BRIDGE  
HONG KONG-BORDER CROSSING FACILITIES  
- PASSENGER CLEARANCE BUILDING

WORKS AREA WA4

**AECOM** **Aedas**  
Rogers Stirk Harbour + Partners  
BURO HAPPOLD ATKINS ADI

DRG.NO. 60191048/C1/000/C00/1043  
圖紙編號

DESIGNED BY 設計	CONTRACT NO. 合約編號	P. Dir. APPROVED 批准人
BWCW	HY/2013/01	EMSC
DRAWN BY 繪圖	STATUS 階段	
WSY		
SCALE 比例	DIMENSIONS ARE IN 尺寸單位	
A1 1 : 1000	METRES	

© COPYRIGHT RESERVED  
版權所有



路政署  
**HIGHWAYS DEPARTMENT**

港珠澳大橋香港工程管理處  
Hong Kong - Zhuhai - Macao Bridge  
Hong Kong Project Management Office

Contract No. HY/2013/01

Hong Kong-Zhuhai-Macao Bridge

Hong Kong Boundary Crossing Facilities – Passenger Clearance Building

14<sup>th</sup> Monthly EM&A Report

---

## **APPENDIX B**

---

### **Project Organization for Environmental Works**

## Project Organisation for Environmental Works

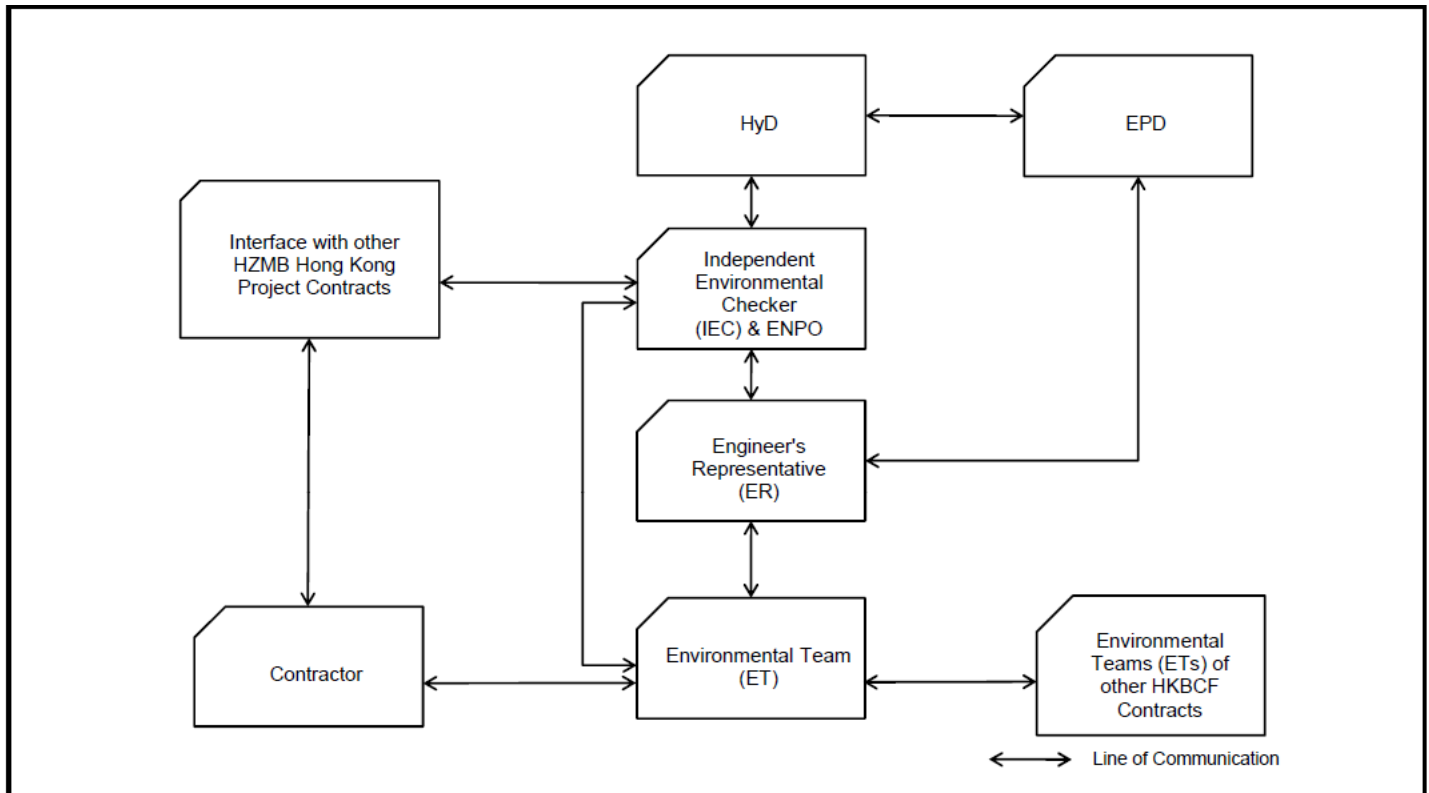



路政署  
**HIGHWAYS DEPARTMENT**

港珠澳大橋香港工程管理處  
Hong Kong - Zhuhai - Macao Bridge  
Hong Kong Project Management Office

Contract No. HY/2013/01

Hong Kong-Zhuhai-Macao Bridge

Hong Kong Boundary Crossing Facilities – Passenger Clearance Building

14<sup>th</sup> Monthly EM&A Report

---

## **APPENDIX C**

---

### **Construction Programme**

Activity ID	Activity Name	Original Duration	Start	Finish																																																																																																																																																																																																																																																																																																																																																																																																																																																																																																																																																																																																																																																																																																																																																																																																																																																																																																																																																																																																																																																																																																																																																																																																																																																																																																																																																
HY/2013/01 HKZMB HKBCF - PCB - 3MRP - October 21					16	Nov 02	Nov 09	Nov 16	Nov 23	Nov 30	Dec 07	Dec 14	Dec 21	Dec 28	Jan 04	Jan 11	Jan 18	Jan 25	Feb 01	Feb 08	Feb 15	Feb 22																																																																																																																																																																																																																																																																																																																																																																																																																																																																																																																																																																																																																																																																																																																																																																																																																																																																																																																																																																																																																																																																																																																																																																																																																																																																																																																														
CONSTRUCTION					F	S	M	T	T	F	S	M	T	T	F	S	M	T	T	F	S	M	T	T	F	S	M	T	T	F	S	M	T	T	F	S	M	T	T	F	S	M	T	T	F	S	M	T	T	F	S	M	T	T	F	S	M	T	T	F	S	M	T	T	F	S	M	T	T	F	S	M	T	T	F	S	M	T	T	F	S	M	T	T	F	S	M	T	T	F	S	M	T	T	F	S	M	T	T	F	S	M	T	T	F	S	M	T	T	F	S	M	T	T	F	S	M	T	T	F	S	M	T	T	F	S	M	T	T	F	S	M	T	T	F	S	M	T	T	F	S	M	T	T	F	S	M	T	T	F	S	M	T	T	F	S	M	T	T	F	S	M	T	T	F	S	M	T	T	F	S	M	T	T	F	S	M	T	T	F	S	M	T	T	F	S	M	T	T	F	S	M	T	T	F	S	M	T	T	F	S	M	T	T	F	S	M	T	T	F	S	M	T	T	F	S	M	T	T	F	S	M	T	T	F	S	M	T	T	F	S	M	T	T	F	S	M	T	T	F	S	M	T	T	F	S	M	T	T	F	S	M	T	T	F	S	M	T	T	F	S	M	T	T	F	S	M	T	T	F	S	M	T	T	F	S	M	T	T	F	S	M	T	T	F	S	M	T	T	F	S	M	T	T	F	S	M	T	T	F	S	M	T	T	F	S	M	T	T	F	S	M	T	T	F	S	M	T	T	F	S	M	T	T	F	S	M	T	T	F	S	M	T	T	F	S	M	T	T	F	S	M	T	T	F	S	M	T	T	F	S	M	T	T	F	S	M	T	T	F	S	M	T	T	F	S	M	T	T	F	S	M	T	T	F	S	M	T	T	F	S	M	T	T	F	S	M	T	T	F	S	M	T	T	F	S	M	T	T	F	S	M	T	T	F	S	M	T	T	F	S	M	T	T	F	S	M	T	T	F	S	M	T	T	F	S	M	T	T	F	S	M	T	T	F	S	M	T	T	F	S	M	T	T	F	S	M	T	T	F	S	M	T	T	F	S	M	T	T	F	S	M	T	T	F	S	M	T	T	F	S	M	T	T	F	S	M	T	T	F	S	M	T	T	F	S	M	T	T	F	S	M	T	T	F	S	M	T	T	F	S	M	T	T	F	S	M	T	T	F	S	M	T	T	F	S	M	T	T	F	S	M	T	T	F	S	M	T	T	F	S	M	T	T	F	S	M	T	T	F	S	M	T	T	F	S	M	T	T	F	S	M	T	T	F	S	M	T	T	F	S	M	T	T	F	S	M	T	T	F	S	M	T	T	F	S	M	T	T	F	S	M	T	T	F	S	M	T	T	F	S	M	T	T	F	S	M	T	T	F	S	M	T	T	F	S	M	T	T	F	S	M	T	T	F	S	M	T	T	F	S	M	T	T	F	S	M	T	T	F	S	M	T	T	F	S	M	T	T	F	S	M	T	T	F	S	M	T	T	F	S	M	T	T	F	S	M	T	T	F	S	M	T	T	F	S	M	T	T	F	S	M	T	T	F	S	M	T	T	F	S	M	T	T	F	S	M	T	T	F	S	M	T	T	F	S	M	T	T	F	S	M	T	T	F	S	M	T	T	F	S	M	T	T	F	S	M	T	T	F	S	M	T	T	F	S	M	T	T	F	S	M	T	T	F	S	M	T	T	F	S	M	T	T	F	S	M	T	T	F	S	M	T	T	F	S	M	T	T	F	S	M	T	T	F	S	M	T	T	F	S	M	T	T	F	S	M	T	T	F	S	M	T	T	F	S	M	T	T	F	S	M	T	T	F	S	M	T	T	F	S	M	T	T	F	S	M	T	T	F	S	M	T	T	F	S	M	T	T	F	S	M	T	T	F	S	M	T	T	F	S	M	T	T	F	S	M	T	T	F	S	M	T	T	F	S	M	T	T	F	S	M	T	T	F	S	M	T	T	F	S	M	T	T	F	S	M	T	T	F	S	M	T	T	F	S	M	T	T	F	S	M	T	T	F	S	M	T	T	F	S	M	T	T	F	S	M	T	T	F	S	M	T	T	F	S	M	T	T	F	S	M	T	T	F	S	M	T	T	F	S	M	T	T	F	S	M	T	T	F	S	M	T	T	F	S	M	T	T	F	S	M	T	T	F	S	M	T	T	F	S	M	T	T	F	S	M	T	T	F	S	M	T	T	F	S	M	T	T	F	S	M	T	T	F	S	M	T	T	F	S	M	T	T	F	S	M	T	T	F	S	M	T	T	F	S	M	T	T	F	S	M	T	T	F	S	M	T	T	F	S	M	T	T	F	S	M	T	T	F	S	M	T	T	F	S	M	T	T	F	S	M	T	T	F	S	M	T	T	F	S	M	T	T	F	S	M	T	T	F	S	M	T	T	F	S	M	T	T	F	S	M	T	T	F	S	M	T	T	F	S	M	T	T	F	S	M	T	T	F	S	M	T	T	F	S	M	T	T	F	S	M	T	T	F	S	M	T	T	F	S	M	T	T	F	S	M	T	T	F	S	M	T	T	F	S	M	T	T	F	S	M	T	T	F	S	M	T	T	F	S	M	T	T	F	S	M	T	T	F	S	M	T	T	F	S	M	T	T	F	S	M	T	T	F	S	M	T	T	F	S	M	T	T	F	S	M	T	T	F	S	M	T	T	F	S	M	T	T	F	S	M	T	T	F	S	M	T	T	F	S	M	T	T	F	S	M	T	T	F	S	M	T	T	F	S	M	T	T	F	S	M	T	T	F	S	M	T	T	F	S	M	T	T	F	S	M	T	T	F	S	M	T	T	F	S	M	T	T	F	S	M	T	T	F	S	M	T	T	F	S	M	T	T	F	S	M	T	T	F	S	M	T	T	F	S	M	T	T	F	S	M	T	T	F	S	M	T	T	F	S	M	T	T	F	S	M	T	T	F	S	M	T	T	F	S	M	T	T	F







Activity ID	Activity Name	Original Duration	Start	Finish	19																			20																			21																			22																																																																																																																																																																																																																																																																																																																																																																																																																																																																																																																																																																																																																																																																																																																																																																																																																																																																																																																																																																																																																																																																																																																																																																																																																																																															
					16	Nov 02				Nov 09				Nov 16				Nov 23				Nov 30				Dec 07				Dec 14				Dec 21				Dec 28				Jan 04				Jan 11				Jan 18				Jan 25				Feb 01				Feb 08				Feb 15				Feb 22																																																																																																																																																																																																																																																																																																																																																																																																																																																																																																																																																																																																																																																																																																																																																																																																																																																																																																																																																																																																																																																																																																																																																																																																																																																							
	PCB-02-21820	PCB - Base Slab (GL1.2 to 2.2) F-E.5 - 562m³ Pour BS14	18	23-May-16	14-Jun-16																																																																																																																																																																																																																																																																																																																																																																																																																																																																																																																																																																																																																																																																																																																																																																																																																																																																																																																																																																																																																																																																																																																																																																																																																																																																																																																								



Activity ID		Activity Name	Original Duration	Start	Finish
<div><div>PCB-02-21940</div><div>PCB - Service Trench Base Slab (GL4.2 to 5.2) H - 72m³ Pour BS27</div><div>8</div><div>15-Feb-16</div><div>23-Feb-16</div></div> <div><div>PCB-02-21950</div><div>PCB - Service Trench Base Slab (GL4.2 to 5.2) H - 134m³ Pour BS25</div><div>8</div><div>15-Apr-16</div><div>25-Apr-16</div></div> <div><div>Service Trough Walls</div><div></div><div>80</div><div>25-Jan-16</div><div>05-May-16</div></div> <div><div>PCB-02-22980</div><div>PCB - Basement Ext Walls to BS26</div><div>8</div><div>25-Jan-16</div><div>02-Feb-16</div></div> <div><div>PCB-02-23000</div><div>PCB - Basement Ext Walls to BS27</div><div>8</div><div>24-Feb-16</div><div>03-Mar-16</div></div> <div><div>PCB-02-22990</div><div>PCB - Basement Ext Walls to BS25</div><div>8</div><div>25-Apr-16</div><div>05-May-16</div></div> <div><div>Waterproofing Trench Walls</div><div></div><div>75</div><div>03-Feb-16</div><div>09-May-16</div></div> <div><div>PCB-02-24980</div><div>PCB - Waterproofing to BS26 Walls</div><div>3</div><div>03-Feb-16</div><div>05-Feb-16</div></div> <div><div>PCB-02-24960</div><div>PCB - Waterproofing to BS27 Walls</div><div>3</div><div>04-Mar-16</div><div>07-Mar-16</div></div> <div><div>PCB-02-24970</div><div>PCB - Waterproofing to BS25 Walls</div><div>3</div><div>05-May-16</div><div>09-May-16</div></div> <div><div>Backfilling behind Service Trough Walls</div><div></div><div>76</div><div>06-Feb-16</div><div>13-May-16</div></div> <div><div>PCB-02-23430</div><div>PCB - Backfilling to Ground Level at Basement Ext Walls BS26</div><div>4</div><div>06-Feb-16</div><div>17-Feb-16</div></div> <div><div>PCB-02-23440</div><div>PCB - Backfilling to Ground Level at Basement Ext Walls BS27</div><div>4</div><div>08-Mar-16</div><div>11-Mar-16</div></div> <div><div>PCB-02-23320</div><div>PCB - Backfilling to Ground Level at Basement Ext Walls BS25</div><div>4</div><div>09-May-16</div><div>13-May-16</div></div> <div><div>Excavate for Pile Caps and Beams</div><div></div><div>104</div><div>18-Feb-16</div><div>22-Jun-16</div></div> <div><div>PCB-02-24940</div><div>PCB - Excavate Pile caps and Beams GF03</div><div>5</div><div>18-Feb-16</div><div>23-Feb-16</div></div> <div><div>PCB-02-24950</div><div>PCB - Excavate Pile caps and Beams GF04</div><div>5</div><div>12-Mar-16</div><div>17-Mar-16</div></div> <div><div>PCB-02-24930</div><div>PCB - Excavate Pile caps and Beams GF01</div><div>5</div><div>10-May-16</div><div>17-May-16</div></div> <div><div>PCB-02-24900</div><div>PCB - Excavate Pile caps and Beams GF02</div><div>5</div><div>16-Jun-16</div><div>22-Jun-16</div></div> <div><div>Pile Cropping</div><div></div><div>107</div><div>20-Feb-16</div><div>28-Jun-16</div></div> <div><div>PCB-02-23550</div><div>Pile Cropping to GF03</div><div>8</div><div>20-Feb-16</div><div>29-Feb-16</div></div> <div><div>PCB-02-23580</div><div>Pile Cropping to GF04</div><div>8</div><div>15-Mar-16</div><div>23-Mar-16</div></div> <div><div>PCB-02-23490</div><div>Pile Cropping to GF01</div><div>8</div><div>12-May-16</div><div>23-May-16</div></div> <div><div>PCB-02-23520</div><div>Pile Cropping to GF02</div><div>8</div><div>18-Jun-16</div><div>28-Jun-16</div></div> <div><div>Pile Capping</div><div></div><div>109</div><div>23-Feb-16</div><div>04-Jul-16</div></div> <div><div>PCB-02-23560</div><div>Pile Caps and Tie Beams to GF03</div><div>10</div><div>23-Feb-16</div><div>04-Mar-16</div></div> <div><div>PCB-02-23590</div><div>Pile Caps and Tie Beams to GF04</div><div>10</div><div>17-Mar-16</div><div>28-Mar-16</div></div> <div><div>PCB-02-23500</div><div>Pile Caps and Tie Beams to GF01</div><div>10</div><div>16-May-16</div><div>27-May-16</div></div> <div><div>PCB-02-23530</div><div>Pile Caps and Tie Beams to GF02</div><div>10</div><div>21-Jun-16</div><div>04-Jul-16</div></div> <div><div>Water Proofing</div><div></div><div>99</div><div>05-Mar-16</div><div>04-Jul-16</div></div> <div><div>PCB-02-24790</div><div>Waterproofing Pile Caps and Tie Beams to GF03</div><div>4</div><div>05-Mar-16</div><div>09-Mar-16</div></div> <div><div>PCB-02-24800</div><div>Waterproofing Pile Caps and Tie Beams to GF04</div><div>4</div><div>24-Mar-16</div><div>28-Mar-16</div></div> <div><div>PCB-02-24770</div><div>Waterproofing Pile Caps and Tie Beams to GF01</div><div>4</div><div>23-May-16</div><div>27-May-16</div></div> <div><div>PCB-02-24780</div><div>Waterproofing Pile Caps and Tie Beams to GF02</div><div>4</div><div>28-Jun-16</div><div>04-Jul-16</div></div> <div><div>Backfilling to Top Level of Ground Beams (+5.0mPD Generally)</div><div></div><div>99</div><div>10-Mar-16</div><div>08-Jul-16</div></div> <div><div>PCB-02-23570</div><div>Backfilling to Tie Beams to GF03</div><div>4</div><div>10-Mar-16</div><div>14-Mar-16</div></div> <div><div>PCB-02-23600</div><div>Backfilling to Tie Beams to GF04</div><div>4</div><div>29-Mar-16</div><div>01-Apr-16</div></div> <div><div>PCB-02-23510</div><div>Backfilling to Tie Beams to GF01</div><div>4</div><div>27-May-16</div><div>01-Jun-16</div></div> <div><div>PCB-02-23540</div><div>Backfilling to Tie Beams to GF02</div><div>4</div><div>04-Jul-16</div><div>08-Jul-16</div></div> <div><div>Ground Slabs (+5.450mPD)</div><div></div><div>112</div><div>15-Mar-16</div><div>28-Jul-16</div></div> <div><div>PCB-02-21520</div><div>Construct Ground Floor Base Slab GS21 - 916m³</div><div>17</div><div>15-Mar-16</div><div>02-Apr-16</div></div> <div><div>PCB-02-21530</div><div>Construct Ground Floor Base Slab GS19 - 940m³</div><div>17</div><div>02-Apr-16</div><div>22-Apr-16</div></div> <div><div>PCB-02-21500</div><div>Construct Ground Floor Base Slab GS20 - 916m³</div><div>17</div><div>01-Jun-16</div><div>22-Jun-16</div></div> <div><div>PCB-02-21510</div><div>Construct Ground Floor Base Slab GS18 - 470m³</div><div>17</div><div>08-Jul-16</div><div>28-Jul-16</div></div> <div><div>Ground Floor Slabs (+5.450mPD)</div><div></div><div>113</div><div>23-Nov-15 A</div><div>04-May-16</div></div> <div><div>SOUTH - Gridline J-G</div><div></div><div>113</div><div>23-Nov-15 A</div><div>04-May-16</div></div> <div><div>PCB-AB-A0010</div><div>Earliest Commencement of ABWF/MEP in Basement SOUTH EAST</div><div>0</div><div>15-Jan-16</div><div></div></div> <div><div>Suspended Slabs (+5.450mPD)</div><div></div><div>113</div><div>23-Nov-15 A</div><div>04-May-16</div></div> <div><div>PCB-02-21560</div><div>Construct Ground Floor Suspended Slab Pour GS03 - 237m³</div><div>23</div><div>23-Nov-15 A</div><div>24-Dec-15</div></div> <div><div>PCB-02-21550</div><div>Construct Ground Floor Suspended Slab Pour GS02 - 182m³</div><div>23</div><div>11-Mar-16</div><div>08-Apr-16</div></div> <div><div>PCB-02-21540</div><div>Construct Ground Floor Suspended Slab Pour GS01 - 81m³</div><div>23</div><div>06-Apr-16</div><div>04-May-16</div></div> <div><div>Cure and Strip Suspended Slabs</div><div></div><div>15</div><div>28-Dec-15</div><div>14-Jan-16</div></div> <div><div>PCB-02-21570</div><div>Cure &amp; Strip Ground Floor Suspended Slab Pour GS03</div><div>15</div><div>28-Dec-15</div><div>14-Jan-16</div></div> <div><div>MIDDLE - Gridline G-E</div><div></div><div>86</div><div>30-Dec-15</div><div>16-Apr-16</div></div> <div><div>Suspended Slabs (+5.450mPD)</div><div></div><div>71</div><div>30-Dec-15</div><div>29-Mar-16</div></div> <div><div>PCB-02-25130</div><div>Construct Ground Floor Suspended Slab Pour GS07 - 186m³</div><div>23</div><div>30-Dec-15</div><div>26-Jan-16</div></div> <div><div>PCB-02-21430</div><div>Construct Ground Floor Suspended Slab Pour GS05 - 160m³</div><div>23</div><div>04-Jan-16</div><div>29-Jan-16</div></div> <div><div>PCB-02-21410</div><div>Construct Ground Floor Suspended Slab Pour GS12 - 215m³</div><div>23</div><div>27-Jan-16</div><div>29-Feb-16</div></div> <div><div>PCB-02-21390</div><div>Construct Ground Floor Suspended Slab Pour GS11 - 186m³</div><div>23</div><div>29-Jan-16</div><div>02-Mar-16</div></div> <div><div>PCB-02-21400</div><div>Construct Ground Floor Suspended Slab Pour GS10 - 200m³</div><div>23</div><div>02-Mar-16</div><div>28-Mar-16</div></div> <div><div>PCB-02-21420</div><div>Construct Ground Floor Suspended Slab Pour GS13 - 184m³</div><div>23</div><div>03-Mar-16</div><div>29-Mar-16</div></div> <div><div>Cure and Strip Suspended Slabs</div><div></div><div>63</div><div>27-Jan-16</div><div>16-Apr-16</div></div> <div><div>PCB-02-32630</div><div>Cure &amp; Strip Ground Floor Suspended Slab Pour GS05</div><div>15</div><div>27-Jan-16</div><div>19-Feb-16</div></div> <div><div>PCB-02-32640</div><div>Cure &amp; Strip Ground Floor Suspended Slab Pour GS07</div><div>15</div><div>30-Jan-16</div></div>					

[illegible]







Activity ID	Activity Name	Original Duration	Start	Finish	3MRP - Progress to 30-Nov-15																												Date		Revision		Checked		Approved																																																																																																																																																																																																																																																																																																																																																																																																																																																																																																																																																																																																																																																																																																																																																																																																																																																																																																																																																																																																																																																																																																																																																																																																																																																																																																																																																																	
PCB-XX-1170	Complete Pile Caps to Bay 13	3	27-Nov-15 A	01-Dec-15*	<div></div>																																																																																																																																																																																																																																																																																																																																																																																																																																																																																																																																																																																																																																																																																																																																																																																																																																																																																																																																																																																																																																																																																																																																																																																																																																																																																																																																																																																																			







路政署  
**HIGHWAYS DEPARTMENT**

港珠澳大橋香港工程管理處  
Hong Kong - Zhuhai - Macao Bridge  
Hong Kong Project Management Office

Contract No. HY/2013/01

Hong Kong-Zhuhai-Macao Bridge

Hong Kong Boundary Crossing Facilities – Passenger Clearance Building

14<sup>th</sup> Monthly EM&A Report

---

## APPENDIX D

---

Event and Action Plan

## Event/Action Plan for Air Quality

EVENT	ACTION			
	ET	IEC	ER	CONTRACTOR
<b>ACTION LEVEL</b>				
1. Exceedance for one sample	<ol style="list-style-type: none"> <li>1. Identify source, investigate the causes of exceedance and propose remedial measures;</li> <li>2. Inform IEC and ER;</li> <li>3. Repeat measurement to confirm finding;</li> <li>4. Increase monitoring frequency to daily.</li> </ol>	<ol style="list-style-type: none"> <li>1. Check monitoring data submitted by ET;</li> <li>2. Check Contractor's working method.</li> </ol>	<ol style="list-style-type: none"> <li>1. Notify Contractor.</li> </ol>	<ol style="list-style-type: none"> <li>1. Rectify any unacceptable practice;</li> <li>2. Amend working methods if appropriate.</li> </ol>
2. Exceedance for two or more consecutive samples	<ol style="list-style-type: none"> <li>1. Identify source;</li> <li>2. Inform IEC and ER;</li> <li>3. Advise the ER on the effectiveness of the proposed remedial measures;</li> <li>4. Repeat measurements to confirm findings;</li> <li>5. Increase monitoring frequency to daily;</li> <li>6. Discuss with IEC and Contractor on remedial actions required;</li> <li>7. If exceedance continues, arrange meeting with IEC and ER;</li> <li>8. If exceedance stops, cease additional monitoring.</li> </ol>	<ol style="list-style-type: none"> <li>1. Check monitoring data submitted by ET;</li> <li>2. Check Contractor's working method;</li> <li>3. Discuss with ET and Contractor on possible remedial measures;</li> <li>4. Advise the ER on the effectiveness of the proposed remedial measures;</li> <li>5. Supervise Implementation of remedial measures.</li> </ol>	<ol style="list-style-type: none"> <li>1. Confirm receipt of notification of failure in writing;</li> <li>2. Notify Contractor;</li> <li>3. Ensure remedial measures properly implemented.</li> </ol>	<ol style="list-style-type: none"> <li>1. Submit proposals for remedial to ER within 3 working days of notification;</li> <li>2. Implement the agreed proposals;</li> <li>3. Amend proposal if appropriate.</li> </ol>

EVENT	ACTION			
	ET	IEC	ER	CONTRACTOR
<b>LIMIT LEVEL</b>				
1. Exceedance for one sample	1. Identify source, investigate the causes of exceedance and propose remedial measures; 2. Inform ER, Contractor and EPD; 3. Repeat measurement to confirm finding; 4. Increase monitoring frequency to daily; 5. Assess effectiveness of Contractor's remedial actions and keep IEC, EPD and ER informed of the results.	1. Check monitoring data submitted by ET; 2. Check Contractor's working method; 3. Discuss with ET and Contractor on possible remedial measures; 4. Advise the ER on the effectiveness of the proposed remedial measures; 5. Supervise implementation of remedial measures.	1. Confirm receipt of notification of failure in writing; 2. Notify Contractor; 3. Ensure remedial measures properly implemented.	1. Take immediate action to avoid further exceedance; 2. Submit proposals for remedial actions to IEC within 3 working days of notification; 3. Implement the agreed proposals; 4. Amend proposal if appropriate.
2. Exceedance for two or more consecutive samples	1. Notify IEC, ER, Contractor and EPD; 2. Identify source; 3. Repeat measurement to confirm findings; 4. Increase monitoring frequency to daily; 5. Carry out analysis of Contractor's working procedures to determine possible mitigation to be implemented; 6. Arrange meeting with IEC and ER to discuss the remedial actions to be taken; 7. Assess effectiveness of Contractor's remedial actions and keep IEC, EPD and ER informed of the results; 8. If exceedance stops, cease additional monitoring.	1. Discuss amongst ER, ET, and Contractor on the potential remedial actions; 2. Review Contractor's remedial actions whenever necessary to assure their effectiveness and advise the ER accordingly; 3. Supervise the implementation of remedial measures.	1. Confirm receipt of notification of failure in writing; 2. Notify Contractor; 3. In consultation with the IEC, agree with the Contractor on the remedial measures to be implemented; 4. Ensure remedial measures properly implemented; 5. If exceedance continues, consider what portion of the work is responsible and instruct the Contractor to stop that portion of work until the exceedance is abated.	1. Take immediate action to avoid further exceedance; 2. Submit proposals for remedial actions to IEC within 3 working days of notification; 3. Implement the agreed proposals; 4. Resubmit proposals if problem still not under control; 5. Stop the relevant portion of works as determined by the ER until the exceedance is abated.

## Event / Action Plan for Construction Noise Monitoring

EVENT	ACTION			
	ET	IEC	ER	CONTRACTOR
Action Level	<ol style="list-style-type: none"> <li>1. Notify IEC and Contractor;</li> <li>2. Identify source, investigate the causes of exceedance and propose remedial measures;</li> <li>3. Report the results of investigation to the IEC, ER and Contractor;</li> <li>4. Discuss with the Contractor and formulate remedial measures;</li> <li>5 Increase monitoring frequency to check mitigation effectiveness.</li> </ol>	<ol style="list-style-type: none"> <li>1. Review the analysed results submitted by the ET;</li> <li>2. Review the proposed remedial measures by the Contractor and advise the ER accordingly;</li> <li>3. Supervise the implementation of remedial measures.</li> </ol>	<ol style="list-style-type: none"> <li>1. Confirm receipt of notification of failure in writing;</li> <li>2. Notify Contractor;</li> <li>3. Require Contractor to propose remedial measures for the analysed noise problem;</li> <li>4. Ensure remedial measures are properly implemented.</li> </ol>	<ol style="list-style-type: none"> <li>1. Submit noise mitigation proposals to IEC;</li> <li>2. Implement noise mitigation proposals.</li> </ol>
Limit Level	<ol style="list-style-type: none"> <li>1. Inform IEC, ER, EPD and Contractor;</li> <li>2. Identify source;</li> <li>3. Repeat measurements to confirm findings;</li> <li>4. Increase monitoring frequency;</li> <li>5. Carry out analysis of Contractor's working procedures to determine possible mitigation to be implemented;</li> <li>6. Inform IEC, ER and EPD the causes and actions taken for the exceedances;</li> <li>7. Assess effectiveness of Contractor's remedial actions and keep IEC, EPD and ER informed of the results;</li> <li>8. If exceedance stops, cease additional monitoring.</li> </ol>	<ol style="list-style-type: none"> <li>1. Discuss amongst ER, ET, and Contractor on the potential remedial actions;</li> <li>2. Review Contractors remedial actions whenever necessary to assure their effectiveness and advise the ER accordingly;</li> <li>3. Supervise the implementation of remedial measures.</li> </ol>	<ol style="list-style-type: none"> <li>1. Confirm receipt of notification of failure in writing;</li> <li>2. Notify Contractor;</li> <li>3. Require Contractor to propose remedial measures for the analysed noise problem;</li> <li>4. Ensure remedial measures properly implemented;</li> <li>5. If exceedance continues, consider what portion of the work is responsible and instruct the Contractor to stop that portion of work until the exceedance is abated.</li> </ol>	<ol style="list-style-type: none"> <li>1. Take immediate action to avoid further exceedance;</li> <li>2. Submit proposals for remedial actions to IEC within 3 working days of notification;</li> <li>3. Implement the agreed proposals;</li> <li>4. Resubmit proposals if problem still not under control;</li> <li>5. Stop the relevant portion of works as determined by the ER until the exceedance is abated.</li> </ol>



## APPENDIX E

---

### Waste Flow Table

Name of Department: Highways Department

Contract No.: HY/2013/01

Monthly Summary Waste Flow Table for 2015



Month	Actual Quantities of Inert C&D Materials Generated Monthly						Actual Quantities of C&D Wastes Generated Monthly				
	a.Total Quantity Generated (see Note 8)	b. Hard Rock and Large Broken Concrete (see Note 9)	c. Reused in the Contract	d. Reused in Other Projects (see Note 12)	e. Disposed as Public Fill (see Note 10)	f. Imported Fill	g. Metals (see Note 5)	h. Paper / Cardboard Packaging (see Note 5)	i. Plastics (see Note 3) (see Note 5)	j. Chemical Waste	k. Others, e.g. general refuse
	(in '000m <sup>3</sup> )	(in '000m <sup>3</sup> )	(in '000m <sup>3</sup> )	(in '000m <sup>3</sup> )	(in '000m <sup>3</sup> )	(in '000m <sup>3</sup> )	(in '000kg)	(in '000kg)	(in '000kg)	(in '000kg)	(in '000m <sup>3</sup> )
January	24.799	0.000	0.000	12.018	12.781	0.000	29.910	0.314	0.000	1.440	0.044
February	12.073	0.000	0.000	5.159	6.914	0.000	20.850	0.473	0.003	0.000	0.022
March	15.990	0.000	0.000	4.489	11.501	0.000	90.810	0.673	0.000	2.400	0.047
April	7.596	0.000	0.000	1.606	5.990	0.000	79.070	0.669	0.000	0.000	0.066
May	14.012	0.000	3.608	6.521	3.883	0.000	8.630	0.000	0.000	2.560	0.048
June	58.988	0.000	0.010	56.981	1.997	0.000	154.600	0.586	0.000	0.000	0.057
Sub-total	133.458	0.000	3.618	86.774	43.066	0.000	383.870	2.715	0.003	6.400	0.284
July	28.566	0.000	0.000	27.504	1.062	0.000	49.660	0.912	0.000	0.000	0.044
August	40.872	2.038	0.000	37.956	2.916	0.000	58.210	0.840	0.000	1.120	0.103
September <sup>(11)</sup>	72.653	2.109	0.000	70.353	2.300	0.000	78.240	1.764	0.000	0.000	0.074
October	57.852	1.492	0.000	56.196	1.656	0.000	67.420	0.000	0.000	0.000	0.114
November	21.599	1.106	0.000	20.493	1.106	0.000	78.570	0.906	0.000	0.000	0.266
December											
Total	355.000	6.745	3.618	299.276	52.106	0.000	715.970	7.137	0.003	7.520	0.885

Total C&D waste generated = a+b+f+g+h+i+j+k

Total C&D waste generated (excluded excavated material) = g+h+i+j+k

Total C&D waste recycled = c+d+g+h+i

% of recycled C&D waste = (Total C&D waste generated - Total C&D waste recycled) / Total C&D waste generated

- Notes: (1) The performance target are given in PS Clause 6(14).
- (2) The waste flow table shall also include C&D materials that are not specified in the Contract to be imported for use at the Site.
- (3) Plastics refer to plastic bottles/containers, plastic sheets/foam from packaging material.
- (4) The Contractor shall also submit the latest forecast of the amount of C&D materials expected to be generated from the Works, together with a break down of the nature where the total amount of C&D materials expected to be generated from the Works is equal to or exceeding 50,000m<sup>3</sup>.
- (5) All recyclable materials, including metals, paper / cardboard packaging, plastics, etc. will be collected by registered collector for recycling.
- (6) Conversion factors for reporting purpose:  
in-situ: rock = 2.5 tonnes/m<sup>3</sup>; soil = 2.0 tonnes/m<sup>3</sup>  
excavated: rock = 2.0 tonnes/m<sup>3</sup>; soil = 1.8 tonnes/m<sup>3</sup>; broken concrete and bitumen = 2.4 tonnes/m<sup>3</sup>  
C&D Waste = 0.9 tonnes/m<sup>3</sup>; bentonite slurry = 2.8 tonnes/m<sup>3</sup>  
Diesel density: 0.8kg/l
- (7) Numbers are rounded off to the nearest three decimal places.
- (8) The "Total Quantity Generated" equals to the sum of "Reuse in the Contract", "Reuse in Other Projects" and "Disposed as Public Fill".
- (9) The "Hard Rock and Large Broken Concrete" were disposed as public fill.
- (10) The amount in "Disposed as Public Fill" included the "Hard Rock and Large Broken Concrete" disposed as public fill.
- (11) The actual quantity of Metals (Item g) and Paper/Cardboard Packaging (Item h) generated from the Contractor in September 2015 have been updated according to the latest information provided by the Contractor in October 2015.
- (12) The item d "Reused in Other Project" includes the quantities of treated excavated sediment, sand, etc. Other project refers to Contract No. HY/2010/02.



### Monthly Summary of Marine Sediment for 2015

Month	a. Estimated Volume of Marine Sediment Generated (m <sup>3</sup> )	b. Estimated Volume of Accumulated Treated Marine Sediment (m <sup>3</sup> )	c. Reused in the Contract (m <sup>3</sup> )	d. Estimated Volume of Reused Marine Sediment in Other Project (m <sup>3</sup> ) <sup>(2)</sup>	e. Estimated Volume of Treated Marine Sediment Stored on Site (Unused) (m <sup>3</sup> )
Jan 2015	5,516	11,970	0	11,970	0
Feb 2015	3,227	5,159	0	5,159	0
Mar 2015	3,402	4,489	0	4,489	0
Apr 2015	2,716	1,606	0	1,606	0
May 2015	1,120	3,496	0	3,496	0
June 2015	539	2,841	0	1,641	1,200
July 2015	0	0	0	0	1,200
Aug 2015	0	0	0	0	1,200
Sept 2015	0	0	0	0	1,200
Oct 2015	50	55	0	0	1,255
Nov 2015	0	0	0	0	1,255
<b>Total</b>	<b>16,570</b>	<b>29,616</b>	<b>0</b>	<b>28,361</b>	<b>1255</b> <sup>(1)</sup>

Note: (1) It presents the quantity of unused treated marine sediment stored on site during the reporting month.

(2) Other project refers to Contract No. HY/2010/02.



路政署  
**HIGHWAYS DEPARTMENT**

港珠澳大橋香港工程管理處  
Hong Kong - Zhuhai - Macao Bridge  
Hong Kong Project Management Office

Contract No. HY/2013/01

Hong Kong-Zhuhai-Macao Bridge

Hong Kong Boundary Crossing Facilities – Passenger Clearance Building

14<sup>th</sup> Monthly EM&A Report

## APPENDIX F

### Environmental Licenses and Permits

## Environmental License/ Permits /Notification Register

LCAL H2620

## Contract HY/2013/01 – Hong Kong Zhuhai and Macao Bridge Boundary Crossing Facilities - Passenger Clearance Building

Item No.	Permit/License or Registration Application			Permit/License/ Notification/ Registration Description	Permit/License/ Registration Number	Issue/Start Date	Expiry Date	Issuing Office	Remark
	Work Area	Date	Reference						
1	All Areas	29 Jul 13	N/A	Environmental Permit to construct the Passenger Clearance Building and associated works of the Hong Kong Zhuhai and Macao Bridge Boundary Crossing Facilities	EP-353/2009/G	06 Aug 13	N/A	EPD	Superseded by EP-353/2009/H
2	All Areas	16 Jan 15	N/A	Environmental Permit to construct the Passenger Clearance Building and associated works of the Hong Kong Zhuhai and Macao Bridge Boundary Crossing Facilities	EP-353/2009/H	19 Jan 15	N/A	EPD	Superseded by EP-353/2009/I
3	All Areas	30 Jun 15	N/A	Environmental Permit to construct the Passenger Clearance Building and associated works of the Hong Kong Zhuhai and Macao Bridge Boundary Crossing Facilities	EP-353/2009/I	17 Jul 15	N/A	EPD	
4	All Areas	29 Apr 14	H2620-LTR-EPD-AU-000006	<b>Billing Account</b> for disposal of construction waste	Billing Account No.: 7019944	16 May 14	N/A	EPD	
5	PCB	30 Apr 14	H2620-LTR- EPD-000002	<b>Notification</b> that notifiable works are anticipated to commence (Form NA).	Acknowledge Receipt Ref. No. 373961	05 May 14	N/A	EPD	

## Environmental License/ Permits /Notification Register

LCAL H2620

## Contract HY/2013/01 – Hong Kong Zhuhai and Macao Bridge Boundary Crossing Facilities - Passenger Clearance Building

Date : October 2015									
Item No.	Permit/License or Registration Application			Permit/License/ Notification/ Registration Description	Permit/License/ Registration Number	Issue/Start Date	Expiry Date	Issuing Office	Remark
	Work Area	Date	Reference						
6	WA2	30 Apr 14	H2620-LTR- EPD-000003	<b>Notification</b> that notifiable works are anticipated to commence (Form NA).	Acknowledge Receipt Ref. No. 373956	05 May 14	N/A	EPD	
7	WA3	30 Apr 14	H2620-LTR-EPD-AU-000001	<b>Notification</b> that notifiable works are anticipated to commence (Form NA).	Acknowledge Receipt Ref. No. 373962	05 May 14	N/A	EPD	
8	PCB	30 May 14	H2620-LTR-EPD-AU-000020	<b>Registration</b> as Chemical Waste Producer for disposal of spent batteries, used lubrication oil and surplus paint at PCB area	WPN: 5213-951-L2846-01	08 Jul 14	N/A	EPD	
9	PCB	23 Jun 14	In H2620-LTR-EPD-000017	<b>CNP</b> for the use of powered mechanical equipment for the purpose of carry out pre-drill and bore piling works from 19:00 to 23:00 and 23:00 to 07:00. (Non-designated area)	GW-RS0683-14	03 Jul 14	29 Dec 14	EPD	Superseded by GW-RS0908-14

## Environmental License/ Permits /Notification Register

LCAL H2620

## Contract HY/2013/01 – Hong Kong Zhuhai and Macao Bridge Boundary Crossing Facilities - Passenger Clearance Building

Date : October 2015									Remark
Item No.	Permit/License or Registration Application			Permit/License/ Notification/ Registration Description	Permit/License/ Registration Number	Issue/Start Date	Expiry Date	Issuing Office	
	Work Area	Date	Reference						
10	WA2	02 Jul 14	H2620-LTR-LCJ-AU-000280	<b>CNP</b> for the use of powered mechanical equipment for the purpose of carry out ER Office construction works from 19:00 to 23:00. (Non-designated area)	GW-RS0715-14	17 Jul 14	15 Jan 15	EPD	Superseded by GW-RS1034-14
11	WA3	02 Jul 14	H2620-LTR-LCJ-AU-000324	<b>CNP</b> for the use of powered mechanical equipment for the purpose of carry out construction of JV site office from 19:00 to 23:00. (Non-designated)	GW-RS0716-14	17 Jul 14	15 Jan 15	EPD	Expired
12	PCB	23 Jun 14	H2620-LTR- EPD-000527	<b>CNP</b> for the use of powered mechanical equipment for the purpose of carry out pre-drill and bore piling works from 19:00 to 23:00 and 23:00 to 07:00. (Non-designated area)	GW-RS0908-14	03 Sep 14	22 Dec 14	EPD	Superseded by GW-RS1044-14
13	PCB	29 Sep 14	H2620-LTR-EPD-AU-000034	<b>CNP</b> for the use of powered mechanical equipment for the purpose of carry out pre-drill and bore piling works from 19:00 to 23:00 and 23:00 to 07:00. (Non-designated area)	GW-RS1044-14	29 Sep 14	24 Dec 14	EPD	Superseded by GW-RS1300-14

## Environmental License/ Permits /Notification Register

LCAL H2620

## Contract HY/2013/01 – Hong Kong Zhuhai and Macao Bridge Boundary Crossing Facilities - Passenger Clearance Building

Item No.	Permit/License or Registration Application			Permit/License/ Notification/ Registration Description	Permit/License/ Registration Number	Issue/Start Date	Expiry Date	Issuing Office	Remark
	Work Area	Date	Reference						
14	WA2	12 Sep 14	H2620-LTR-EPD-AU-000032	<b>CNP</b> for the use of powered mechanical equipment for the purpose of carry out ER Office construction works from 19:00 to 23:00. (Non-designated area)	GW-RS1034-14	29 Sep 14	28 Mar 15	EPD	Expired
15	WA4	17 Oct 14	H2620-LTR-EPD-AU-000036	<b>CNP</b> for the use of powered mechanical equipment from 19:00 to 23:00. (Non-designated area)	GW-RW0814-14	20 Oct 14	19 Apr 15	EPD	Expired and replaced by GW-RW0171-15
16	PCB	03 Nov 14	H2620-LTR-EPD-AU-000040	<b>CNP</b> for the use of powered mechanical equipment for the purpose of carry out pre-drill and bore piling works from 19:00 to 23:00 and 23:00 to 07:00. (Non-designated area)	GW-RS1300-14	17 Nov 14	16 Feb 15	EPD	Superseded by GW-RS0087-15
17	PCB	12 Jan 15	H2620-LTR-EPD-AU-000046	<b>CNP</b> for the use of powered mechanical equipment for the purpose of carry out pre-drill and bore piling works from 19:00 to 23:00 and 23:00 to 07:00. (Non-designated area)	GW-RS0087-15	26 Jan 15	25 Apr 15	EPD	Superseded by GW-RS0308-15

## Environmental License/ Permits /Notification Register

LCAL H2620

## Contract HY/2013/01 – Hong Kong Zhuhai and Macao Bridge Boundary Crossing Facilities - Passenger Clearance Building

Item No.	Permit/License or Registration Application			Permit/License/ Notification/ Registration Description	Permit/License/ Registration Number	Issue/Start Date	Expiry Date	Issuing Office	Remark
	Work Area	Date	Reference						
18	PCB	12 Mar 15	H2620-LTR-EPD-AU-000051	<b>CNP</b> for the use of powered mechanical equipment for the purpose of carry out pre-drill and bore piling works from 19:00 to 23:00 and 23:00 to 07:00. (Non-designated area)	GW-RS0308-15	26 Mar 15	25 Jun 15	EPD	Superseded by GW-RS0476-15
19	PCB	31 Jul 14	H2620-LTR-EPD-AU-000038	<b>Water Discharge License</b> for construction works on PCB island	WT00020335-2014	13 Nov 14	30 Nov 19	EPD	
20	WA4	27 Mar 15	H2620-LTR-EPD-AU-000054	<b>CNP</b> for the use of powered mechanical equipment from 19:00 to 23:00. (Non-designated area)	GW-RW0171-15	20 Apr 15	19 Oct 15	EPD	Superseded by GW-RW0351-15
21	PCB	15 Apr 15	H2620-LTR-EPD-AU-000057	<b>CNP</b> for the use of powered mechanical equipment for the purpose of carry out pre-drill and bore piling works from 19:00 to 23:00 and 23:00 to 07:00. (Non-designated area)	GW-RS0476-15	01 May 15	31 Jul 15	EPD	Superseded by GW-RS0685-15

## Environmental License/ Permits /Notification Register

LCAL H2620

## Contract HY/2013/01 – Hong Kong Zhuhai and Macao Bridge Boundary Crossing Facilities - Passenger Clearance Building

Date : October 2015									Remark
Item No.	Permit/License or Registration Application			Permit/License/ Notification/ Registration Description	Permit/License/ Registration Number	Issue/Start Date	Expiry Date	Issuing Office	
	Work Area	Date	Reference						
22	PCB	09 Jun 15	H2620-LTR-EPD-AU-000063	<b>CNP</b> for the use of powered mechanical equipment for the purpose of carry out pre-drill and bore piling works from 19:00 to 23:00 and 23:00 to 07:00. (Non-designated area)	GW-RS0685-15	01 Jul 15	30 Sep 15	EPD	Superseded by GW-RS0877-15
23	WA4	29 Jun 15	H2620-LTR-EPD-AU-000066	<b>CNP</b> for the use of powered mechanical equipment from 19:00 to 23:00. (Non-designated area)	GW-RW0351-15	17 Jul 15	12 Jan 16	EPD	
24	PCB	27 Jul 15	H2620-LTR-EPD-AU-000069	<b>CNP</b> for the use of powered mechanical equipment for the purpose of carry out pre-drill and bore piling works from 19:00 to 23:00 and 23:00 to 07:00. (Non-designated area)	GW-RS0877-15	10 Aug 15	09 Nov 15	EPD	Superseded by GW-RS1016-15
25	PCB	02 Sep 15	H2620-LTR-EPD-AU-000072	<b>CNP</b> for the use of powered mechanical equipment for the purpose of carry out pre-drill and bore piling works from 19:00 to 23:00 and 23:00 to 07:00. (Non-designated area)	GW-RS1016-15	18 Sep 15	17 Dec 15	EPD	



**Environmental License/ Permits /Notification Register**
**LCAL H2620**
**Contract HY/2013/01 – Hong Kong Zhuhai and Macao Bridge Boundary Crossing Facilities - Passenger Clearance Building**

Date : October 2015									Remark
Item No.	Permit/License or Registration Application			Permit/License/ Notification/ Registration Description	Permit/License/ Registration Number	Issue/Start Date	Expiry Date	Issuing Office	
	Work Area	Date	Reference						
26	PCB	22 Oct 15	H2620-LTR-EPD-AU-000075	<b>CNP</b> for the use of powered mechanical equipment for the purpose of carry out works from 19:00 to 23:00 and 23:00 to 07:00. (Non-designated area)	GW-RS1195-15	9 Nov 15	8 Feb 16	EPD	



## APPENDIX G

---

### Implementation Schedule for Environmental Mitigation Measures (EMIS)

Contract No. HY/2013/01 – Hong Kong Zhuhai and Macao Bridge Hong Kong Boundary Crossing Facilities – Passenger Clearance Building

Implementation Schedule for Environmental Mitigation Measures

EIA Ref.	EM&A Log Ref	Recommended Mitigation Measures	Objectives of the Recommended Measures & Main Concerns to address	Who to implement the measures?	Location of the measures	When to implement the measures?	What requirements or standards for the measures to achieve?	Implementation Status
<b>Air Quality</b>								
S5.5.6.1	A1	1) The contractor shall follow the procedures and requirements given in the Air Pollution Control (Construction Dust) Regulation	Good construction site practices to control the dust impact at the nearby sensitive receivers to within the relevant criteria.	Contractor	All construction sites	Construction stage	To control the dust impact to within the HKAQO and TM-EIA criteria (Ref. 1- hr and 24hr TSP levels are $500 \mu\text{gm}^{-3}$ and $260 \mu\text{gm}^{-3}$ , respectively)	√
S5.5.6.2	A2	2) Proper watering of exposed spoil should be undertaken throughout the construction phase: <ul style="list-style-type: none"> <li>Any excavated or stockpile of dusty material should be covered entirely by impervious sheeting or sprayed with water to maintain the entire surface wet and then removed or backfilled or reinstated where practicable within 24 hours of the excavation or unloading;</li> <li>Any dusty materials remaining after a stockpile is removed should be wetted with water and cleared from the surface of roads;</li> <li>A stockpile of dusty material should not be extend beyond the pedestrian barriers, fencing or traffic cones.</li> <li>The load of dusty materials on a vehicle leaving a construction site should be covered entirely by impervious sheeting to ensure that the dusty materials do not leak from the vehicle;</li> <li>Where practicable, vehicle washing facilities with high pressure water jet should be provided at every discernible or designated vehicle exit point. The area where vehicle washing takes place and the road section between the washing facilities and the exit point should be paved with concrete, bituminous materials or hardcores;</li> </ul>	Good construction site practices to control the dust impact at the nearby sensitive receivers to within the relevant criteria.	Contractor	All construction sites	Construction stage	To control the dust impact to within the HKAQO and TM-EIA criteria (Ref. 1- hr and 24hr TSP levels are $500 \mu\text{gm}^{-3}$ and $260 \mu\text{gm}^{-3}$ , respectively)	√

EIA Ref.	EM&A Log Ref	Recommended Mitigation Measures	Objectives of the Recommended Measures & Main Concerns to address	Who to implement the measures?	Location of the measures	When to implement the measures?	What requirements or standards for the measures to achieve?	Implementation Status
S5.5.6.2	A2	<ul style="list-style-type: none"> <li>When there are open excavation and reinstatement works, hoarding of not less than 2.4m high should be provided as far as practicable along the site boundary with provision for public crossing. Good site practice shall also be adopted by the Contractor to ensure the conditions of the hoardings are properly maintained throughout the construction period;</li> <li>The portion of any road leading only to construction site that is within 30m of a vehicle entrance or exit should be kept clear of dusty materials;</li> <li>Surfaces where any pneumatic or power-driven drilling, cutting, polishing or other mechanical breaking operation takes place should be sprayed with water or a dust suppression chemical continuously;</li> <li>Any area that involves demolition activities should be sprayed with water or a dust suppression chemical immediately prior to, during and immediately after the activities so as to maintain the entire surface wet;</li> <li>Where a scaffolding is erected around the perimeter of a building under construction, effective dust screens, sheeting or netting should be provided to enclose the scaffolding from the ground floor level of the building, or a canopy should be provided from the first floor level up to the highest level of the scaffolding;</li> <li>Any skip hoist for material transport should be totally enclosed by impervious sheeting;</li> <li>Every stock of more than 20 bags of cement or dry pulverised fuel ash (PFA) should be covered entirely by impervious sheeting or placed in an area sheltered on the top and the 3 sides;</li> </ul>	Good construction site practices to control the dust impact at the nearby sensitive receivers to within the relevant criteria.	Contractor	All construction sites	Construction stage	To control the dust impact to within the HKAQO and TM-EIA criteria (Ref. 1- hr and 24hr TSP levels are $500 \mu\text{g m}^{-3}$ and $260 \mu\text{g m}^{-3}$ , respectively)	√

EIA Ref.	EM&A Log Ref	Recommended Mitigation Measures	Objectives of the Recommended Measures & Main Concerns to address	Who to implement the measures?	Location of the measures	When to implement the measures?	What requirements or standards for the measures to achieve?	Implementation Status
S5.5.6.2	A2	<ul style="list-style-type: none"> <li>Cement or dry PFA delivered in bulk should be stored in a closed silo fitted with an audible high level alarm which is interlocked with the material filling line and no overfilling is allowed;</li> <li>Loading, unloading, transfer, handling or storage of bulk cement or dry PFA should be carried out in a totally enclosed system or facility, and any vent or exhaust should be fitted with an effective fabric filter or equivalent air pollution control system; and</li> <li>Exposed earth should be properly treated by compaction, turfing, hydroseeding, vegetation planting or sealing with latex, vinyl, bitumen, shotcrete or other suitable surface stabiliser within six months after the last construction activity on the construction site or part of the construction site where the exposed earth lies.</li> </ul>	Good construction site practices to control the dust impact at the nearby sensitive receivers to within the relevant criteria.	Contractor	All construction sites	Construction stage	To control the dust impact to within the HKAQO and TM-EIA criteria (Ref. 1- hr and 24hr TSP levels are 500 $\mu\text{g}\text{m}^{-3}$ and 260 $\mu\text{g}\text{m}^{-3}$ , respectively)	√
S5.5.6.4	A3	The Contractor should undertake proper watering on all exposed spoil (with at least 8 times per day) throughout the construction phase.	Control construction dust	Contractor	All construction sites	Construction stage	To control the dust impact	√
S5.5.6.5	A4	Engineer to incorporate the controlled measures into the Particular Specification (PS) for the civil work. The PS should also draw the contractor's attention to the relevant latest Practice Notes issued by EPD.	Control construction dust	Engineer	All construction sites	Design Stage	Air Pollution Control (Construction Dust) Regulation	√
S5.5.6.5	A5	Implement regular dust monitoring under EM&A programme during the construction stage.	Monitor the 24 hr and 1hr TSP levels at the representative dust monitoring stations to ensure compliance with relevant criteria throughout the construction period.	Contractor	Selected representative dust monitoring station	Construction stage	<ul style="list-style-type: none"> <li>Air Pollution Control (Construction Dust) Regulation</li> <li>To control the dust impact to within the HKAQO and TM-EIA criteria (Ref. 1- hr and 24hr TSP levels are 500 <math>\mu\text{g}\text{m}^{-3}</math> and 260 <math>\mu\text{g}\text{m}^{-3}</math>, respectively)</li> </ul>	√ (The dust monitoring works under EM&A programme for the Contract are covered by Contract No. HY/2010/02 and Contract No. HY/2011/03.)

EIA Ref.	EM&A Log Ref	Recommended Mitigation Measures	Objectives of the Recommended Measures & Main Concerns to address	Who to implement the measures?	Location of the measures	When to implement the measures?	What requirements or standards for the measures to achieve?	Implementation Status
S5.5.7.1	A6	<p>The following mitigation measures should be adopted to prevent fugitive dust emissions for concrete batching plant:</p> <ul style="list-style-type: none"> <li>• Loading, unloading, handling, transfer or storage of any dusty materials should be carried out in totally enclosed system;</li> <li>• All dust-laden air or waste gas generated by the process operations should be properly extracted and vented to fabric filtering system to meet the emission limits for TSP;</li> <li>• Vents for all silos and cement/pulverised fuel ash (PFA) weighing scale should be fitted with fabric filtering system;</li> <li>• The materials which may generate airborne dusty emissions should be wetted by water spray system;</li> <li>• All receiving hoppers should be enclosed on three sides up to 3m above unloading point;</li> <li>• All conveyor transfer points should be totally enclosed;</li> <li>• All access and route roads within the premises should be paved and wetted; and</li> <li>• Vehicle cleaning facilities should be provided and used by all concrete trucks before leaving the premises to wash off any dust on the wheels and/or body.</li> </ul>	Monitor the 24 hr and 1hr TSP levels at the representative dust monitoring stations to ensure compliance with relevant criteria throughout the construction period.	Contractor	Selected representative dust monitoring station	Construction stage	<ul style="list-style-type: none"> <li>• Air Pollution Control (Construction Dust) Regulation</li> <li>• To control the dust impact to within the HKAQO and TM-EIA criteria (Ref. 1- hr and 24hr TSP levels are <math>500 \mu\text{g m}^{-3}</math> and <math>260 \mu\text{g m}^{-3}</math>, respectively)</li> </ul>	N/A
S5.5.2.7	A7	<p>The following mitigation measures should be adopted to prevent fugitive dust emissions at barging point:</p> <ul style="list-style-type: none"> <li>• All road surface within the barging facilities will be paved;</li> <li>• Dust enclosures will be provided for the loading ramp;</li> <li>• Vehicles will be required to pass through designated wheels wash facilities; and</li> <li>• Continuous water spray at the loading points.</li> </ul>	Control construction dust	Contractor	All construction sites	Construction stage	Air Pollution Control (Construction Dust) Regulation	N/A

EIA Ref.	EM&A Log Ref	Recommended Mitigation Measures	Objectives of the Recommended Measures & Main Concerns to address	Who to implement the measures?	Location of the measures	When to implement the measures?	What requirements or standards for the measures to achieve?	Implementation Status
<b>Construction Noise (Air borne)</b>								
S6.4.10	N1	<p>1) Use of good site practices to limit noise emissions by considering the following:</p> <ul style="list-style-type: none"> <li>only well-maintained plant should be operated on-site and plant should be serviced regularly during the construction programme;</li> <li>machines and plant (such as trucks, cranes) that may be in intermittent use should be shut down between work periods or should be throttled down to a minimum;</li> <li>plant known to emit noise strongly in one direction, where possible, be orientated so that the noise is directed away from nearby NSRs;</li> <li>silencers or mufflers on construction equipment should be properly fitted and maintained during the construction works;</li> <li>mobile plant should be sited as far away from NSRs as possible and practicable;</li> <li>material stockpiles, mobile container site office and other structures should be effectively utilised, where practicable, to screen noise from on-site construction activities.</li> </ul>	Control construction airborne noise by means of good site practices	Contractor	All construction sites	Construction stage	Noise Control Ordinance	√
S6.4.11	N2	2) Install temporary hoarding located on the site boundaries between noisy construction activities and NSRs. The conditions of the hoardings shall be properly maintained throughout the construction period.	Reduce the construction noise levels at low-level zone of NSRs through partial screening.	Contractor	All construction sites	Construction stage	<ul style="list-style-type: none"> <li>Noise Control Ordinance</li> <li>Annex 5, TM-EIA</li> </ul>	N/A
S6.4.12	N3	3) Install movable noise barriers (typically density @14kg/m <sup>2</sup> ), acoustic mat or full enclosure close to noisy plants including air compressor, generators, saw.	Screen the noisy plant items to be used at all construction sites	Contractor	For plant items listed in Appendix 6D of the EIA report at all construction sites	Construction stage	<ul style="list-style-type: none"> <li>Noise Control Ordinance</li> <li>Annex 5, TM-EIA</li> <li>75dB(A) for residential premises</li> <li>The movable barrier should achieve at least 5dB(A) and the full enclosure should be</li> </ul>	N/A



EIA Ref.	EM&A Log Ref	Recommended Mitigation Measures	Objectives of the Recommended Measures & Main Concerns to address	Who to implement the measures?	Location of the measures	When to implement the measures?	What requirements or standards for the measures to achieve?	Implementation Status
S6.4.13	N4	4) Select "Quiet plants" which comply with the BS 5228 Part 1 or TM standards.	Reduce the noise levels of plant items	Contractor	For plant items listed in Appendix 6D of the EIA report at all construction sites	Construction stage	<ul style="list-style-type: none"> <li>Noise Control Ordinance &amp; its TM</li> <li>Annex 5, TM-EIA</li> </ul>	√
S6.4.14	N5	5) Sequencing operation of construction plants where practicable.	Operate sequentially within the same work site to reduce the construction airborne noise	Contractor	All construction sites where practicable	Construction stage	<ul style="list-style-type: none"> <li>Noise Control Ordinance</li> <li>Annex 5, TM-EIA</li> </ul>	√
/	N6	6) Implement a noise monitoring under EM&A programme.	Monitor the construction noise levels at the selected representative locations	Contractor	Selected representative noise monitoring station	Construction stage	<ul style="list-style-type: none"> <li>Noise Control Ordinance</li> <li>Annex 5, TM-EIA</li> <li>75dB(A) for residential premises</li> </ul>	√ (The noise monitoring works under EM&A programme for the Contract are covered by Contract No. HY/2010/02.)
<b>Sediment</b>								
S7.3	S1	1) The requirements as recommended in ETWB TC 34/2002 Management of Dredged/Excavated Sediment shall be included in the Particular Specification as appropriate.	Develop sediment disposal arrangement	Engineer	All construction sites	Design stage	<ul style="list-style-type: none"> <li>Waste Disposal Ordinance</li> <li>ETW B TC 34/2002</li> </ul>	N/A

EIA Ref.	EM&A Log Ref	Recommended Mitigation Measures	Objectives of the Recommended Measures & Main Concerns to address	Who to implement the measures?	Location of the measures	When to implement the measures?	What requirements or standards for the measures to achieve?	Implementation Status
<b>Waste Management (Construction Waste)</b>								
S8.3.8	WM1	<p><u>Construction and Demolition Material</u></p> <p>The following mitigation measures should be implemented in handling the waste:</p> <ul style="list-style-type: none"> <li>• Maintain temporary stockpiles and reuse excavated fill material for backfilling and reinstatement;</li> <li>• Carry out on-site sorting;</li> <li>• Make provisions in the Contract documents to allow and promote the use of recycled aggregates where appropriate;</li> <li>• Adopt 'Selective Demolition' technique to demolish the existing structures and facilities with a view to recovering broken concrete effectively for recycling purpose, where possible;</li> <li>• Implement a trip-ticket system for each works contract to ensure that the disposal of C&amp;D materials are properly documented and verified; and</li> <li>• Implement an enhanced Waste Management Plan similar to ETW BTC (Works) No. 19/2005 – "Environmental Management on Construction Sites" to encourage on-site sorting of C&amp;D materials and to minimize their generation during the course of construction.</li> <li>• In addition, disposal of the C&amp;D materials onto any sensitive locations such as agricultural lands, etc. should be avoided. The Contractor shall propose the final disposal sites to the Project Proponent and get its approval before implementation.</li> </ul>	Good site practice to minimize the waste generation and recycle the C&D materials as far as practicable so as to reduce the amount for final disposal	Contractor	All construction sites	Construction stage	<ul style="list-style-type: none"> <li>• Land (Miscellaneous Provisions) Ordinance</li> <li>• Waste Disposal Ordinance</li> <li>• ETW BTC 19/2005</li> </ul>	√

EIA Ref.	EM&A Log Ref	Recommended Mitigation Measures	Objectives of the Recommended Measures & Main Concerns to address	Who to implement the measures?	Location of the measures	When to implement the measures?	What requirements or standards for the measures to achieve?	Implementation Status
S8.3.9-S8.3.11	WM2	<u>C&amp;D Waste</u> <ul style="list-style-type: none"> <li>Standard formwork or pre-fabrication should be used as far as practicable in order to minimise the arising of C&amp;D materials. The use of more durable formwork or plastic facing for the construction works should be considered. Use of wooden hoardings should not be used, as in other projects. Metal hoarding should be used to enhance the possibility of recycling. The purchasing of construction materials will be carefully planned in order to avoid over ordering and wastage.</li> <li>The Contractor should recycle as much of the C&amp;D materials as possible on-site. Public fill and C&amp;D waste should be segregated and stored in different containers or skips to enhance reuse or recycling of materials and their proper disposal. Where practicable, concrete and masonry can be crushed and used as fill. Steel reinforcement bar can be used by scrap steel mills. Different areas of the sites should be considered for such segregation and storage.</li> </ul>	Good site practice to minimize the waste generation and recycle the C&D materials as far as practicable so as to reduce the amount for final disposal	Contractor	All construction sites	Construction stage	<ul style="list-style-type: none"> <li>Land (Miscellaneous Provisions) Ordinance</li> <li>Waste Disposal Ordinance</li> <li>ETWB TC 19/2005</li> </ul>	√
S8.2.12-S8.3.15	WM3	<u>Chemical Waste</u> <ul style="list-style-type: none"> <li>Chemical waste that is produced, as defined by Schedule 1 of the Waste Disposal (Chemical Waste) (General) Regulation, should be handled in accordance with the Code of Practice on the Packaging, Labelling and Storage of Chemical Wastes.</li> <li>Containers used for the storage of chemical wastes should be suitable for the substance they are holding, resistant to corrosion, maintained in a good condition, and securely closed; have a capacity of less than 450 liters unless the specification has been approved by the EPD; and display a label in English and Chinese in accordance with instructions prescribed in Schedule 2 of the regulation.</li> <li>The storage area for chemical wastes should be clearly labelled and used solely for the storage of chemical waste; enclosed on at least 3 sides; have an impermeable floor and bunding of sufficient capacity to accommodate 110% of the volume of the largest container or 20 % of the total volume of waste stored in that area, whichever is the greatest; have adequate ventilation; covered to prevent rainfall entering; and arranged so that incompatible materials are adequately separated.</li> </ul>	Control the chemical waste and ensure proper storage, handling and disposal.	Contractor	All construction sites	Construction stage	<ul style="list-style-type: none"> <li>Waste Disposal (Chemical Waste) General) Regulation</li> <li>Code of Practice on the Packaging, Labelling and Storage of Chemical Waste</li> </ul>	√

EIA Ref.	EM&A Log Ref	Recommended Mitigation Measures	Objectives of the Recommended Measures & Main Concerns to address	Who to implement the measures?	Location of the measures	When to implement the measures?	What requirements or standards for the measures to achieve?	Implementation Status
		<ul style="list-style-type: none"> <li>Disposal of chemical waste should be via a licensed waste collector; be to a facility licensed to receive chemical waste, such as the Chemical Waste Treatment Centre which also offers a chemical waste collection service and can supply the necessary storage containers; or be to a reuser of the waste, under approval from the EPD.</li> </ul>						√
S8.3.16	WM4	<u>Sewage</u> <ul style="list-style-type: none"> <li>Adequate numbers of portable toilets should be provided for the workers. The portable toilets should be maintained in a state, which will not deter the workers from utilizing these portable toilets. Night soil should be collected by licensed collectors regularly.</li> </ul>	Proper handling of sewage from worker to avoid odour, pest and litter impacts	Contractor	All construction sites	Construction stage	<ul style="list-style-type: none"> <li>Waste Disposal Ordinance</li> </ul>	√
S8.3.17	WM5	<u>General Refuse</u> <ul style="list-style-type: none"> <li>General refuse generated on-site should be stored in enclosed bins or compaction units separately from construction and chemical wastes.</li> <li>A reputable waste collector should be employed by the Contractor to remove general refuse from the site, separately from construction and chemical wastes, on a daily basis to minimize odour, pest and litter impacts. Burning of refuse on construction sites is prohibited by law.</li> <li>Aluminium cans are often recovered from the waste stream by individual collectors if they are segregated and made easily accessible. Separate labelled bins for their deposit should be provided if feasible.</li> <li>Office wastes can be reduced through the recycling of paper if volumes are large enough to warrant collection. Participation in a local collection scheme should be considered by the Contractor. In addition, waste separation facilities for paper, aluminum cans, plastic bottles etc., should be provided.</li> <li>Training should be provided to workers about the concepts of site cleanliness and appropriate waste management procedure, including reduction, reuse and recycling of wastes.</li> </ul>	Minimize production of the general refuse and avoid odour, pest and litter impacts	Contractor	All construction sites	Construction stage	<ul style="list-style-type: none"> <li>Waste Disposal Ordinance</li> </ul>	√

EIA Ref.	EM&A Log Ref	Recommended Mitigation Measures	Objectives of the Recommended Measures & Main Concerns to address	Who to implement the measures?	Location of the measures	When to implement the measures?	What requirements or standards for the measures to achieve?	Implementation Status
<b>Water Quality (Construction Phase)</b>								
S.9.11.1.7	W2	<p><u>Land Works</u> General construction activities on land should also be governed by standard good working practice. Specific measures to be written into the works contracts should include:</p> <ul style="list-style-type: none"> <li>wastewater from temporary site facilities should be controlled to prevent direct discharge to surface or marine waters;</li> <li>sewage effluent and discharges from on-site kitchen facilities shall be directed to Government sewer in accordance with the requirements of the WPCO or collected for disposal offsite. The use of soakaways shall be avoided;</li> <li>storm drainage shall be directed to storm drains via adequately designed sand/silt removal facilities such as sand traps, silt traps and sediment basins. Channels, earth bunds or sand bag barriers should be provided on site to properly direct stormwater to such silt removal facilities. Catchpits and perimeter channels should be constructed in advance of site formation works and earthworks;</li> <li>silt removal facilities, channels and manholes shall be maintained and any deposited silt and grit shall be removed regularly, including specifically at the onset of and after each rainstorm;</li> <li>temporary access roads should be surfaced with crushed stone or gravel;</li> <li>rainwater pumped out from trenches or foundation excavations should be discharged into storm drains via silt removal facilities;</li> <li>measures should be taken to prevent the washout of construction materials, soil, silt or debris into any drainage system;</li> <li>open stockpiles of construction materials (e.g. aggregates and sand) on site should be covered with tarpaulin or similar fabric during rainstorms;</li> <li>manholes (including any newly constructed ones) should always be adequately covered and temporarily sealed so as to prevent silt, construction materials or debris from getting into the drainage system, and to prevent storm run-off from getting into foul sewers;</li> <li>discharges of surface run-off into foul sewers must always be prevented in order not to unduly overload the foul sewerage system;</li> </ul>	To control construction water quality	Contractor	Land-based works areas	Construction stage	TM-EIAO	√

EIA Ref.	EM&A Log Ref	Recommended Mitigation Measures	Objectives of the Recommended Measures & Main Concerns to address	Who to implement the measures?	Location of the measures	When to implement the measures?	What requirements or standards for the measures to achieve?	Implementation Status
S9.11.1.7	W2	<ul style="list-style-type: none"> <li>all vehicles and plant should be cleaned before they leave the construction site to ensure that no earth, mud or debris is deposited by them on roads. A wheel washing bay should be provided at every site exit;</li> <li>wheel wash overflow shall be directed to silt removal facilities before being discharged to the storm drain;</li> <li>the section of construction road between the wheel washing bay and the public road should be surfaced with crushed stone or coarse gravel;</li> <li>wastewater generated from concreting, plastering, internal decoration, cleaning work and other similar activities, shall be screened to remove large objects;</li> <li>vehicle and plant servicing areas, vehicle wash bays and lubrication facilities shall be located under roofed areas. The drainage in these covered areas shall be connected to foul sewers via a petrol interceptor in accordance with the requirements of the WPCO or collected for off site disposal;</li> <li>the contractors shall prepare an oil / chemical cleanup plan and ensure that leakages or spillages are contained and cleaned up immediately;</li> <li>waste oil should be collected and stored for recycling or disposal, in accordance with the Waste Disposal Ordinance;</li> <li>all fuel tanks and chemical storage areas should be provided with locks and be sited on sealed areas. The storage areas should be surrounded by bunds with a capacity equal to 110% of the storage capacity of the largest tank; and</li> <li>surface run-off from bunded areas should pass through oil/grease traps prior to discharge to the stormwater system.</li> </ul>	To control construction water quality	Contractor	Land-based works areas	Construction stage	TM-EIAO	√

EIA Ref.	EM&A Log Ref	Recommended Mitigation Measures	Objectives of the Recommended Measures & Main Concerns to address	Who to implement the measures?	Location of the measures	When to implement the measures?	What requirements or standards for the measures to achieve?	Implementation Status
<b>Ecology (Construction Phase)</b>								
S10.7	E4	<ul style="list-style-type: none"> <li>Watering to reduce dust generation; prevention of siltation of freshwater habitats; Site runoff should be desilted, to reduce the potential for suspended sediments, organics and other contaminants to enter streams and standing freshwater</li> </ul>	Prevent Sedimentation from Land-based works areas	Contractor	Land-based works areas	During construction	TM-Water	√
S10.7	E5	<ul style="list-style-type: none"> <li>Good site practices, including strictly following the permitted works hours, using quieter machines where practicable, and avoiding excessive lightings during night time</li> </ul>	Prevent disturbance to terrestrial fauna and habitats	Contractor	Land-based works areas	During construction		√
S10.7	E8	<ul style="list-style-type: none"> <li>Control vessel speed</li> <li>Skipper training</li> <li>Predefined and regular routes for working vessels; avoid Brother Islands.</li> </ul>	Minimise marine traffic disturbance on dolphins	Contractor	Marine Traffic	During construction		N/A
<b>Fisheries</b>								
S11.7	F4	<ul style="list-style-type: none"> <li>Maritime Oil Spill Response Plan (MOSRP);</li> <li>Contingency plan.</li> </ul>	Minimise impacts on marine water quality impacts	Marine Department	HKBCF	During operation		N/A



EIA Ref.	EM&A Log Ref	Recommended Mitigation Measures	Objectives of the Recommended Measures & Main Concerns to address	Who to implement the measures?	Location of the measures	When to implement the measures?	What requirements or standards for the measures to achieve?	Implementation Status
<b>Landscape &amp; Visual (Detailed Design Phase)</b>								
S14.3.3.1	LV1	<p>General design measures include:</p> <ul style="list-style-type: none"> <li>Roadside planting and planting along the edge of the HKBCF Island is proposed;</li> <li>Transplanting of mature trees in good health and amenity value where appropriate and reinstatement of areas disturbed during construction by compensatory hydro-seeding and planting;</li> <li>Protection measures for the trees to be retained during construction activities;</li> <li>Optimizing the sizes and spacing of the bridge columns; Fine-tuning the location of the bridge columns to avoid visually-sensitive locations;</li> <li>Maximizing new tree, shrub and other vegetation planting to compensate tree felled and vegetation removed;</li> <li>Providing planting area around peripheral of HKBCF for tree planting screening effect;</li> <li>Providing salt-tolerant native trees along the planter strip at affected seawall and newly reclaimed coastline;</li> <li>For HKBCF, providing aesthetic architectural design on the related buildings (e.g. similar materials for PCB building facade to Airport buildings, roof planting and subtle materials for other facilities buildings and so on), and the related infrastructure (e.g. parapet planting and transparent cover for elevated footbridges) to provide harmonious atmosphere of the HKBCF; and</li> <li>Fine-tuning the sizes of the structural members to minimize the bulkiness of buildings and adjustment of building arrangement to minimise disturbance to surrounding vegetation in the HKBCF.</li> </ul>	Minimise visual & landscape impact	Detailed designer	HKBCF	Design Stage		N/A

EIA Ref.	EM&A Log Ref	Recommended Mitigation Measures	Objectives of the Recommended Measures & Main Concerns to address	Who to implement the measures?	Location of the measures	When to implement the measures?	What requirements or standards for the measures to achieve?	Implementation Status
<i>Landscape &amp; Visual (Construction Phase)</i>								
S14.3.3.3	LV2	<p>Mitigate both Landscape and Visual Impacts</p> <p>G1. Grass-hydroseed bare soil surface and stock pile areas.</p> <p>G2. Add planting strip and automatic irrigation system if appropriate at some portions of bridge footbridge to screen bridge and traffic.</p> <p>G3. Not applicable as this is for HKLR.</p> <p>G4. For HKBCF, providing aesthetic architectural design on the related buildings (e.g. similar materials for PCB building facade to Airport buildings, roof planting and subtle materials for other facilities buildings and so on), and the related infrastructure (e.g. parapet planting and transparent cover for elevated footbridges) to provide harmonious atmosphere of the HKBCF</p> <p>G5. Vegetation reinstatement and upgrading to disturbed areas</p> <p>G6. Maximizing new tree shrub and other vegetation planting to compensate tree felled and vegetation removed</p> <p>G7. Providing planting area around peripheral of HKBCF for tree planting screening effect;</p> <p>G8. Plant salt-tolerant native and shrubs etc along the planter strip at affected seawall.</p> <p>G9. Reserve of loose natural granite rocks for re-use. Provide new coastline to adopt "natural-look" by means of using armour rocks in the form of natural rock materials and planting strip area accommodating screen buffer to enhance "natural-look" of the new coastline.</p>	Minimise visual & landscape impact	Contractor	HKBCF	Construction stage		N/A
S14.3.3.3	LV3	<p><u>Mitigate Visual Impacts</u></p> <p>V1.Minimize time for construction activities during construction period.</p> <p>V2.Provide screen hoarding at the portion of the project site / works areas / storage areas near VSRs who have close low-level views to the Project during HKBCF construction.</p>						√ for V1. N/A for V2.

EIA Ref.	EM&A Log Ref	Recommended Mitigation Measures	Objectives of the Recommended Measures & Main Concerns to address	Who to implement the measures?	Location of the measures	When to implement the measures?	What requirements or standards for the measures to achieve?	Implementation Status
<b>EM&amp;A</b>								
S15.2.2	EM1	An Independent Environmental Checker needs to be employed as per the EM&A Manual.	Control EM&A Performance	Project Proponent	All construction sites		<ul style="list-style-type: none"> <li>EIAO Guidance Note No.4/2002</li> <li>TM-EIAO</li> </ul>	√
S15.5 - S15.6	EM2	1) An Environmental Team needs to be employed as per the EM&A Manual.  2) Prepare a systematic Environmental Management Plan to ensure effective implementation of the mitigation measures.  3) An environmental impact monitoring needs to be implementing by the Environmental Team to ensure all the requirements given in the EM&A Manual are fully complied with.	Perform environmental monitoring & auditing	Contractor	All construction sites		<ul style="list-style-type: none"> <li>EIAO Guidance Note No.4/2002</li> <li>TM-EIAO</li> </ul>	√

Legends: √ = Implemented; X = Not implemented; N/A = Not applicable



路政署  
**HIGHWAYS DEPARTMENT**

港珠澳大橋香港工程管理處  
Hong Kong - Zhuhai - Macao Bridge  
Hong Kong Project Management Office

Contract No. HY/2013/01

Hong Kong-Zhuhai-Macao Bridge

Hong Kong Boundary Crossing Facilities – Passenger Clearance Building

14<sup>th</sup> Monthly EM&A Report

---

## **APPENDIX H**

---

Statistics on Environmental Complaints, Notification of Summons and  
Successful Prosecutions

### Statistics on Environmental Complaints, Notifications of Summons and Successful Prosecutions

Reporting Period	Cumulative Statistics		
	Complaints	Notifications of Summons	Successful Prosecutions
This reporting period	0	0	0
From commencement date of contract to end of reporting month	2	0	0



路政署  
**HIGHWAYS DEPARTMENT**

港珠澳大橋香港工程管理處  
Hong Kong - Zhuhai - Macao Bridge  
Hong Kong Project Management Office

Contract No. HY/2013/01

Hong Kong-Zhuhai-Macao Bridge

Hong Kong Boundary Crossing Facilities – Passenger Clearance Building

14<sup>th</sup> Monthly EM&A Report

# APPENDIX I

## Environmental Site Inspection Schedule

**Dec-15**

	Sunday	Monday	Tuesday	Wednesday	Thursday	Friday	Saturday
Time			1-Dec	2-Dec	3-Dec	4-Dec	5-Dec
				Site Inspection			
Time	6-Dec	7-Dec	8-Dec	9-Dec	10-Dec	11-Dec	12-Dec
				Site Inspection			
Time	13-Dec	14-Dec	15-Dec	16-Dec	17-Dec	18-Dec	19-Dec
				Site Inspection			
Time	20-Dec	21-Dec	22-Dec	23-Dec	24-Dec	25-Dec	26-Dec
				Site Inspection			
Time	27-Dec	28-Dec	29-Dec	30-Dec	31-Dec		
				Site Inspection			