

DO NOT SCALE DRAWING. CHECK ALL DIMENSIONS ON SITE.

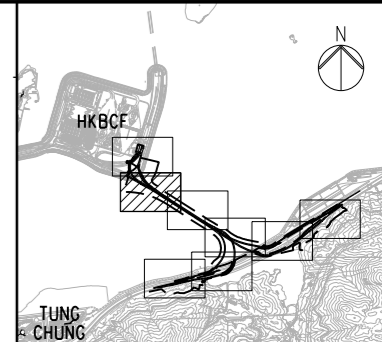
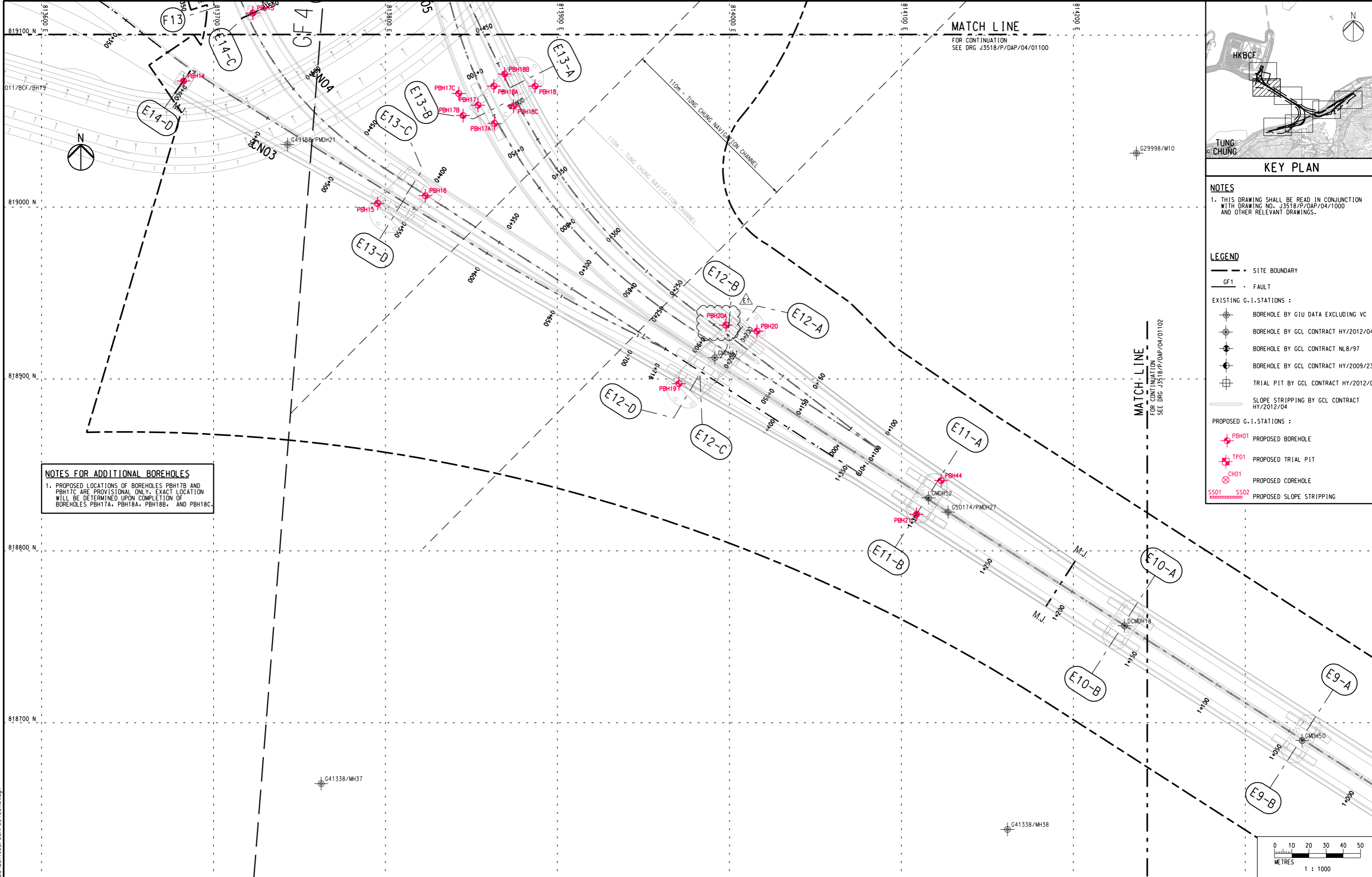

KEY PLAN

NOTES
 1. THIS DRAWING SHALL BE READ IN CONJUNCTION WITH DRAWING NO. J3518/P/OAP/04/1000 AND OTHER RELEVANT DRAWINGS.

LEGEND

	SITE BOUNDARY
	FAULT
EXISTING G.I. STATIONS :	
	BOREHOLE BY GIU DATA EXCLUDING VC
	BOREHOLE BY GCL CONTRACT HY/2012/04
	BOREHOLE BY GCL CONTRACT NLB/97
	BOREHOLE BY GCL CONTRACT HY/2009/23
	TRIAL PIT BY GCL CONTRACT HY/2012/04
	SLOPE STRIPPING BY GCL CONTRACT HY/2012/04
PROPOSED G.I. STATIONS :	
	PROPOSED BOREHOLE
	PROPOSED TRIAL PIT
	PROPOSED COREHOLE
	PROPOSED SLOPE STRIPPING

NOTES FOR ADDITIONAL BOREHOLES
 1. PROPOSED LOCATIONS OF BOREHOLES PBH17B AND PBH17C ARE PROVISIONAL ONLY. EXACT LOCATION WILL BE DETERMINED UPON COMPLETION OF BOREHOLES PBH17A, PBH18A, PBH18B, AND PBH18C.

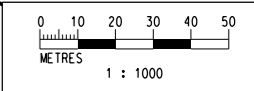

Printed by : 05.11.13
 J:\231499\ARUP\GEO\231499_P_OAP_04_01101.dgn

Rev	Description	By	Date	Rev	Description	By	Date	Drawn	Date
A	SUBMISSION	RC	07/13					RL	07/13
B	SUBMISSION	RC	07/13					Checked	Approved
C	SUBMISSION	RC	09/13					DS	DOP
D	SUBMISSION	RC	10/13					Scale	1:1000 @ A1 / 1:2000 @ A3
E1	FOR INTERNAL REVIEW	RC	11/13						

 HIGHWAYS DEPARTMENT 港珠澳大橋香港工程管理處 Hong Kong - Zhuhai - Macao Bridge Hong Kong Project Management Office	Project Title Contract No. HY/2012/07 Tuen Mun - Chek Lap Kok Link Southern Connection Viaduct Section	Drawing title PROPOSED GROUND INVESTIGATION PLAN (SHEET 2 OF 8) Fig 1.5
	Drawing no. J3518/P/OAP/04/01101 Rev. E1	Drawing title PROPOSED GROUND INVESTIGATION PLAN (SHEET 2 OF 8) Fig 1.5