

DO NOT SCALE DRAWING. CHECK ALL DIMENSIONS ON SITE.

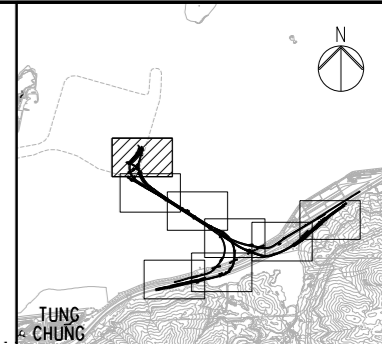
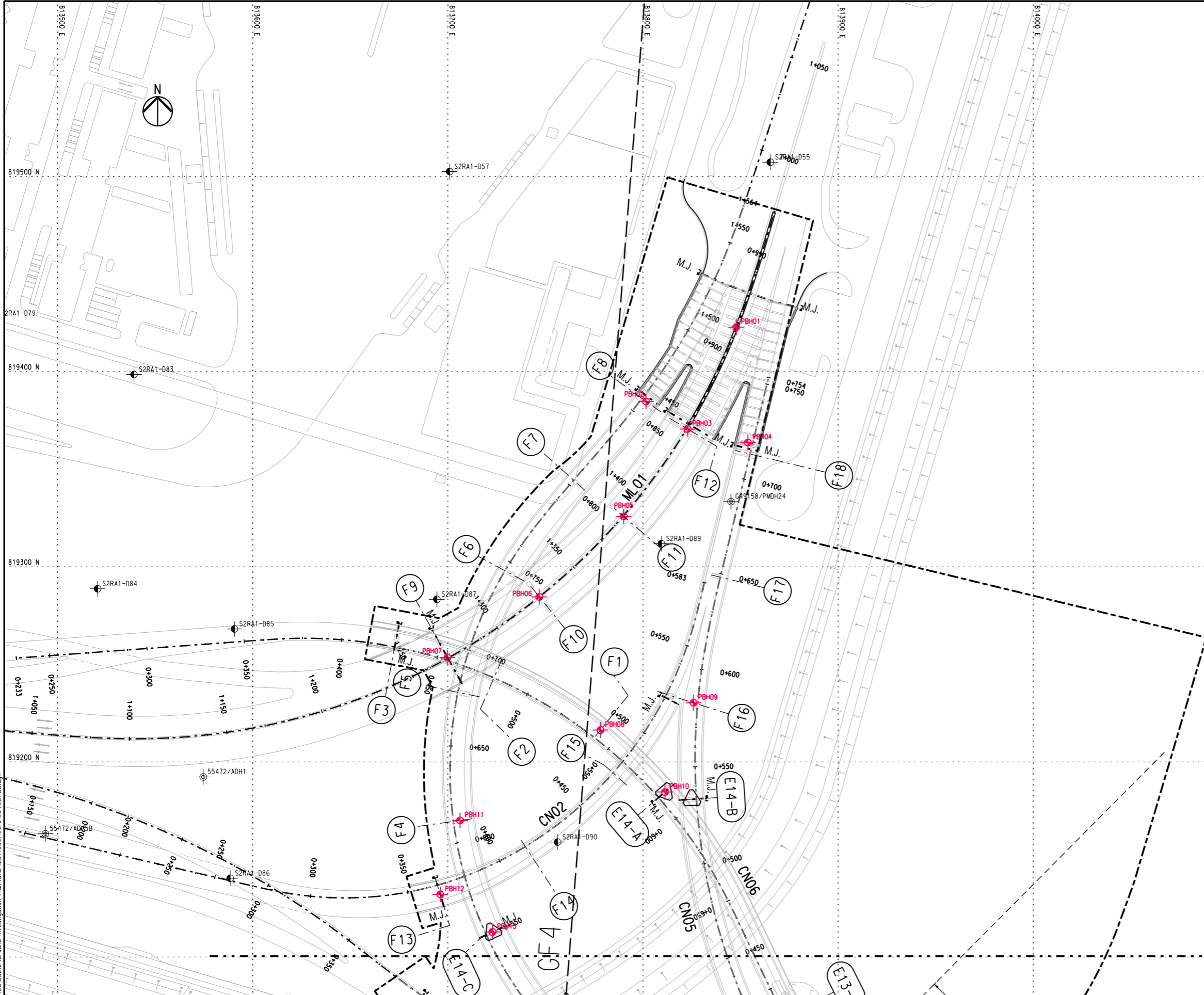

KEY PLAN

NOTES
 1. THIS DRAWING SHALL BE READ IN CONJUNCTION WITH DRAWING NO. J3518/P/OAP/04/1000 AND OTHER RELEVANT DRAWINGS.

- LEGEND**
- SITE BOUNDARY
 - GF1 FAULT
 - EXISTING G.I. STATIONS :
 - ⊕ BOREHOLE BY GIU DATA EXCLUDING VC
 - ⊕ BOREHOLE BY GCL CONTRACT HY/2012/04
 - ⊕ BOREHOLE BY GCL CONTRACT NL8/97
 - ⊕ BOREHOLE BY GCL CONTRACT HY/2009/23
 - ⊕ TRIAL PIT BY GCL CONTRACT HY/2012/04
 - SLOPE STRIPPING BY GCL CONTRACT HY/2012/04
 - PROPOSED G.I. STATIONS :
 - ⊕ PBH01 PROPOSED BOREHOLE
 - ⊕ TP01 PROPOSED TRIAL PIT
 - ⊕ CH01 PROPOSED COREHOLE
 - SS01 SS02 PROPOSED SLOPE STRIPPING

MATCH LINE
 FOR CONTINUATION
 SEE DRG J3518/P/OAP/04/01101

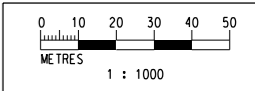

Printed by : 12/9/2013
 File name : J:\231499\RECORD\20130912\Ground Investigation Plan\CAO\231499_P_OAP_04_01100.dgn

Rev	Description	By	Date	Rev	Description	By	Date	Drawn	Date
A	SUBMISSION	RC	07/13					RL	07/13
B	SUBMISSION	RC	07/13					Checked	Approved
C	SUBMISSION	RC	09/13					DS	DOP
								Scale	
								1:1000 @ A1 / 1:2000 @ A3	

Client 路政署 HIGHWAYS DEPARTMENT 港珠澳大橋香港工程管理局 Hong Kong - Zhuhai - Macao Bridge Hong Kong Project Management Office	Project Title Contract No. HY/2012/07 Tuen Mun - Chek Lap Kok Link Southern Connection Viaduct Section	Drawing title PROPOSED GROUND INVESTIGATION PLAN (1) Fig 1.4 Drawing no. J3518/P/OAP/04/01100	Rev. C