

DO NOT SCALE DRAWING. CHECK ALL DIMENSIONS ON SITE.

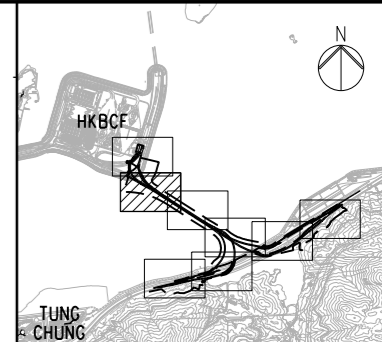
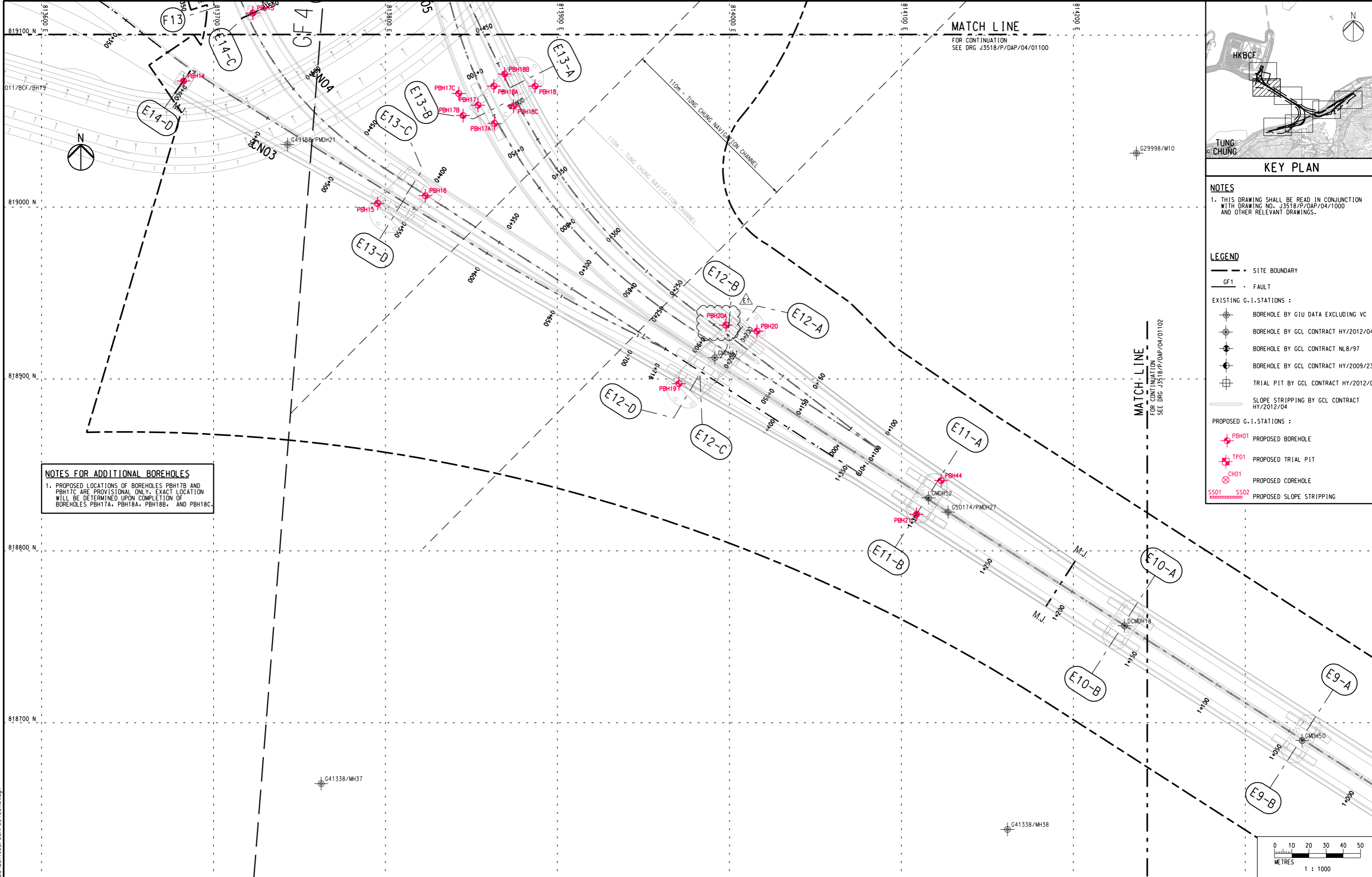

**KEY PLAN**

**NOTES**  
 1. THIS DRAWING SHALL BE READ IN CONJUNCTION WITH DRAWING NO. J3518/P/OAP/04/1000 AND OTHER RELEVANT DRAWINGS.

**LEGEND**

	SITE BOUNDARY
	FAULT
<b>EXISTING G.I. STATIONS :</b>	
	BOREHOLE BY GIU DATA EXCLUDING VC
	BOREHOLE BY GCL CONTRACT HY/2012/04
	BOREHOLE BY GCL CONTRACT NLB/97
	BOREHOLE BY GCL CONTRACT HY/2009/23
	TRIAL PIT BY GCL CONTRACT HY/2012/04
	SLOPE STRIPPING BY GCL CONTRACT HY/2012/04
<b>PROPOSED G.I. STATIONS :</b>	
	PROPOSED BOREHOLE
	PROPOSED TRIAL PIT
	PROPOSED COREHOLE
	PROPOSED SLOPE STRIPPING

**NOTES FOR ADDITIONAL BOREHOLES**  
 1. PROPOSED LOCATIONS OF BOREHOLES PBH17B AND PBH17C ARE PROVISIONAL ONLY. EXACT LOCATION WILL BE DETERMINED UPON COMPLETION OF BOREHOLES PBH17A, PBH18A, PBH18B, AND PBH18C.

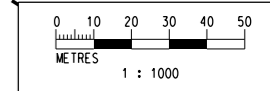

Printed by : 05.11.13  
 J:\231499\ARUP\GEO\231499\_P\_OAP\_04\_01101.dgn

Rev	Description	By	Date	Rev	Description	By	Date	Drawn	Date
A	SUBMISSION	RC	07/13					RL	07/13
B	SUBMISSION	RC	07/13					Checked	Approved
C	SUBMISSION	RC	09/13					DS	DOP
D	SUBMISSION	RC	10/13					Scale	1:1000 @ A1 / 1:2000 @ A3
E1	FOR INTERNAL REVIEW	RC	11/13						

Client  <b>HIGHWAYS DEPARTMENT</b> 港珠澳大橋香港工程管理局 Hong Kong - Zhuhai - Macao Bridge Hong Kong Project Management Office	Project Title <b>Contract No. HY/2012/07</b> <b>Tuen Mun - Chek Lap Kok Link</b> <b>Southern Connection Viaduct Section</b>	Drawing title <b>PROPOSED GROUND INVESTIGATION PLAN (2)</b> <b>Fig 1.5</b>	
		Drawing no. <b>J3518/P/OAP/04/01101</b> Rev. <b>E1</b>	
Supervising Officer 	Contractor 	Originator 	