

DO NOT SCALE DRAWING. CHECK ALL DIMENSIONS ON SITE.

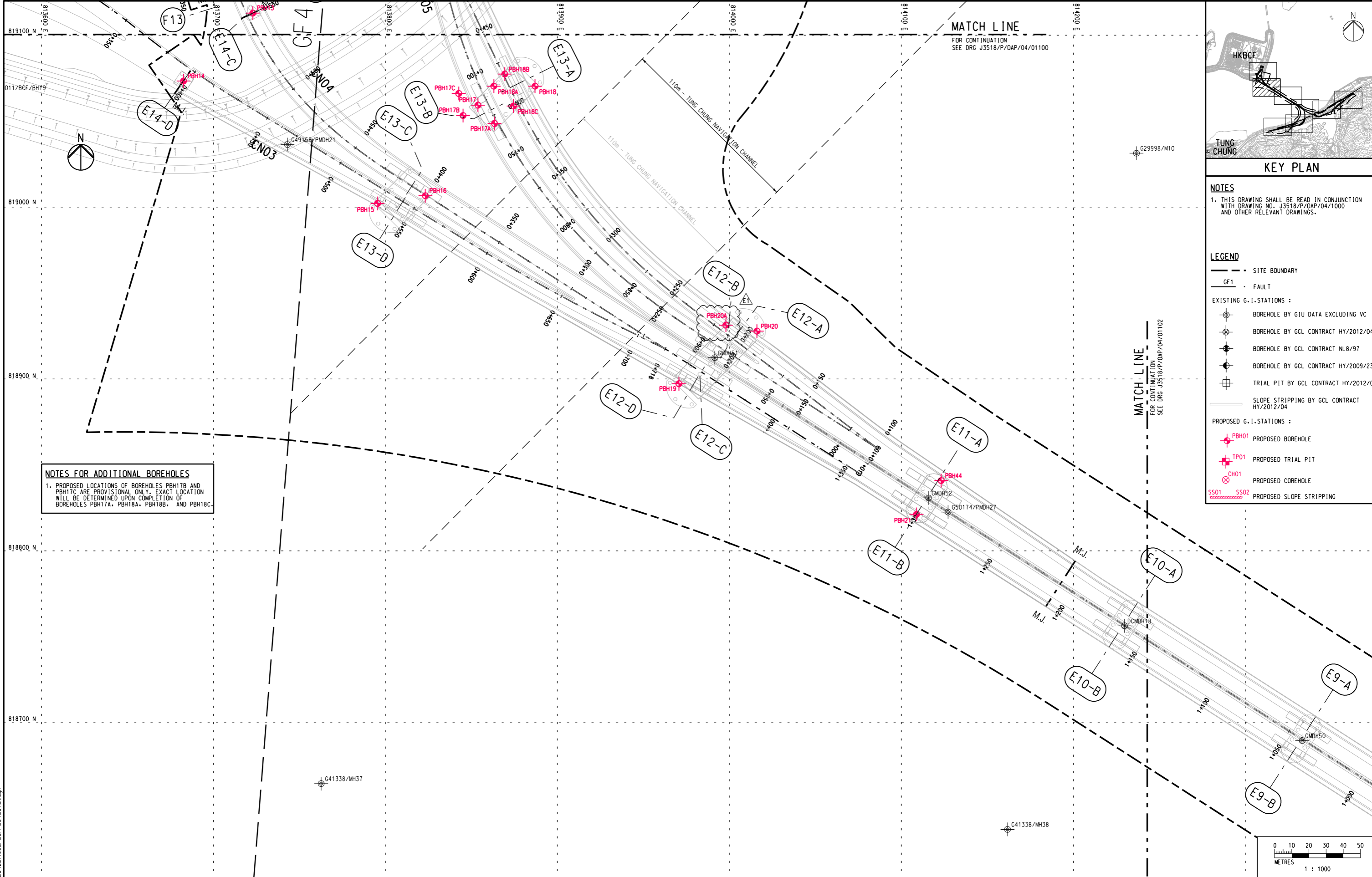

**MATCH LINE**  
FOR CONTINUATION  
SEE DRG J3518/P/OAP/04/01100

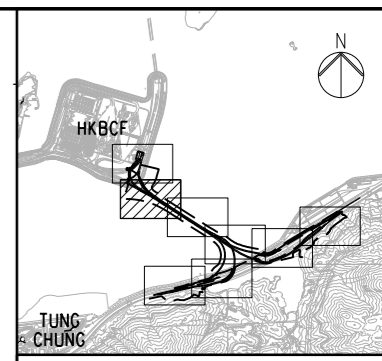

**KEY PLAN**

**NOTES**  
1. THIS DRAWING SHALL BE READ IN CONJUNCTION WITH DRAWING NO. J3518/P/OAP/04/1000 AND OTHER RELEVANT DRAWINGS.

**LEGEND**

- - - SITE BOUNDARY
- GF1 FAULT

**EXISTING G.I. STATIONS :**

- ⊕ BOREHOLE BY GIU DATA EXCLUDING VC
- ⊕ BOREHOLE BY GCL CONTRACT HY/2012/04
- ⊕ BOREHOLE BY GCL CONTRACT NLB/97
- ⊕ BOREHOLE BY GCL CONTRACT HY/2009/23
- ⊕ TRIAL PIT BY GCL CONTRACT HY/2012/04
- ▬ SLOPE STRIPPING BY GCL CONTRACT HY/2012/04

**PROPOSED G.I. STATIONS :**

- ⊕ PBH01 PROPOSED BOREHOLE
- ⊕ TP01 PROPOSED TRIAL PIT
- ⊕ CH01 PROPOSED COREHOLE
- SS01 SS02 PROPOSED SLOPE STRIPPING

**NOTES FOR ADDITIONAL BOREHOLES**  
1. PROPOSED LOCATIONS OF BOREHOLES PBH17B AND PBH17C ARE PROVISIONAL ONLY. EXACT LOCATION WILL BE DETERMINED UPON COMPLETION OF BOREHOLES PBH17A, PBH18A, PBH18B, AND PBH18C.

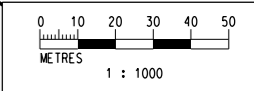

Printed by : 05.11.13  
J:\231499\ARUP\GEO\231499\_P\_OAP\_04\_01101.dgn

Rev	Description	By	Date	Rev	Description	By	Date	Drawn	Date	Client
A	SUBMISSION	RC	07/13					RL	07/13	<p><b>路政署</b> <b>HIGHWAYS DEPARTMENT</b> 港珠澳大橋香港工程處 Hong Kong - Zhuhai - Macao Bridge Hong Kong Project Management Office</p>
B	SUBMISSION	RC	07/13					Checked	Approved	
C	SUBMISSION	RC	09/13					DS	DOP	
D	SUBMISSION	RC	10/13					Scale	1:1000 @ A1 / 1:2000 @ A3	
E1	FOR INTERNAL REVIEW	RC	11/13							

<p>Supervising Officer <b>AECOM</b></p>	<p>Contractor <b>Gammon</b></p>	<p>Originator <b>ARUP</b></p>	<p>Drawing title <b>PROPOSED GROUND INVESTIGATION PLAN (2)</b> <b>Fig 1.5</b> Drawing no. <b>J3518/P/OAP/04/01101</b> Rev. <b>E1</b></p>
---	-------------------------------------	-----------------------------------	--