

Project Management: Hinkley  
 Designer: LHM  
 Checked: SLYT  
 Approved: CWN  
 ISO AT 9001:2015  
 ISO AT 14001:2015  
 Proj File by: H:\AECOM\2012\60240249\CONTRACT\CT1\0000\CI\_2000.dgn  
 Path: P:\Projects\60240249\DRAWINGS\CONTRACT\CT1\0000\CI\_2000.dgn



**NOTES:**

- CONTRACTOR SHALL REFER TO THE BUOYS FROM THE 2011 VERSION OF ADMIRALTY CHART FOR LOCAL VESSELS FOR LOCATION OF EXISTING TUNG CHUNG NAVIGATION CHANNEL AND THE LINES FOR EXISTING TUNG CHUNG NAVIGATION CHANNEL ARE APPROXIMATE ONLY.
- FOR THE INDICATIVE MOVEMENT JOINT LOCATIONS AND CORRESPONDING STRUCTURES NUMBERING SHOWN ON SHEET NO. 60240249/C1/2005 TO 2009 SHALL BE REFERRED. THE LOCATIONS OF MOVEMENT JOINTS AT INTERFACE PIERS WITH HKBCF ARE TO BE STRICTLY FOLLOWED BY THE CONTRACTOR. THE EXACT LOCATIONS OF OTHER MOVEMENT JOINTS ARE TO BE DESIGNED BY THE CONTRACTOR.

**LEGEND:**

— SITE BOUNDARY

▬ STRUCTURES E2/E5/E6/E7/E8

**AECOM**

**PROJECT**  
TUEN MUN - CHEK LAP KOK LINK

**CONTRACT TITLE**  
TUEN MUN - CHEK LAP KOK LINK - SOUTHERN CONNECTION VIADUCT SECTION

**CLIENT**  
路政署  
HIGHWAYS DEPARTMENT  
香港路政署  
Hong Kong Project Management Office

**CONSULTANT**  
AECOM Asia Company Ltd.  
www.aecom.com

**SUB-CONSULTANTS**

# Figure 1.2a

**ISSUE/REVISION**

NO.	DATE	DESCRIPTION	CHK.

**STATUS**

SCALE	DIMENSION UNIT
A1 : 6000	METRES

**KEY PLAN**

<b>PROJECT NO.</b> 60240249	<b>CONTRACT NO.</b> HY/2012/07
<b>SHEET TITLE</b> SOUTHERN CONNECTION GENERAL LAYOUT PLAN	
<b>SHEET NUMBER</b> 60240249/C1/2000A	

This drawing has been prepared for the use of AECOM's client. It may not be used, modified, reproduced or relied upon by third parties, except as approved by AECOM. AECOM accepts no responsibility, and disclaims any liability, for any loss or damage, howsoever caused, arising from the use of this drawing. All measurements must be obtained from the latest drawings.

DO NOT SCALE DRAWING. CHECK ALL DIMENSIONS ON SITE.

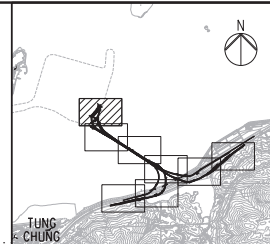

**KEY PLAN**

**NOTES**  
 1. THIS DRAWING SHALL BE READ IN CONJUNCTION WITH DRAWING NO. J3518/P/OAP/04/1000 AND OTHER RELEVANT DRAWINGS.

- LEGEND**
- SITE BOUNDARY
  - GF1 FAULT
  - EXISTING G.I.-STATIONS :
    - ⊕ BOREHOLE BY GIU DATA EXCLUDING VC
    - ⊕ BOREHOLE BY GCL CONTRACT HY/2012/04
    - ⊕ BOREHOLE BY GCL CONTRACT NL8/97
    - ⊕ BOREHOLE BY GCL CONTRACT HY/2009/23
    - ⊕ TRIAL PIT BY GCL CONTRACT HY/2012/04
  - SLOPE STRIPPING BY GCL CONTRACT HY/2012/04
  - PROPOSED G.I.-STATIONS :
    - ⊕ PBH01 PROPOSED BOREHOLE
    - ⊕ TP01 PROPOSED TRIAL PIT
    - ⊕ CH01 PROPOSED COREHOLE
    - SS01 SS02 PROPOSED SLOPE STRIPPING

MATCH LINE  
 FOR CONTINUATION  
 SEE DRG. J3518/P/OAP/04/01101

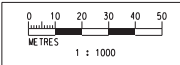

Printed by : 12/09/2013  
 File name : E:\3518\99\REC\DRG\_20130927\Ground Investigation Plan\CAD\231498\_P\_OAP\_04\_01000.dwg

Rev	Description	By	Date	Rev	Description	By	Date
A	SUBMISSION	RC	07/13				
B	SUBMISSION	RC	07/13				
C	SUBMISSION	RC	09/13				

Drawn	Date	Client
RL	07/13	HONG KONG GOVERNMENT <b>HIGHWAYS DEPARTMENT</b> 香港政府 路政處 Hong Kong - Zhuhai - Macao Bridge Hong Kong Project Management Office
Checked	Approved	Supervising Officer
DS	DOP	Contractor
Scale	1:1000 @ A1 / 1:2000 @ A3	

Project Title  
**Contract No. HY/2012/07**  
**Tuen Mun - Chek Lap Kok Link**  
**Southern Connection Viaduct Section**

Drawing title  
**Figure 1.2b**

Drawing no. **J3518/P/OAP/04/01100** Rev. **C**

**AECOM** **Gammon** **ARUP**



DO NOT SCALE DRAWING. CHECK ALL DIMENSIONS ON SITE.

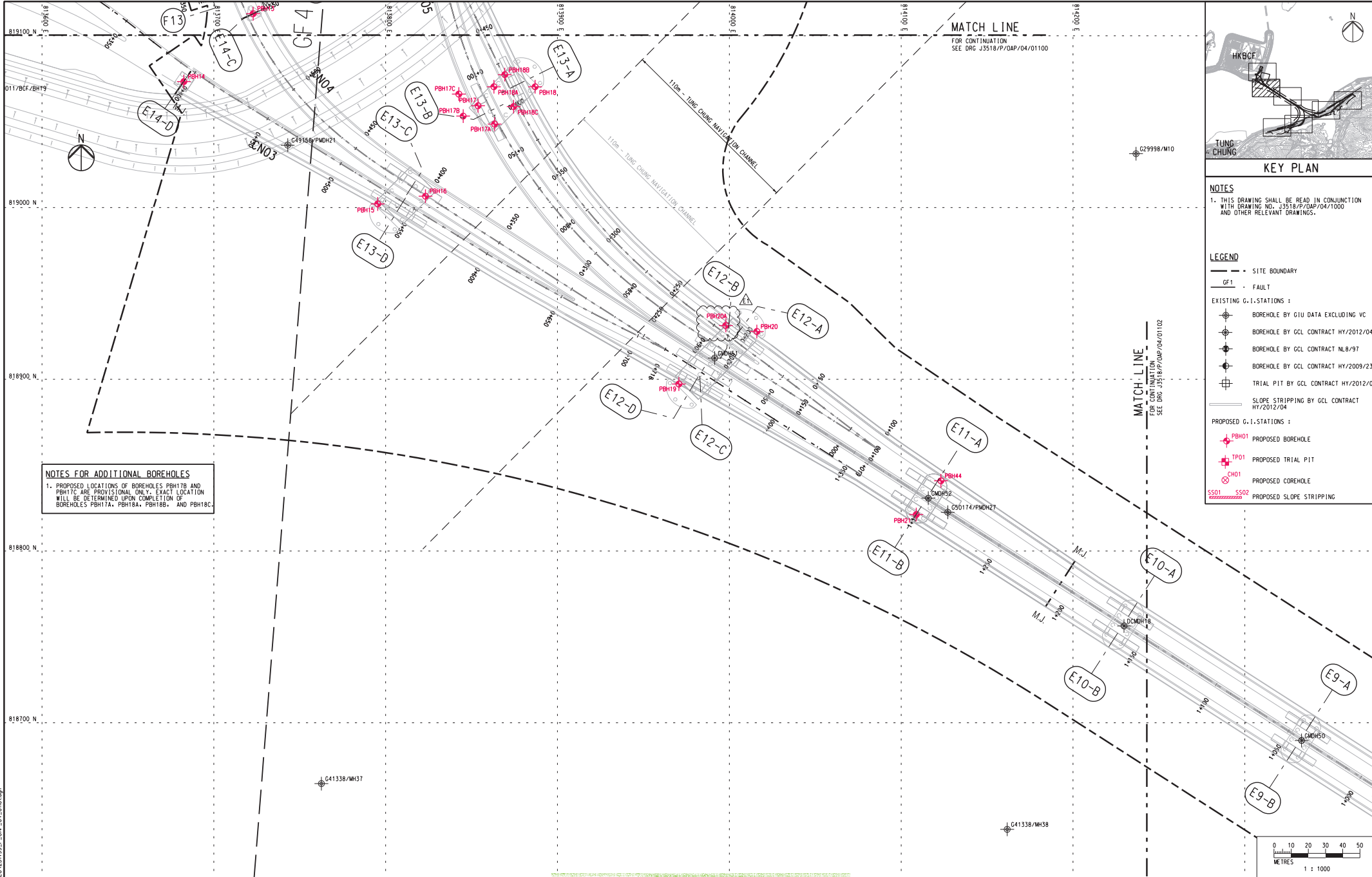

MATCH LINE  
FOR CONTINUATION  
SEE DRG J3518/P/OAP/04/01100

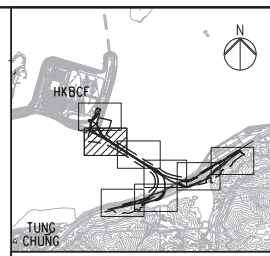

KEY PLAN

NOTES  
1. THIS DRAWING SHALL BE READ IN CONJUNCTION WITH DRAWING NO. J3518/P/OAP/04/1000 AND OTHER RELEVANT DRAWINGS.

- LEGEND
- SITE BOUNDARY
  - GF1 FAULT
  - EXISTING G.I. STATIONS:
    - ⊙ BOREHOLE BY GIU DATA EXCLUDING VC
    - ⊙ BOREHOLE BY GCL CONTRACT HY/2012/04
    - ⊙ BOREHOLE BY GCL CONTRACT NL8/97
    - ⊙ BOREHOLE BY GCL CONTRACT HY/2009/23
    - ⊙ TRIAL PIT BY GCL CONTRACT HY/2012/04
    - SLOPE STRIPPING BY GCL CONTRACT HY/2012/04
  - PROPOSED G.I. STATIONS:
    - ⊙ PBH01 PROPOSED BOREHOLE
    - ⊙ TP01 PROPOSED TRIAL PIT
    - ⊙ CH01 PROPOSED COREHOLE
    - SS01 SS02 PROPOSED SLOPE STRIPPING

NOTES FOR ADDITIONAL BOREHOLES  
1. PROPOSED LOCATIONS OF BOREHOLES PBH17B AND PBH17C ARE PROVISIONAL ONLY. EXACT LOCATION WILL BE DETERMINED UPON COMPLETION OF BOREHOLES PBH17A, PBH18A, PBH18B, AND PBH18C.

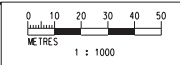

Printed by : 05.11.13  
Filename : E:\23499\WIP\GEO\23499\_P\_OAP\_04\_01100.dgn

Rev	Description	By	Date	Rev	Description	By	Date
A	SUBMISSION	RC	07/13				
B	SUBMISSION	RC	07/13				
C	SUBMISSION	RC	09/13				
D	SUBMISSION	RC	10/13				
E1	FOR INTERNAL REVIEW	RC	11/13				

Drawn	RL	Date	07/13
Checked	DS	Approved	DOP
Scale	1:1000 @ A1; 1:2000 @ A3		

  

Client	路政署 HIGHWAYS DEPARTMENT 香港渠務及港務工程處 Hong Kong - Zhuhai - Macao Bridge Hong Kong Project Management Office
Supervising Officer	AECOM
Contractor	Gammon
Originator	ARUP

Project Title	Contract No. HY/2012/07 Tuen Mun - Chek Lap Kok Link Southern Connection Viaduct Section
Drawing title	<b>Figure 1.2c</b>
Drawing no.	J3518/P/OAP/04/01101
Rev.	E1

DO NOT SCALE DRAWING. CHECK ALL DIMENSIONS ON SITE.

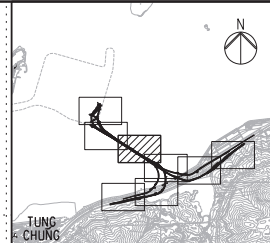
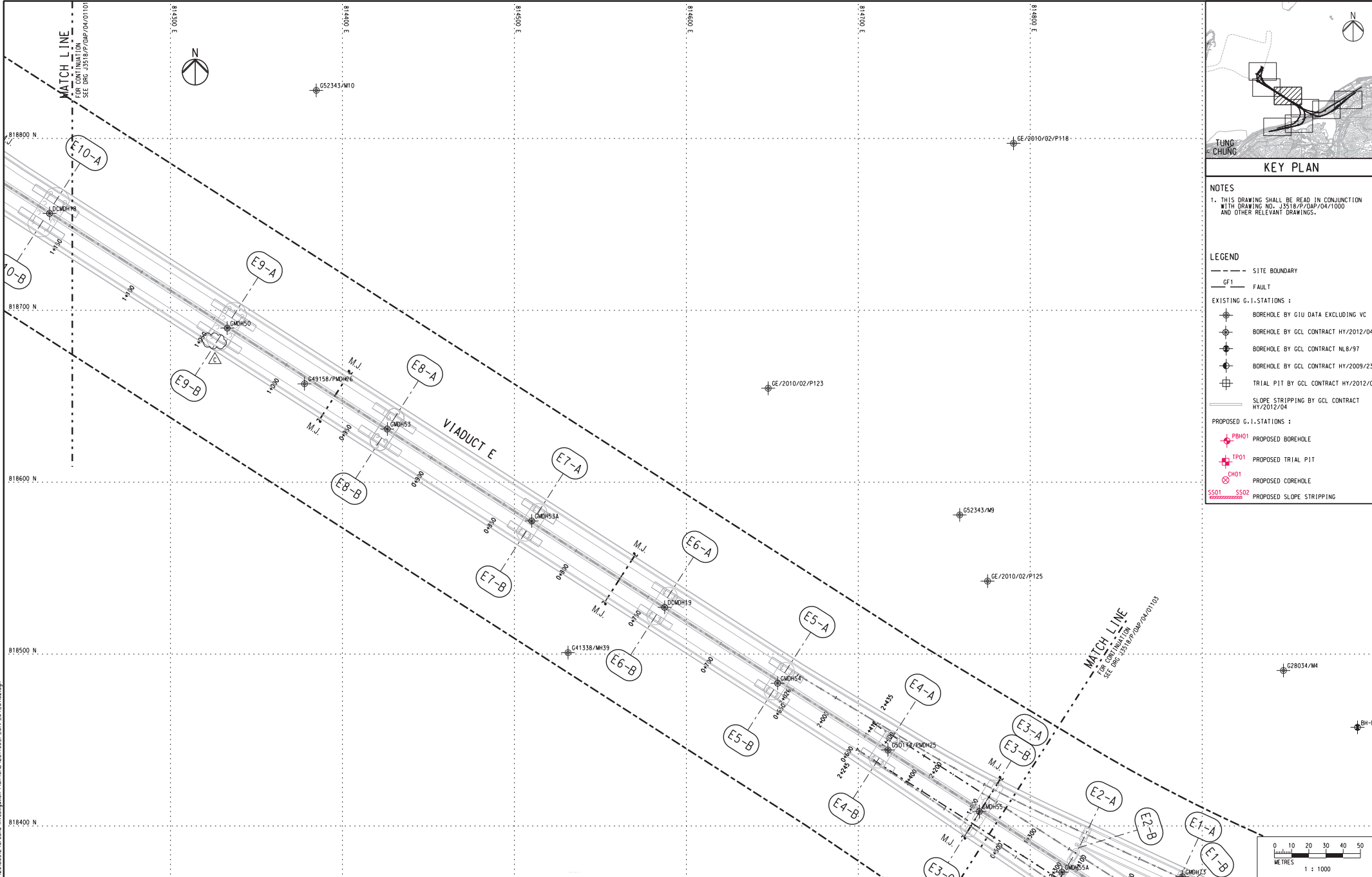

**KEY PLAN**

**NOTES**  
 1. THIS DRAWING SHALL BE READ IN CONJUNCTION WITH DRAWING NO. J3518/P/OAP/04/1000 AND OTHER RELEVANT DRAWINGS.

- LEGEND**
- SITE BOUNDARY
  - GF1- FAULT

EXISTING G.I.-STATIONS :

    - ⊕ BOREHOLE BY GIU DATA EXCLUDING VC
    - ⊕ BOREHOLE BY GCL CONTRACT HY/2012/04
    - ⊕ BOREHOLE BY GCL CONTRACT NL8/97
    - ⊕ BOREHOLE BY GCL CONTRACT HY/2009/23
    - ⊕ TRIAL PIT BY GCL CONTRACT HY/2012/04
    - SLOPE STRIPPING BY GCL CONTRACT HY/2012/04

PROPOSED G.I.-STATIONS :

    - ⊕ PBH01 PROPOSED BOREHOLE
    - ⊕ TP01 PROPOSED TRIAL PIT
    - ⊕ CH01 PROPOSED COREHOLE
    - SS01 SS02 PROPOSED SLOPE STRIPPING

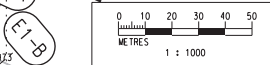

Printed by : 12/09/2013  
 File name : J:\3518\99\REC\000\20130912\Ground Investigation Plan\CAD\23498\_P\_OAP\_04\_01102.dgn

Rev	Description	By	Date	Rev	Description	By	Date
A	SUBMISSION	RC	07/13				
B	SUBMISSION	RC	07/13				
C	SUBMISSION	RC	09/13				

Drawn	Date	Checked	Approved
RL	07/13		
DS		DOP	

Scale
1:1000 @ A1 / 1:2000 @ A3

Client

Supervising Officer

Contract No. HY/2012/07  
 Tuen Mun - Chek Lap Kok Link  
 Southern Connection Viaduct Section

Contractor

Originator

Drawing title

# Figure 1.2d

Drawing no. J3518/P/OAP/04/01102 Rev. C





DO NOT SCALE DRAWING. CHECK ALL DIMENSIONS ON SITE.

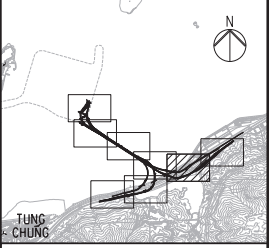
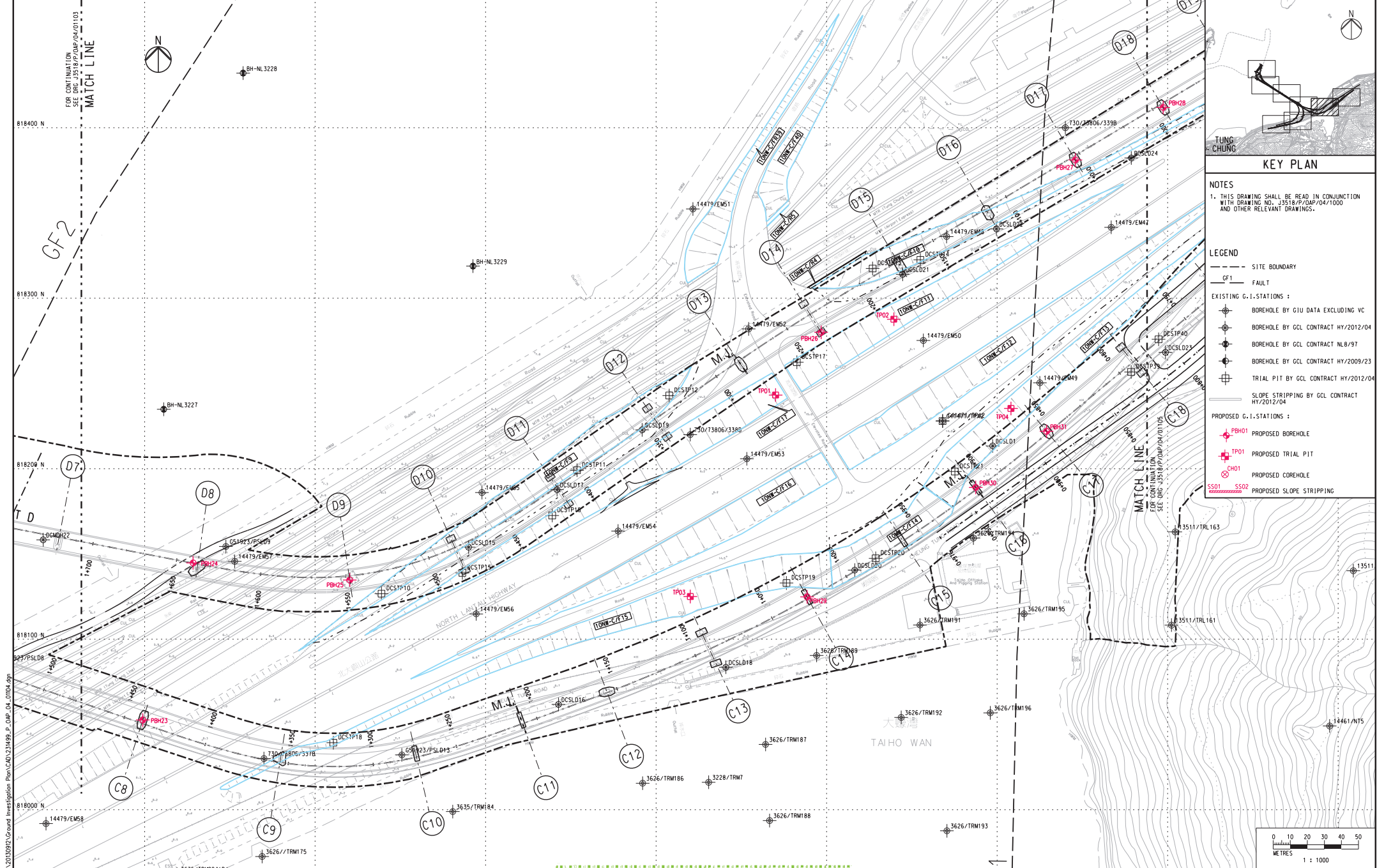

**KEY PLAN**

**NOTES**  
 1. THIS DRAWING SHALL BE READ IN CONJUNCTION WITH DRAWING NO. J3518/P/OAP/04/1000 AND OTHER RELEVANT DRAWINGS.

- LEGEND**
- - - SITE BOUNDARY
  - - - FAULT
  - - - GF1
  - EXISTING G.I. STATIONS :
    - ⊕ BOREHOLE BY GIU DATA EXCLUDING VC
    - ⊕ BOREHOLE BY GCL CONTRACT HY/2012/04
    - ⊕ BOREHOLE BY GCL CONTRACT NL6/97
    - ⊕ BOREHOLE BY GCL CONTRACT HY/2009/23
    - ⊕ TRIAL PIT BY GCL CONTRACT HY/2012/04
  - PROPOSED G.I. STATIONS :
    - ⊕ PBH01 PROPOSED BOREHOLE
    - ⊕ TP01 PROPOSED TRIAL PIT
    - ⊕ CH01 PROPOSED COREHOLE
    - SS01 SS02 PROPOSED SLOPE STRIPPING

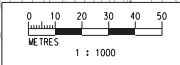

Rev	Description	By	Date	Rev	Description	By	Date
A	SUBMISSION	RC	07/13				
B	SUBMISSION	RC	07/13				
C	SUBMISSION	RC	09/13				

Checked	Approved
DS	DOP

Scale
1:1000 @ A1 / 1:2000 @ A3

Client  
 路政署  
**HIGHWAYS DEPARTMENT**  
 港珠澳大橋香港工程總處  
 Hong Kong - Zhuhai - Macao Bridge  
 Hong Kong Project Management Office

Supervising Officer  
**AECOM**

Project Title  
 Contract No. HY/2012/07  
**Tuen Mun - Chek Lap Kok Link**  
 Southern Connection Viaduct Section

Contractor  
**Gammon**

Originator  
**ARUP**

Drawing title  
**Figure 1.2f**

Drawing no. **J3518/P/OAP/04/01104** Rev. **C**

Printed by : 12/09/2013  
 File name : J:\3518\99\REC\000\20120927\Ground Investigation Plan\CAD\231498\_P\_OAP\_04\_01104.dwg





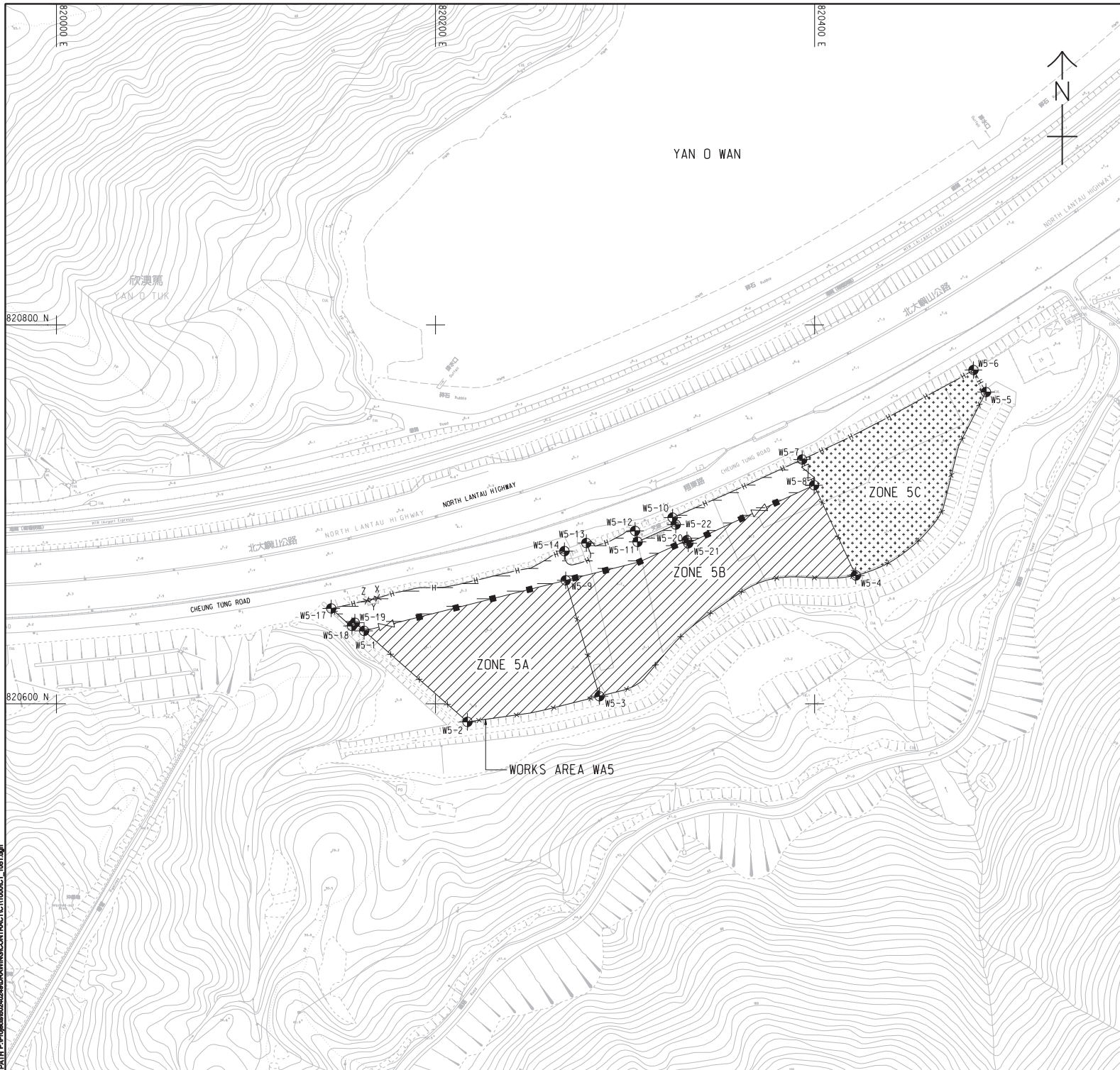

**NOTES:**

- THIS DRAWING SHALL BE READ IN CONJUNCTION WITH THE WORKS AREA KEY PLAN IN SHEET NO. 60240249/C1/1000.
- THE SETTING OUT INFORMATION AND WORKS AREA CONDITIONS SHOWN IN THIS DRAWING ARE FOR REFERENCE ONLY. THE WORKS AREA BOUNDARY SHALL BE IN ACCORDANCE WITH THE ENGINEERING CONDITIONS FOR TEMPORARY GOVERNMENT LAND ALLOCATION NO. T15 619. IN CASE OF DISCREPANCY BETWEEN THE BOUNDARY SHOWN ON THIS DRAWING AND THE BOUNDARY INDICATED ON THE ENGINEERING CONDITIONS, THE LATTER SHALL PREVAIL.
- DEMARCATION OF THE WORKS AREA SHALL BE DETERMINED ON SITE.
- REFER TO HIGHWAYS DEPARTMENT STANDARD DRAWING NOS. H6110 AND H6111 FOR DETAILS OF HOARDING.
- REFER TO HIGHWAYS DEPARTMENT STANDARD DRAWING NOS. H6121 AND H6122 FOR DETAILS OF CHAIN LINK FENCE.
- REFER TO HIGHWAYS DEPARTMENT STANDARD DRAWING NO. H6121 FOR DETAILS OF GATE.
- CHAIN LINK FENCE SHALL BE ERRECTED ALONG THE WORKS AREA BOUNDARY. THE ALIGNMENT AND EXTENT OF CHAIN LINK FENCE SHOWN ARE INDICATIVE ONLY AND SHALL BE CONFIRMED BY THE SUPERVISING OFFICER.
- THE LOCATION AND WIDTH OF GATE SHOWN ARE INDICATIVE ONLY AND SHALL BE CONFIRMED BY THE SUPERVISING OFFICER.
- NO STRUCTURES SHALL BE ERRECTED OTHER THAN SUCH STRUCTURES NOT EXCEEDING TWO STOREYS IN HEIGHT, WHICH ARE APPROVED BY THE DISTRICT LANDS OFFICER AS BEING APPROPRIATE FOR THE USE OF THE SITE AS A WORKS AREA.
- THE TENTATIVE OCCUPATION PERIOD SHALL BE REFERRED TO EMPLOYER'S REQUIREMENTS PART 2 AND PART 14 SECTION 1 CLAUSE 1.45A.
- THE WORKS AREAS SHOWN ON THIS DRAWING ARE TO BE SHARE-USED AMONG THE CONTRACTS OF TM-CLK RELATED CONTRACTS. THE AREAS HATCHED WITH ARE TENTATIVELY ALLOCATED FOR THE USE OF THIS CONTRACT.
- THE COMMON AREA SHALL BE CONCRETE PAVED BY THE CONTRACTOR.

**LEGEND:**

- WORKS AREA UNDER THIS CONTRACT
- COMMON AREA (MAINTAINED UNDER THIS CONTRACT) TO BE SHARE-USED WITH OTHER CONTRACTS
- WORKS AREA FOR THIS CONTRACT TO BE EARLY HANDED OVER BY THE CONTRACTOR.
- HOARDING AND GATE (TO BE ERRECTED AND MAINTAINED UNDER THIS CONTRACT)
- CHAIN LINK FENCE AND GATE (TO BE ERRECTED AND MAINTAINED BY OTHERS)
- CHAIN LINK FENCE AND GATE (TO BE ERRECTED AND MAINTAINED UNDER THIS CONTRACT)

**SETTING OUT COORDINATES OF WORKS AREA W5**

POINT	COORDINATES	
	EASTING	NORTHING
W5-1	820162.308	820638.492
W5-2	820216.839	820590.455
W5-3	820286.496	820603.985
W5-4	820421.757	820667.742
W5-5	820490.425	820764.554
W5-6	820483.839	820776.180
W5-7	820393.451	820728.958
W5-8	820399.746	820715.343
W5-9	820268.674	820665.173
W5-10	820325.075	820698.276
W5-11	820306.587	820685.458
W5-12	820305.269	820691.287
W5-13	820279.580	820684.863
W5-14	820268.027	820680.572
X	820169.407	820655.859
Y	820166.601	820655.172
Z	820163.794	820654.484
W5-17	820144.957	820650.334
W5-18	820155.899	820641.093
W5-19	820157.432	820642.788
W5-20	820332.642	820686.314
W5-21	820333.350	820684.738
W5-22	820326.723	820694.608

**ISSUE/REVISION**

NO.	DATE	DESCRIPTION	CHK.

**STATUS**

--	--	--	--

<b>SCALE</b> A1:1000	<b>DIMENSION UNIT</b> METRES
-------------------------	---------------------------------

**KEY PLAN**

**Figure 1.2h**

<b>PROJECT NO.</b> 60240249	<b>CONTRACT NO.</b> HY/2012/07
--------------------------------	-----------------------------------

<b>SHEET TITLE</b> WORKS AREA AND HOARDING PLAN
--

<b>SHEET NUMBER</b> 60240249/C1/1051
---

This drawing has been prepared for the use of the contractor. It may not be used, modified, reproduced or reissued without the written approval of AECOM. AECOM shall not be responsible for any errors or omissions in this drawing. AECOM shall not be responsible for any errors or omissions in this drawing. AECOM shall not be responsible for any errors or omissions in this drawing.







SETTING OUT COORDINATES OF WORKS AREA WA4

POINT	COORDINATES	
	EASTING	NORTHING
W4-1,U	815717.822	818074.398
V	815718.373	818071.803
W4-2,W	815718.923	818069.208
W4-3	815868.411	818103.687
X	815865.759	818117.028
Y	815866.539	818113.104
Z	815867.319	818109.181
W4-4	815860.972	818141.118

- NOTES:**
- THIS DRAWING SHALL BE READ IN CONJUNCTION WITH THE WORKS AREA KEY PLAN IN SHEET NO. 60240249/C1/100.
  - THE SETTING OUT INFORMATION AND WORKS AREA CONDITIONS SHOWN IN THIS DRAWING ARE FOR REFERENCE ONLY. THE WORKS AREA BOUNDARY SHALL BE IN ACCORDANCE WITH THE ENGINEERING CONDITIONS FOR TEMPORARY GOVERNMENT LAND ALLOCATION NO. T15 631.
  - THE CONTRACTOR SHALL NOTE THAT WORKS AREA WA4 IS THE AREA FOR STORAGE OF CORE BOXES FOR OTHER CONTRACTORS OF THE EMPLOYER.
  - THE CONTRACTOR SHALL TAKE UP AND MAINTAIN THE EXISTING CHAIN LINK FENCE AND GATE. PROVIDE THE SECURITY, SITE CLEANLINESS AND TIDINESS FOR THE WORKS AREA.
  - THE CONTRACTOR SHALL NOTE THAT THE SETTING OUT COORDINATES OF WORKS AREA WA4 ARE TENTATIVE ONLY AND THE CONTRACTOR SHALL VERIFY THE SETTING OUT COORDINATES ON SITE.

**LEGEND:**

WORKS AREA WA4

EXISTING CHAIN LINK FENCE AND GATE

**AECOM**

**PROJECT**  
 TUEN MUN - CHEK LAP KOK LINK

**CONTRACT TITLE**  
 TUEN MUN - CHEK LAP KOK LINK - SOUTHERN CONNECTION VIADUCT SECTION

**CLIENT**  
 路政署 DEPARTMENT OF HIGHWAYS  
 港務局 港務工程管理局  
 Hong Kong + Zhuhai + Hainan Bridge  
 Hong Kong Project Management Office

**CONSULTANT**  
 AECOM Asia Company Ltd.  
 www.aecom.com

**SUB-CONSULTANTS**  
 2/11/2012/16

**Figure 1.2j**

**ISSUE/REVISION**

NO.	DATE	DESCRIPTION	CHK.
1	NOV. 12	TENDER ADDENDUM NO. 1	C/W

**SCALE**  
 A1 : 1:1000

**DIMENSION UNIT**  
 METRES

**KEY PLAN**

**PROJECT NO.**  
 60240249

**CONTRACT NO.**  
 HY/2012/07

**SHEET TITLE**  
 WORKS AREA WA4

**SHEET NUMBER**  
 60240249/C1/1053

This drawing has been prepared for the use of AECOM, except as may be otherwise approved by AECOM, and shall not be used for any other purpose without the written consent of AECOM. Do not scale this drawing. All measurements must be taken from the actual dimensions.



DO NOT SCALE DRAWING. CHECK ALL DIMENSIONS ON SITE.

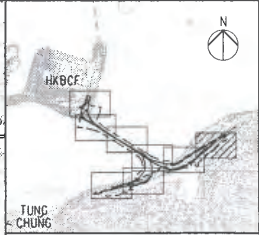
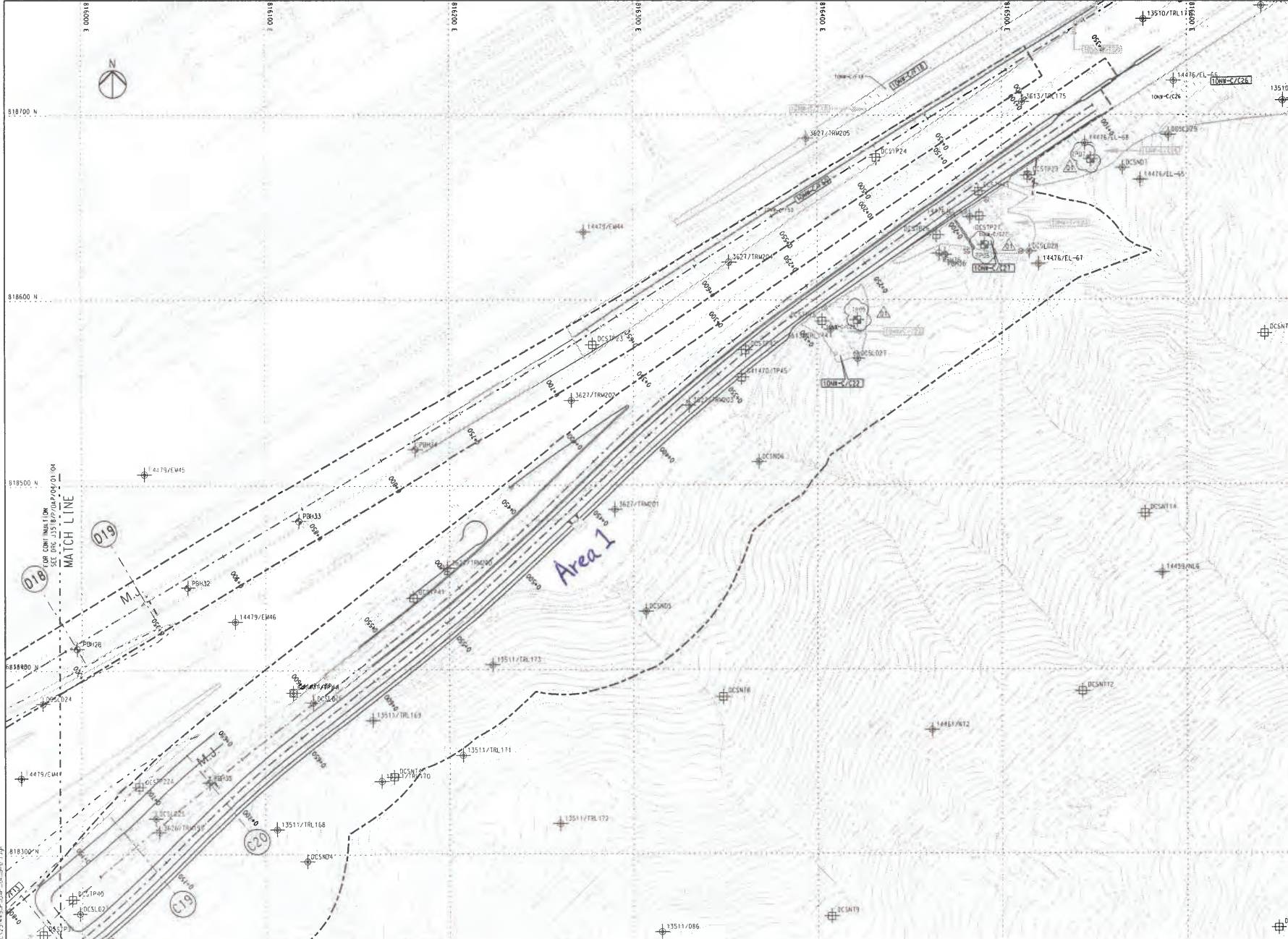

**NOTES**  
 THIS DRAWING SHALL BE READ IN CONJUNCTION WITH DRAWING NO. J3518/P/OAP/04/1000 AND OTHER RELEVANT DRAWINGS.

- LEGEND**
- SITE BOUNDARY
  - GF1 FAULT
- EXISTING G.I. STATIONS :
- ⊕ BOREHOLE BY GIU DATA EXCLUDING VC
  - ⊕ BOREHOLE BY GCL CONTRACT HY/2012/04
  - ⊕ BOREHOLE BY GCL CONTRACT N6.8/97
  - ⊕ BOREHOLE BY GCL CONTRACT HY/2009/23
  - ⊕ TRIAL PIT BY GCL CONTRACT HY/2012/04
  - ⊕ SLOPE STRIPPING BY GCL CONTRACT HY/2012/04
- PROPOSED G.I. STATIONS :
- ⊕ BOREHOLE
  - ⊕ TRIAL PIT
  - ⊕ COREHOLE
  - ⊕ SLOPE STRIPPING

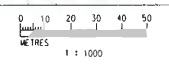

Rev	Description	By	Date	Rev	Description	By	Date
01	ISSUED FOR CONSTRUCTION	RL	31/7/13				
02	ISSUED FOR CONSTRUCTION	RL	27/7/13				
03	ISSUED FOR CONSTRUCTION	RL	29/7/13				
04	ISSUED FOR CONSTRUCTION	RL	19/7/12				

Drawn	Date	Client
RL	07/13	路政署 HIGHWAYS DEPARTMENT
Checked <td>Approved</td> <td>港珠澳大桥香港工程指挥部 Hong Kong - Zhuhai - Macao Bridge Hong Kong Project Management Office</td>	Approved	港珠澳大桥香港工程指挥部 Hong Kong - Zhuhai - Macao Bridge Hong Kong Project Management Office
DS	DOP	Supervising Officer

Client: 路政署 HIGHWAYS DEPARTMENT  
 港珠澳大桥香港工程指挥部  
 Hong Kong - Zhuhai - Macao Bridge  
 Hong Kong Project Management Office

Project Title: Tuen Mun - Chek Lap Kok Link Southern Connection Viaduct Section

Contract No. HY/2012/07

Scale: 1:1000 @ A1 / 1:2000 @ A3

Supervising Officer: **AZCOM**

Contractor: **Gammon**

Originator: **ARUP**

Drawing title: **Figure 1.2k**

Drawing no. J3518/P/OAP/04/01105 Rev. D1



